

F.A.I. RTE.	SECTION	COUNTY	TOTAL SHEETS	SHEET NO.
94/90		COOK	556	56
STA.	TO STA.			
FED. ROAD DIST. NO.	ILLINOIS	FED. AID PROJECT		
62300		(1818, ETC. 2324.6-1P/R-8		

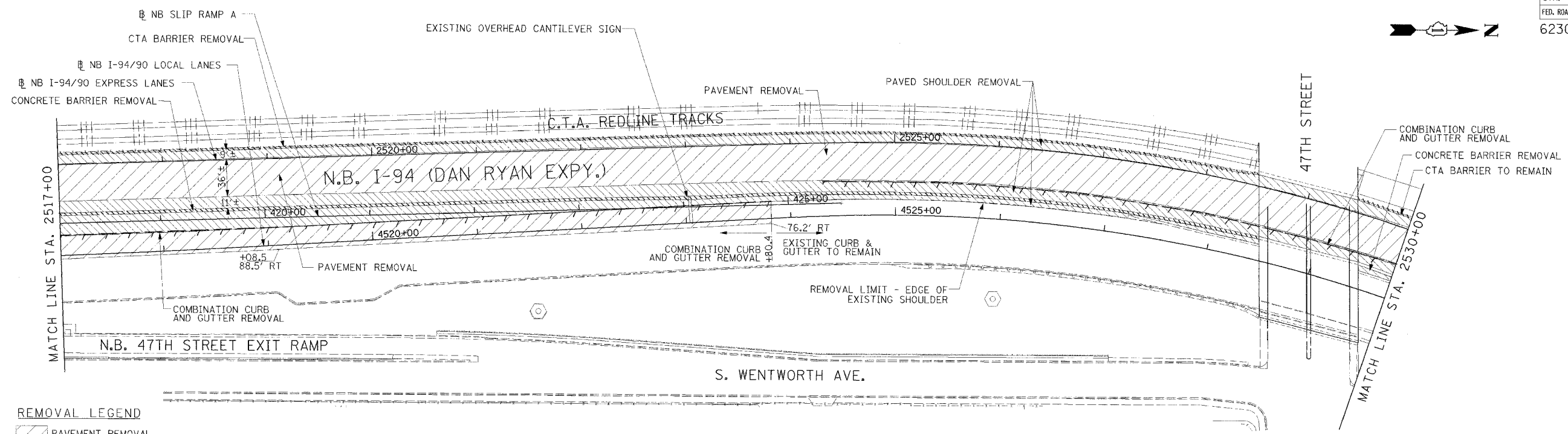

REMOVAL LEGEND

	PAVEMENT REMOVAL
	PAVED SHOULDER REMOVAL
	COMBINATION CURB AND GUTTER REMOVAL
	CONCRETE BARRIER OR GUARD RAIL REMOVAL

NOTE:
1. THE LOCATION OF PAVEMENT CONSTRUCTED IN PREVIOUS CONTRACTS IS BASED OFF OF CONTRACT PLAN DRAWINGS. THE CONTRACTOR MUST VERIFY LIMITS OF PREVIOUS CONSTRUCTION IN THE FIELD.

EXISTING CONDITIONS & REMOVALS

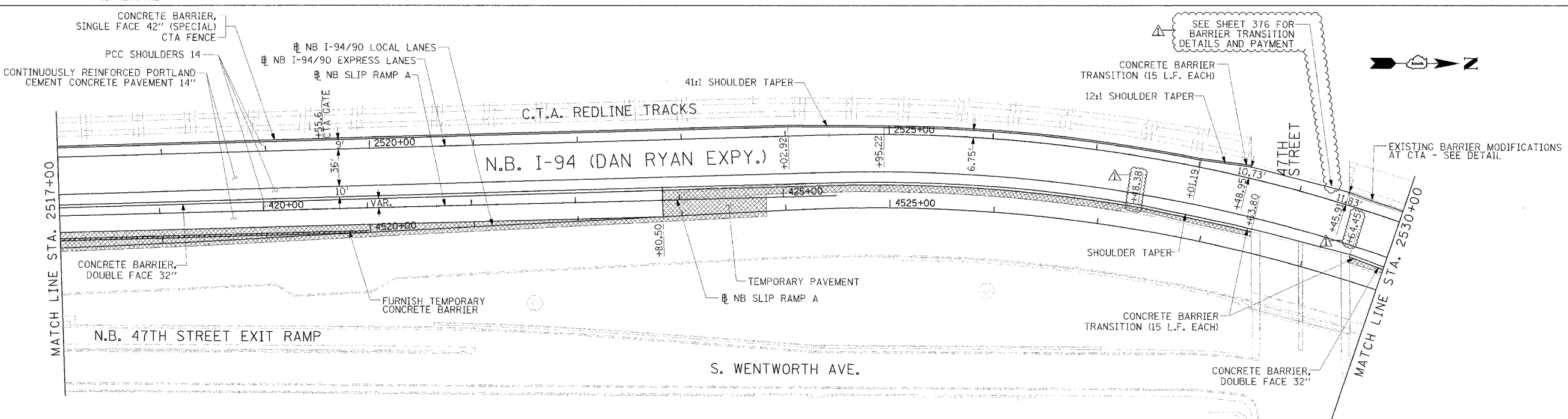

LEGEND

	TEMPORARY PAVEMENT (INTERSTATE)/TEMPORARY SHOULDER
	TEMPORARY CONCRETE BARRIER

STATIONING
 +**.** STATION PROVIDED FROM THE I-90/94 EXPRESS LANES
 (+**.***) STATION PROVIDED FROM THE I-90/94 LOCAL LANES
 [+**.**] STATION PROVIDED FROM THE SLIP RAMP

PROPOSED CONDITIONS

NOTE:
1. BRIDGE OVER EXPRESS LANES OMITTED FOR CLARITY.

Edwards AND Kelcey
 ONE NORTH FRANKLIN
 CHICAGO, IL 60606
 PHONE: (312) 251-3000
 FAX: (312) 251-3015
 WEB: WWW.EKCORP.COM

REVISIONS

NAME	DATE
ADDENDUM 1	8/12/05

ILLINOIS DEPARTMENT OF TRANSPORTATION
 F.A.I. 94/90 (DAN RYAN EXPRESSWAY)
 31ST STREET TO 71ST STREET
 NB EXPRESS LANE RECONSTRUCTION
 EXISTING AND PROPOSED PLAN
 NORTHBOUND STA. 2517+00 TO STA. 2530+00
 SCALE: 1"=50'
 DATE: 7/7/05
 DRAWN BY: TAI
 CHECKED BY: PJM

RDY-11

08/09/2005 04:44:57 PM