

F.A.I.	SECTION	COUNTY	TOTAL SHEETS	SHEET NO.
94/90		COOK	556	96
STA. 2578+00		TO STA. 2602+00		
FED. ROAD DIST. NO.		ILLINOIS FED. AID PROJECT		
62300		•(1818, ETC. 2324.6-1PJR-8		

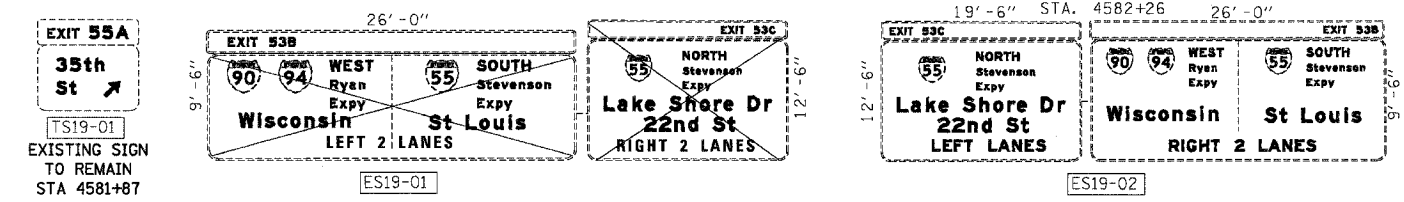

EXISTING SIGN TO REMAIN UNDER THIS CONTRACT.
 CONTRACT 62300 NEEDS TO COORDINATE WITH
 CONTRACT 62580 MAINTENANCE OF TRAFFIC

- LEGEND**
- WORK ZONE
 - TEMPORARY PAVEMENT
 - 1LL TRAFFIC LANE & DIRECTION OF TRAFFIC
 - DRUM OR BARRICADE TYPE II WITH STEADY BURN LIGHT
 - IMPACT ATTENUATORS, TEMPORARY (NON-REDIRECTIVE), TEST LEVEL 3
 - BARRICADE TYPE III
 - TEMPORARY CONCRETE BARRIER
 - ① LINE 4" (YELLOW EDGE LINE)
 - ② LINE 4" (WHITE EDGE LINE)
 - ③ LINE 4" (SKIP DASH, 6' SKIP - 2' DASH, WHITE)
 - ④ LINE 5" (SKIP DASH, 30' SKIP - 10' DASH, WHITE)
 - ⑤ LINE 8" (WHITE GORE LINE)
 - ⑥ LINE 8" (SKIP DASH, 12' SKIP - 3' DASH, WHITE)
 - ⑦ LINE 12" (DIAGONAL, 30' C-C)
 - ⑧ LINE 12" (DIAGONAL, 500' C-C)
 - ⑨ LETTERS AND SYMBOLS
 - ESx-xx EXISTING SIGNS
 - TSx-xx TEMPORARY SIGNS

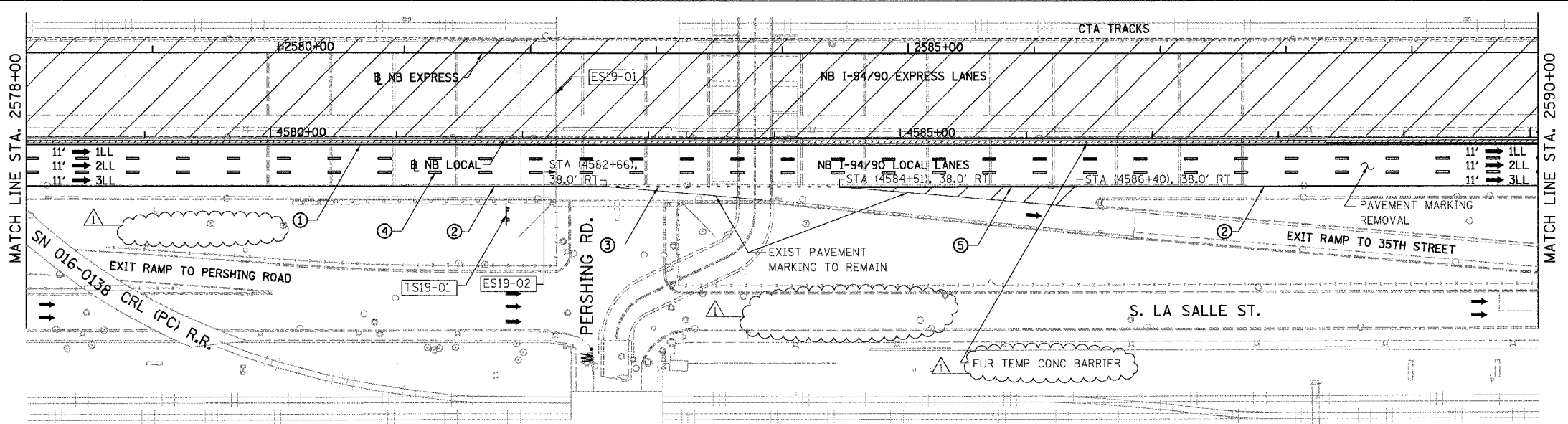
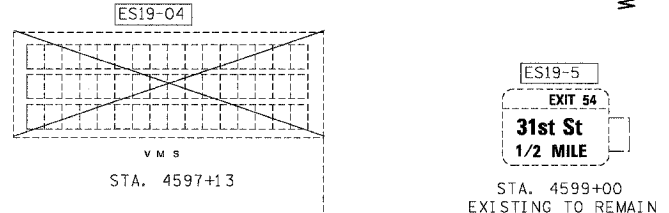
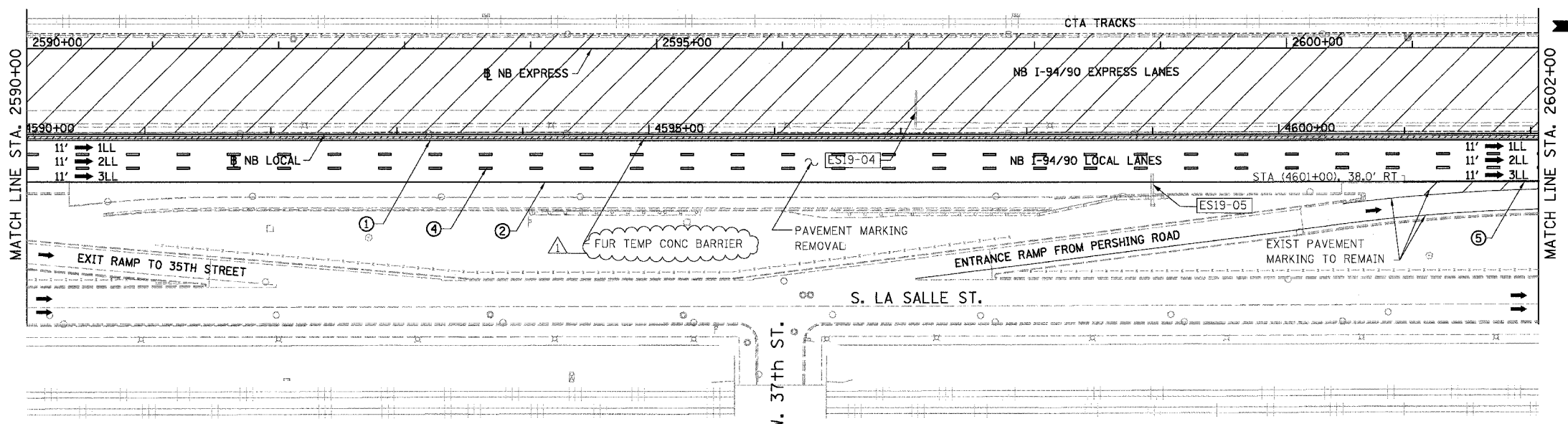

NOTE:
 ALL PAVEMENT MARKINGS ON THIS SHEET WILL BE PAVEMENT MARKING TAPE, TYPE III, UNLESS OTHERWISE NOTED.

MOT-16

BOWMAN, BARRETT & ASSOCIATES INC.
 CONSULTING ENGINEERS
 Chicago, Illinois
 312.228.0100
 www.bbainc.com

STATIONING
 +##.## STATION PROVIDED FROM THE NB I-90/94 EXPRESS LANES
 (+##.##) STATION PROVIDED FROM THE NB I-90/94 LOCAL LANES
 [+##.##] STATION PROVIDED FROM THE SLIP RAMP

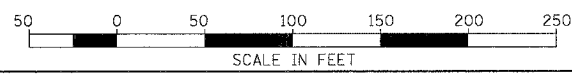

REVISIONS	
NAME	DATE
ADDENDUM 1	8/12/05

ILLINOIS DEPARTMENT OF TRANSPORTATION
 F.A.I. 94/90 (DAN RYAN EXPRESSWAY)
 31ST STREET TO 71ST STREET
 NB EXPRESS LANE RECONSTRUCTION
 MAINTENANCE OF TRAFFIC PLAN STAGE 1
 NORTHBOUND STA. 2578+00 TO STA. 2602+00
 SCALE: 1"=50'
 DATE: 07/07/05
 DRAWN BY: RA
 CHECKED BY: RS

8/10/2005 3:29:30 PM
 P:\660\road\94\90\AS\94\90\9607.dwg