

F.A.I. RTE.	SECTION	COUNTY	TOTAL SHEETS	SHEET NO.
94/90		COOK	556	245
STA.	TO STA.			
FED. ROAD DIST. NO.	ILLINOIS	FED. AID PROJECT		
62300		1818, ETC, 2324.6-IPR-8		

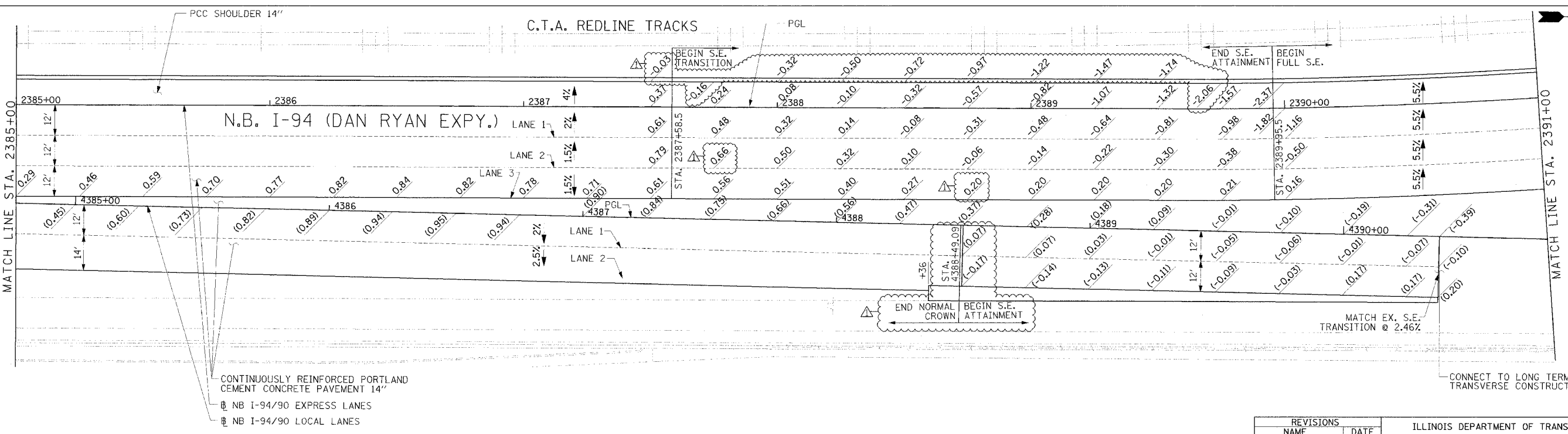

CONTINUOUSLY REINFORCED PORTLAND CEMENT CONCRETE PAVEMENT 14"
 NB I-94/90 EXPRESS LANES
 NB I-94/90 LOCAL LANES

CONNECT TO LONG TERM TRANSVERSE CONSTRUCTION JOINT

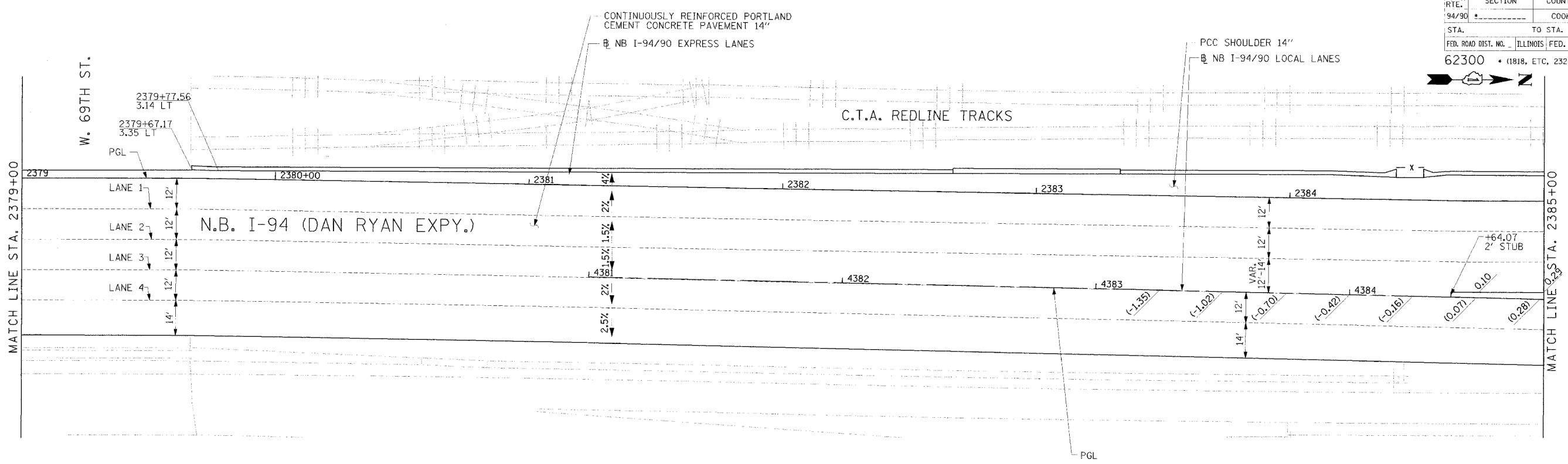

LEGEND
 [***] ELEVATION STATIONED OFF OF SB I-94/90 EXPRESS LANES
 [***] ELEVATION STATIONED OFF OF SB I-94/90 LOCAL LANES
 [***] ELEVATION STATIONED OFF OF SLIP RAMP ALIGNMENT

NOTE:
 1. PAVEMENT ELEVATIONS ALONG RAMPS, GORES AND IN AREAS OF SUPERELEVATION TRANSITION ARE PROVIDED AT 25' INTERVALS. FOR ALL OTHER ELEVATIONS, REFER TO PROFILE AND TYPICAL SECTIONS.

REVISIONS	
NAME	DATE
APPENDUM 1	8/12/05

ILLINOIS DEPARTMENT OF TRANSPORTATION
 F.A.I. 94/90 (DAN RYAN EXPRESSWAY)
 31ST STREET TO 71ST STREET
 NB EXPRESS LANE RECONSTRUCTION
 PAVEMENT JOINTING AND ELEVATION PLAN
 NORTHBOUND STA. 2379+00 TO STA. 2391+00
 SCALE: 0' 10' 20' 30' 40'
 DATE: 7/7/05
 DRAWN BY: TAI
 CHECKED BY: PJM

JT-2
 08/09/2005 04:59:11 PM