

F.A.I. RTE.	SECTION	COUNTY	TOTAL SHEET
94/90		COOK	556
STA.	TO STA.		
FED. ROAD DIST. NO.		ILLINOIS FED. AID PROJECT	
62300		1818, ETC. 2324.6-IPR-8	

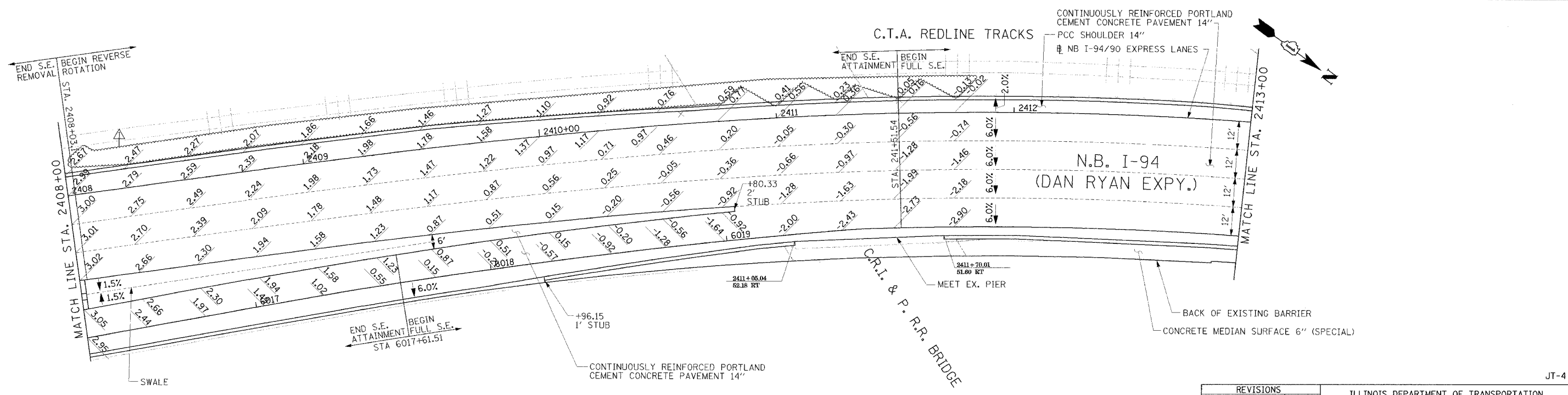
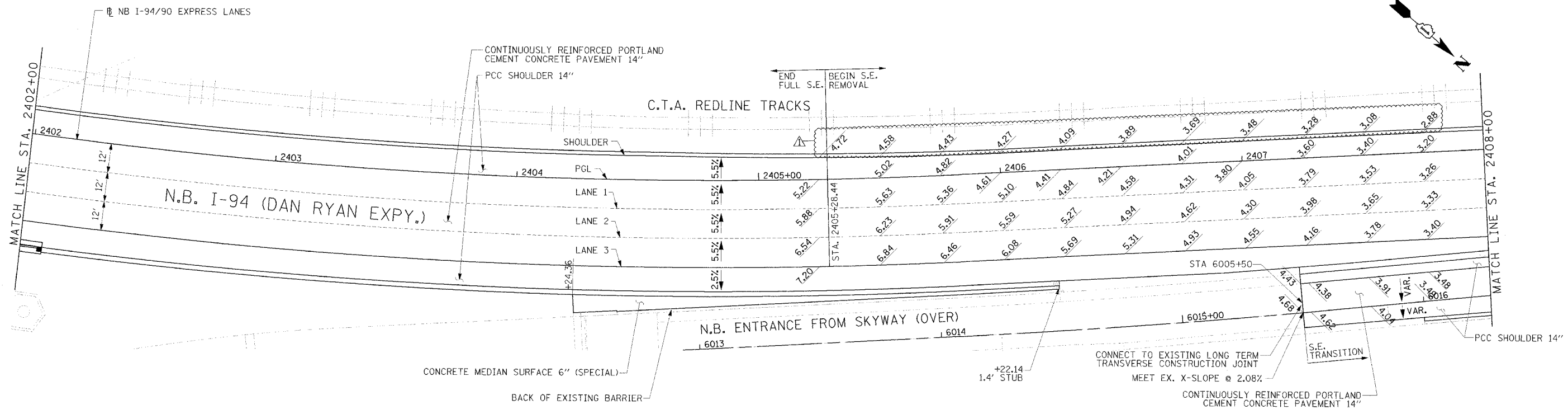

**Edwards  
AND  
Kelcey**  
ONE NORTH FRANKLIN  
CHICAGO, IL 60606  
PHONE: (312) 251-3000  
FAX: (312) 251-3015  
WEB: WWW.EDKORP.COM

**LEGEND**  
 \*\* ELEVATION STATIONED OFF OF NB I-94/90 EXPRESS LANES  
 (\*\*\*) ELEVATION STATIONED OFF OF SB I-94/90 LOCAL LANES  
 [\*\*] ELEVATION STATIONED OFF OF SLIP RAMP ALIGNMENT

**NOTE:**  
 1. PAVEMENT ELEVATIONS ALONG RAMPS, GORES AND IN AREAS OF SUPERELEVATION TRANSITION ARE PROVIDED AT 25' INTERVALS. FOR ALL OTHER ELEVATIONS, REFER TO PROFILE AND TYPICAL SECTIONS.

REVISIONS	
NAME	DATE
ADDENDUM I	8/12/05

ILLINOIS DEPARTMENT OF TRANSPORTATION  
 F.A.I. 94/90 (DAN RYAN EXPRESSWAY)  
 31ST STREET TO 71ST STREET  
 NB EXPRESS LANE RECONSTRUCTION  
 PAVEMENT JOINTING AND ELEVATION PLAN  
 NORTHBOUND STA. 2402+00 TO STA. 2413+00  
 SCALE: 0' 10' 20' 30' 40'  
 DATE: 7/7/05  
 DRAWN BY: TAI  
 CHECKED BY: PJM

JT-4  
 08/11/2005 02:30:12 PM