

STATE OF ILLINOIS
DEPARTMENT OF TRANSPORTATION

F.A.I. RTE.	SECTION	COUNTY	TOTAL SHEETS	SHEET NO.
90/94	*	COOK	556	378
STA.	TO STA.			
FED. ROAD DIST. NO. 1	ILLINOIS	FED. AID PROJECT		
* (1B1B, ETC, 2324.6-1PIR-8			62300	

**BILL OF MATERIAL
FOR ONE TRANSITION**

Bar	No.	Size	Length	Shape
d3(E)	15	#4	5'-2"	—
d5(E)	25	#4	4'-8"	—
h3(E)	48	#4	1'-8"	⌋
h4(E)	6	#4	27'-2"	—
h5(E)	6	#4	14'-8"	—
h6(E)	27	#4	1'-2"	⌋
Item	Unit	Quantity		
Reinforcement Bars, Epoxy Coated	Pound	372		
Concrete Superstructure	Cu. Yd.	4.7		
Protective Coat	Sq. Yd.	25		
Concrete Removal	Cu. Yd.	0.9		

NOTES:

- Drilling and grouting of #4 h3(E) and h6(E) bars shall be in accordance with Section 584 of the Standard Specifications.
- The cost of drilling holes, furnishing and placing Epoxy Grout and setting #4 h3(E) and h6(E) bars shall be included in the cost per cubic yard for Concrete Superstructure.
- Exposed existing reinforcement bars shall remain in place and be blast cleaned to gray metal. Reinforcement bars that have been cut or have lost 25% or more of their original cross sectional area shall be supplemented by new epoxy coated reinforcement bars.
- The cost of supplementing and cleaning existing reinforcement bars shall be included in the cost per cubic yard for Concrete Removal.
- Provide joints in facing to match those in the existing barrier. See Sheet B7 for details.
- For Soldier Pile and Lagging Retention System, see Sheets B1, B4 and B5.
- For Refaced Barrier Wall Details, see Sheets B4 and B5.
- For Sections A-A, B-B and C-C, see Sheet B11.
- For Existing Concrete Repair Details, see Sheet B3.
- For Facing Details at Existing Light Pole Foundation, see Sheet B5.
- For locations of Transition, see Roadway Plans.

Sheet B10 of 16

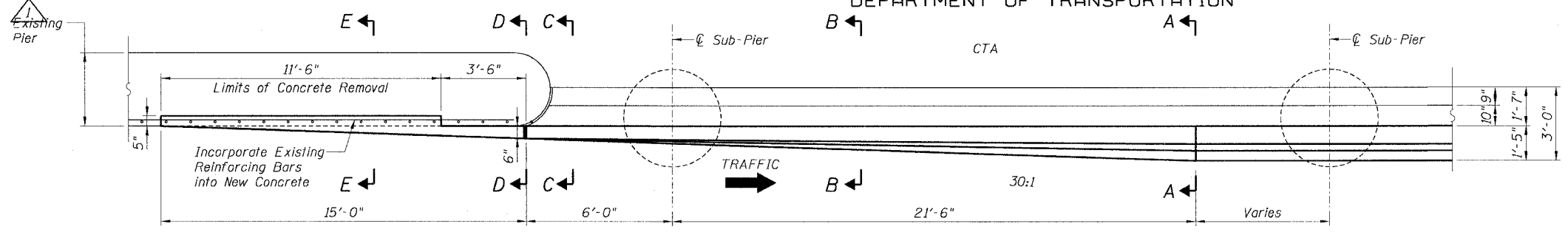

PLAN

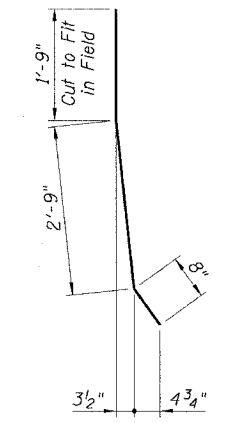

d3(E) Bar

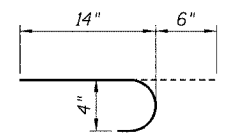

h3(E) Bar

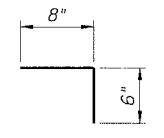

h6(E) Bar

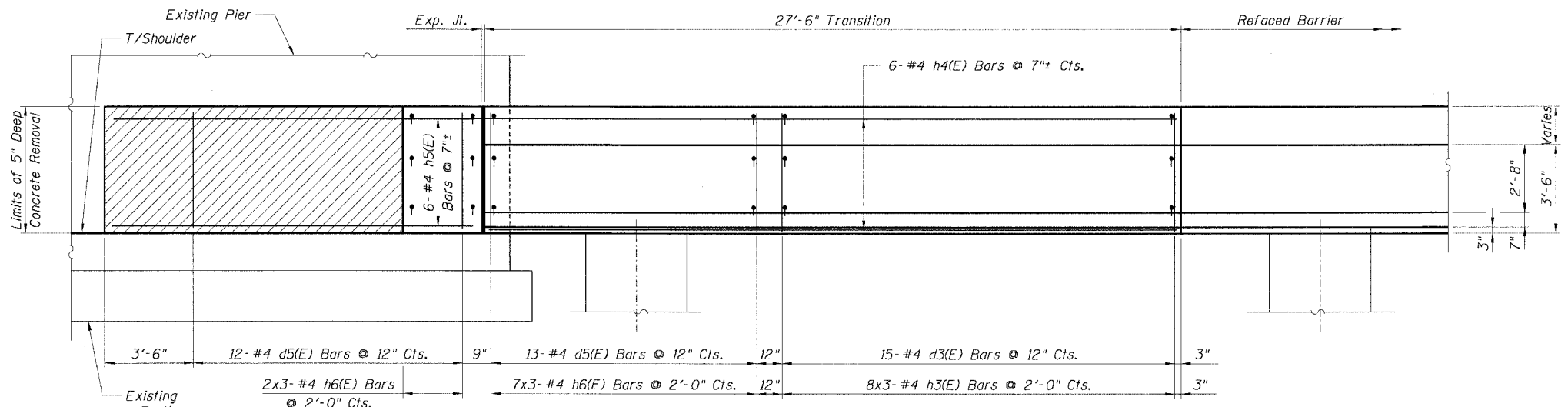

ELEVATION

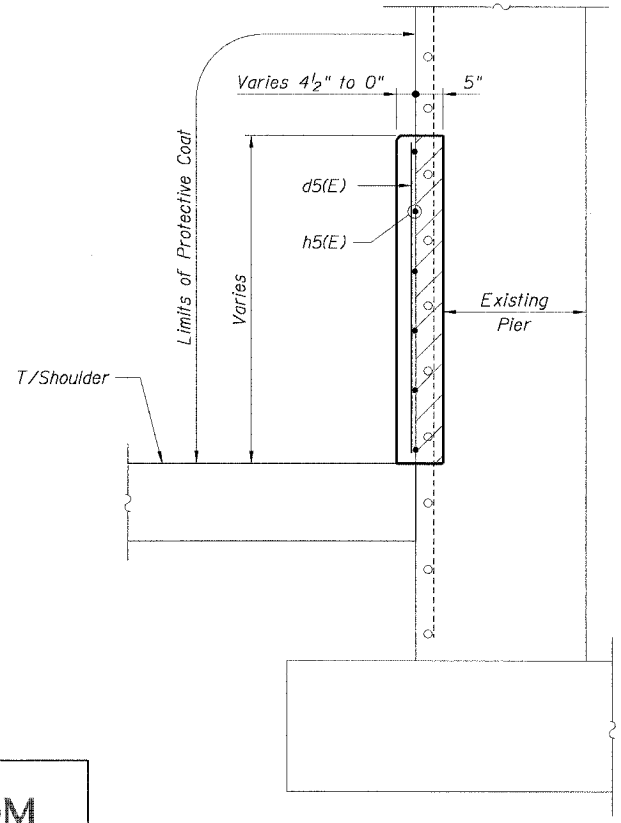

SECTION E-E

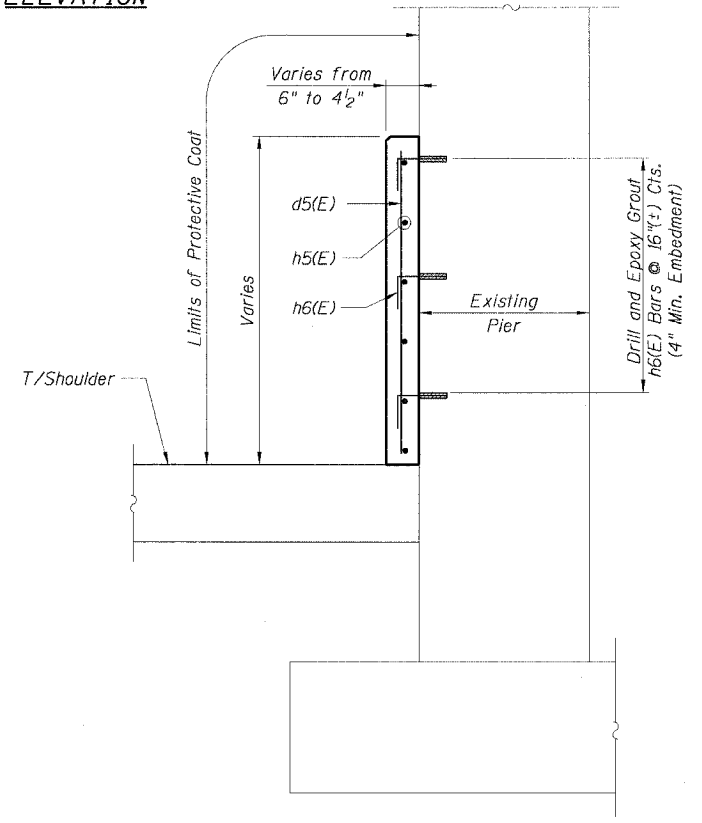

SECTION D-D

LEGEND:

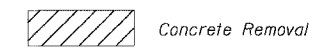

Concrete Removal

REVISIONS	
NAME	DATE
MJP	8-12-05

ILLINOIS DEPARTMENT OF TRANSPORTATION
F.A.I. 90/94 (DAN RYAN EXPRESSWAY)
71ST STREET TO 31ST STREET (NB EXPRESS LANES)
EXISTING BARRIER WALL MODIFICATIONS
AT CTA STATIONS
PROPOSED T/S SHOULDER AT OR ABOVE EXISTING
REFACED BARRIER TO PIER
TRANSITION DETAILS (TAPER)
SCALE: None DRAWN BY: CHD
DATE: July 7, 2005 CHECKED BY: MJP

CTE | AECOM