

| | | | | |
|----------------------------------|----------|------------------|--------------|-----------|
| 62300 * (1818, ETC, 2324.6-IPR-8 | | | | |
| F.A.I. R.T.E. | SECTION | COUNTY | TOTAL SHEETS | SHEET NO. |
| 94/90 * | | COOK | 556 | 538 |
| STA. 160 | TO STA. | | | |
| FED. ROAD DIST. NO. | ILLINOIS | FED. AID PROJECT | | |

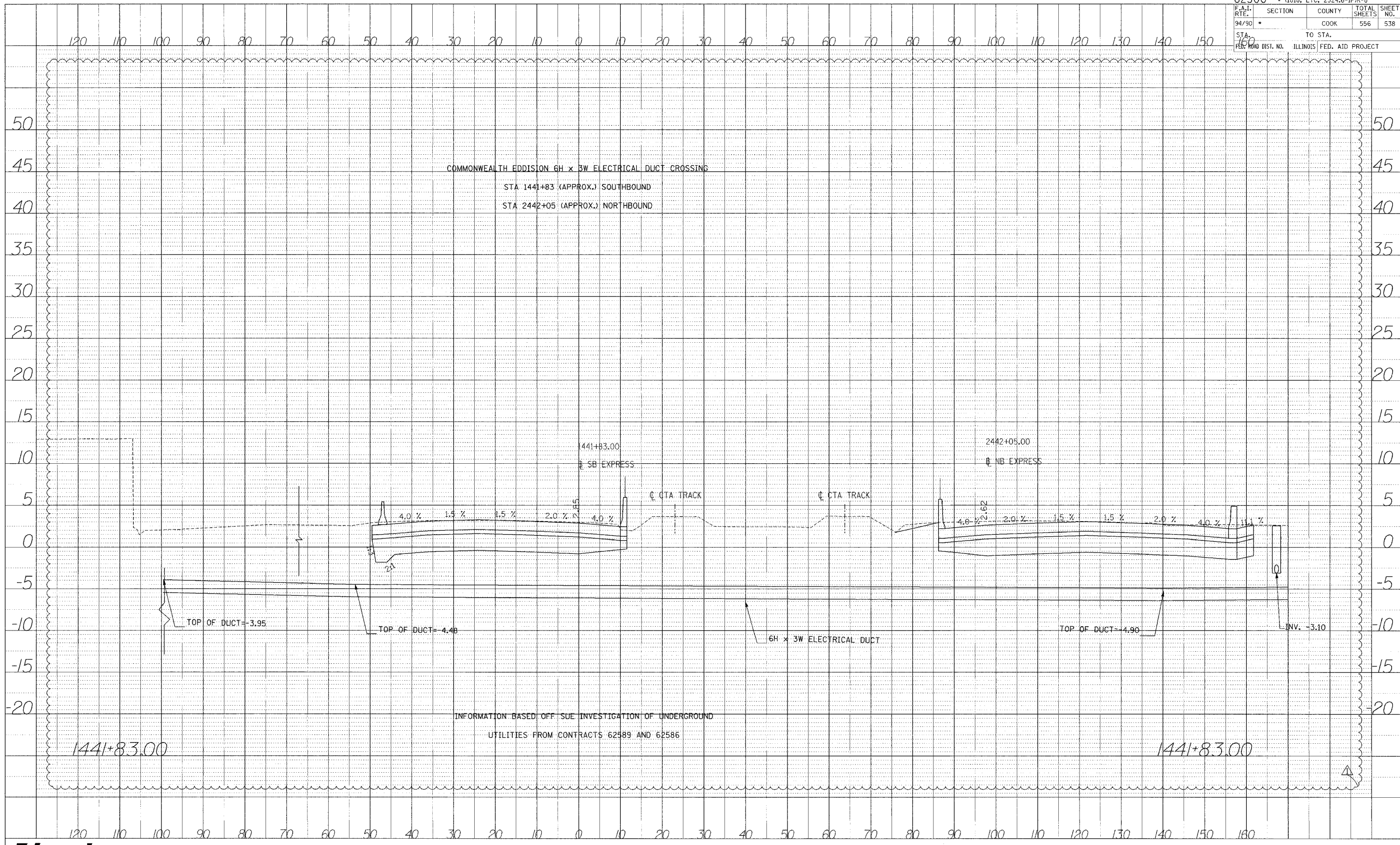

COMMONWEALTH EDDISON 6H x 3W ELECTRICAL DUCT CROSSING
 STA 1441+83 (APPROX.) SOUTHBOUND
 STA 2442+05 (APPROX.) NORTHBOUND

1441+83.00
 SB EXPRESS

2442+05.00
 NB EXPRESS

CTA TRACK

CTA TRACK

6H x 3W ELECTRICAL DUCT

TOP OF DUCT=-3.95

TOP OF DUCT=-4.48

TOP OF DUCT=-4.90

INV. -3.10

INFORMATION BASED OFF SUE INVESTIGATION OF UNDERGROUND UTILITIES FROM CONTRACTS 62589 AND 62586

1441+83.00

1441+83.00

Edwards AND Kelcey
 ONE NORTH FRANKLIN
 CHICAGO, IL 60606
 PHONE: (312) 251-3000
 FAX: (312) 251-3015
 WEB: WWW.EKCORP.COM

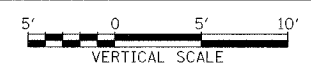
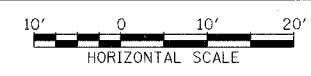

STA.

PROFILE SURVEYED BY DATE
 CHECKED BY
 NOTE BOOK NO.
 NO. OF SHEETS TOTAL
 PROJECT NO. (OPTIONAL)

P:\030009\030009.dwg 148/15 10/20/00 10:11:11 AM