

F.A.I. RTE.	SECTION	COUNTY	TOTAL SHEETS	SHEET NO.
90/94		COOK	556	384E
STA.	TO STA.			
FED. ROAD DIST. NO. 1	ILLINOIS	FED. AID PROJECT		
• (1818, ETC. 2324.6-1P/R-8			62300	

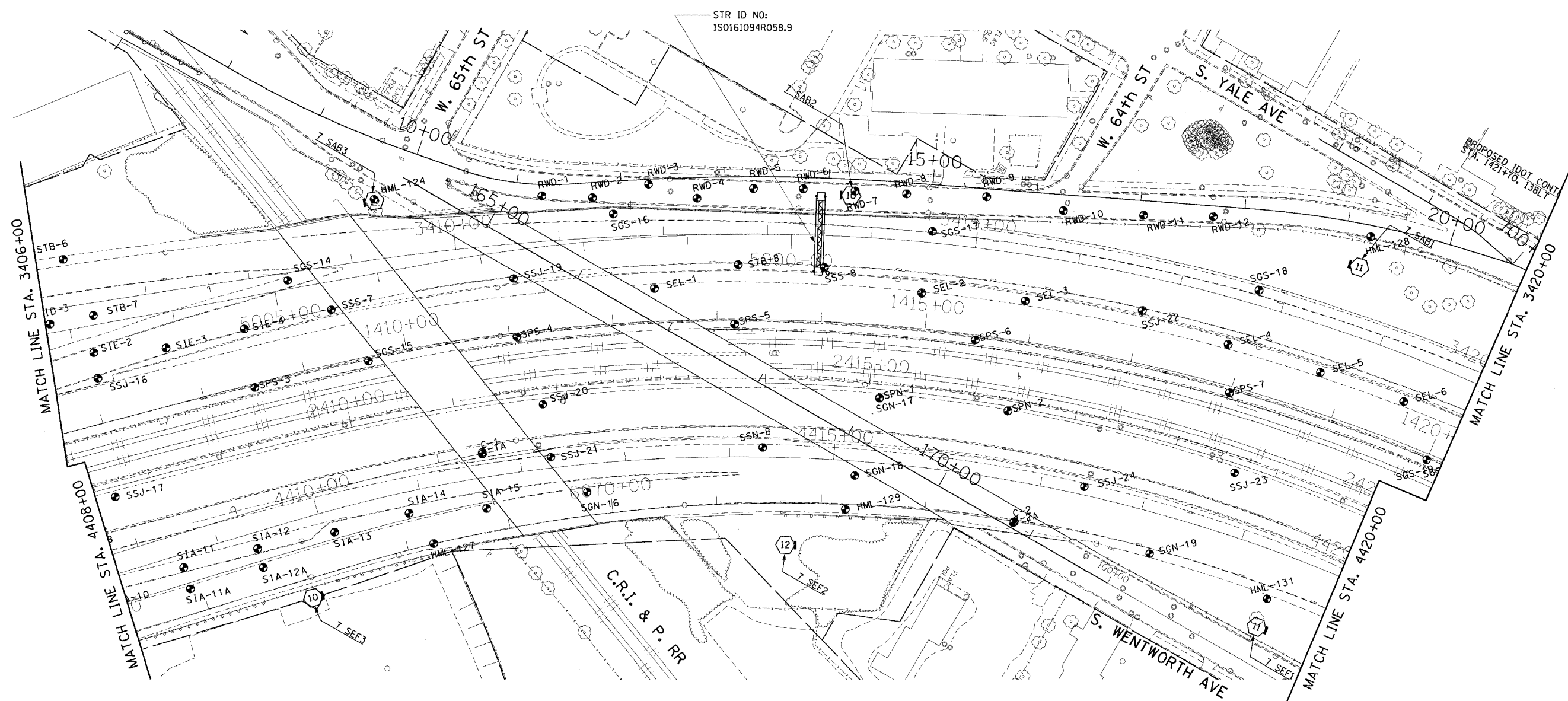
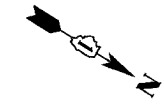

STR ID NO:
1S0161094R058.9

LEGEND FOR BORINGS

- PROPOSED SIGN STRUCTURE
- ⊠ HIGH MAST LIGHT POLE
- HML : HIGH MAST LIGHT POLE
- RED : RETAINING WALL, EAST SIDE, WALL-O
- REW : RETAINING WALL, EAST SIDE, WALL-W
- RWC : RETAINING WALL, WEST SIDE, WALL-C
- RWL : RETAINING WALL, WEST SIDE, WALL-L
- SIA : RETAINING WALL, INTERCHANGE, WALL IA
- SSN : STORM SEWER, NORTHBOUND
- SSS : STORM SEWER, SOUTHBOUND
- SSJ : STORM SEWER, JACKING
- STB : SIGN STRUCTURE
- SSB : BRIDGE
- SEW.SWW : BRIDGE
- SGN : SUBGRADE, NORTHBOUND
- SGS : SUBGRADE, SOUTHBOUND
- BRN : 47th ST. RAMP
- C : CORING

▲ ADDED SHEET



REVISIONS	
NAME	DATE
ADDENDUM #2	9-16-05

ILLINOIS DEPARTMENT OF TRANSPORTATION
F.A.I. 90/94 (DAN RYAN EXPRESSWAY)
71ST STREET TO 31ST STREET (NB EXPRESS LANES)

SOIL BORING LOCATIONS

SCALE: 1"=50'
DATE: September 16, 2005
DRAWN BY: PHP
CHECKED BY: JAL

9/18/2005 9:29:02 AM