

F.A.I. RTE.	SECTION	COUNTY	TOTAL SHEETS	SHEET NO.
94/90		COOK	556	47
STA.	TO STA.		FED. ROAD DIST. NO.	
62300	818, ETC, 2324.6-1PR-8		ILLINOIS FED. AID PROJECT	

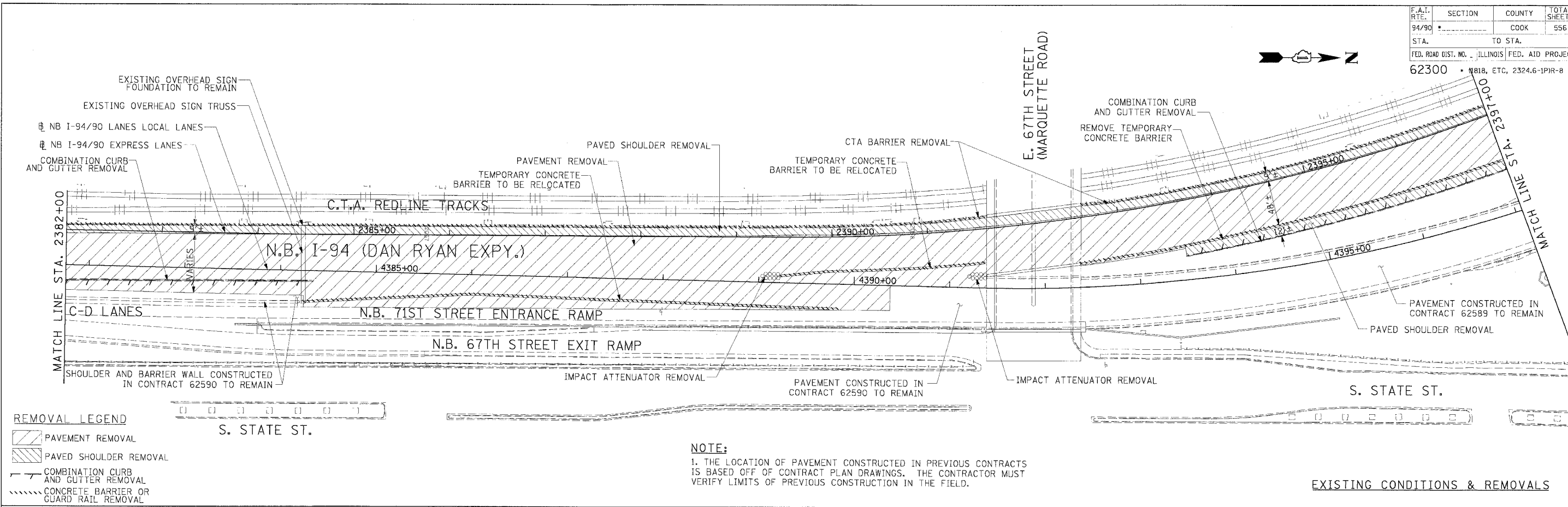

- REMOVAL LEGEND**
- PAVEMENT REMOVAL
  - PAVED SHOULDER REMOVAL
  - COMBINATION CURB AND GUTTER REMOVAL
  - CONCRETE BARRIER OR GUARD RAIL REMOVAL

**NOTE:**  
1. THE LOCATION OF PAVEMENT CONSTRUCTED IN PREVIOUS CONTRACTS IS BASED OFF OF CONTRACT PLAN DRAWINGS. THE CONTRACTOR MUST VERIFY LIMITS OF PREVIOUS CONSTRUCTION IN THE FIELD.

EXISTING CONDITIONS & REMOVALS

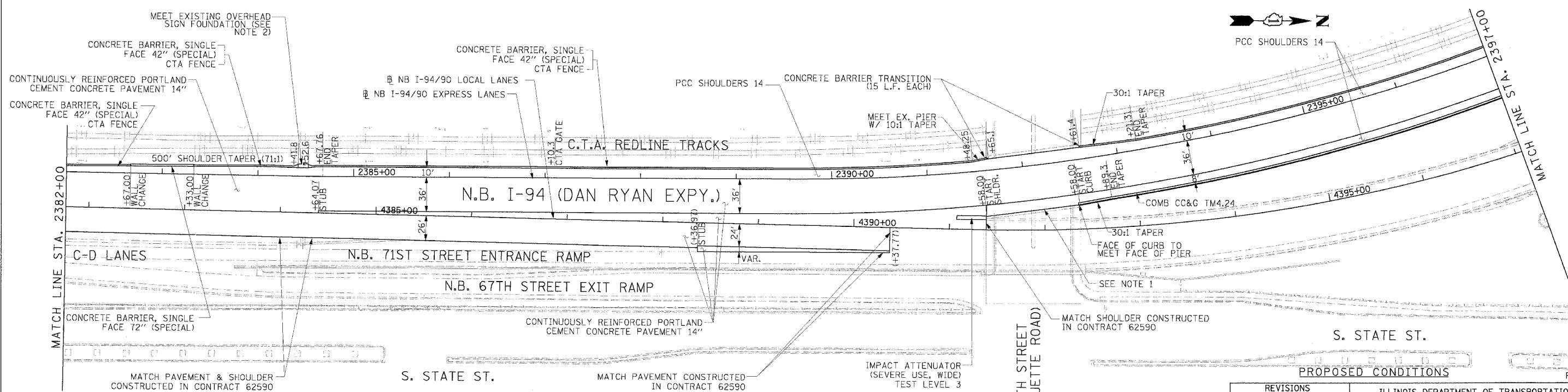

- NOTES:**
- BRIDGE OVER EXPRESS LANES OMITTED FOR CLARITY.
  - TAPER FACE OF BARRIER TOWARDS TRAFFIC AT A 30:1 RATE AND AWAY FROM TRAFFIC AT A 10:1 RATE TO MEET EXISTING FOUNDATION BARRIER FACE. ON THE CTA SIDE, TAPER BACK OF WALL AT A 3:1 RATE TO MEET BACK OF FOUNDATION. WIDENING OF WALL IS PAID FOR AS CONCRETE BARRIER TRANSITION (9 LF).

- STATIONING**
- \*\*\* STATION PROVIDED FROM THE I-90/94 EXPRESS LANES
  - (\*\*\*) STATION PROVIDED FROM THE I-90/94 LOCAL LANES
  - [\*\*]\*\* STATION PROVIDED FROM THE SLIP RAMP

- LEGEND**
- TEMPORARY PAVEMENT (INTERSTATE)/TEMPORARY SHOULDER
  - TEMPORARY CONCRETE BARRIER

**Edwards AND Kelcey**  
ONE NORTH FRANKLIN CHICAGO, IL 60606  
PHONE: (312) 251-3000  
FAX: (312) 251-3015  
WEB: WWW.EKCORP.COM

REVISIONS	
NAME	DATE

ILLINOIS DEPARTMENT OF TRANSPORTATION  
F.A.I. 94/90 (DAN RYAN EXPRESSWAY)  
31ST STREET TO 71ST STREET  
NB EXPRESS LANE RECONSTRUCTION  
EXISTING AND PROPOSED PLAN  
NORTHBOUND STA. 2382+00 TO STA. 2397+00

SCALE: 1"=50'  
0' 50' 100'

DATE: 7/7/05

DRAWN BY: TAI  
CHECKED BY: PJM

P:\030019\0305\001\F815\CAD\DWG\F815\_404022.dwg

06/24/2005 10:55:51 AM