

F.A.I. SECTION	COUNTY	TOTAL SHEETS	SHEET NO.
94/90	COOK	556	55
STA. TO STA.	TO STA.		
FED. ROAD DIST. NO.	ILLINOIS	FED. AID PROJECT	
62300	01818, ETC.	2324.6-1PR-8	

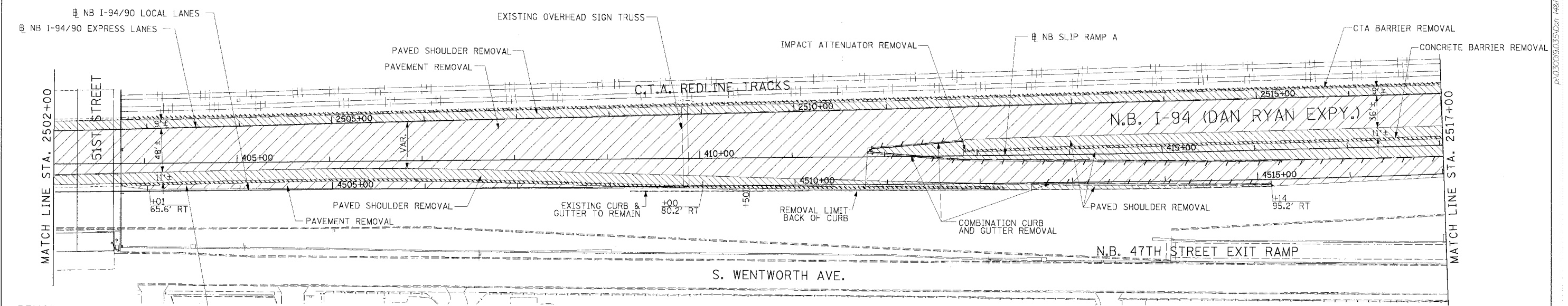
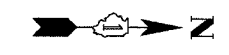

- REMOVAL LEGEND**
- PAVEMENT REMOVAL
 - PAVED SHOULDER REMOVAL
 - COMBINATION CURB AND GUTTER REMOVAL
 - CONCRETE BARRIER OR GUARD RAIL REMOVAL

NOTE:
 1. THE LOCATION OF PAVEMENT CONSTRUCTED IN PREVIOUS CONTRACTS IS BASED OFF OF CONTRACT PLAN DRAWINGS. THE CONTRACTOR MUST VERIFY LIMITS OF PREVIOUS CONSTRUCTION IN THE FIELD.

EXISTING CONDITIONS & REMOVALS

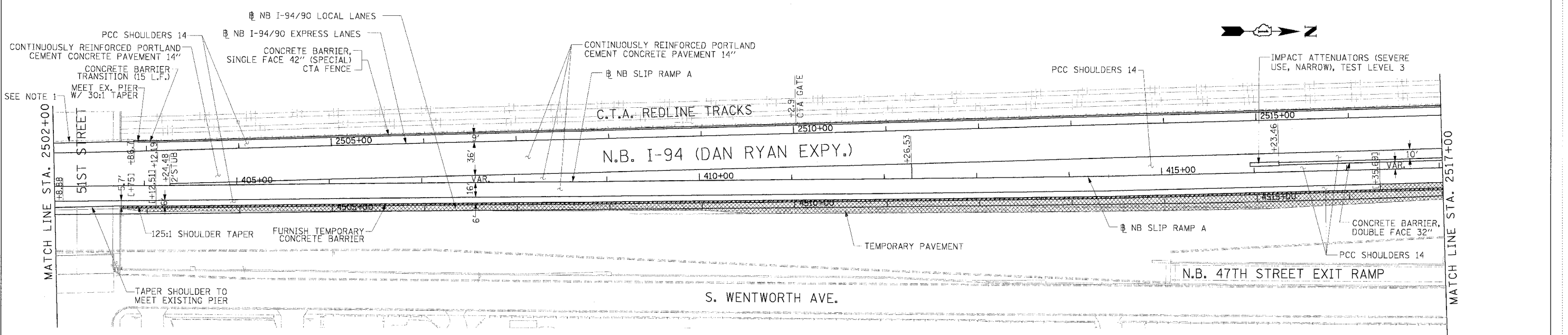

NOTE:
 1. BRIDGE OVER EXPRESS LANES OMITTED FOR CLARITY.

- LEGEND**
- TEMPORARY PAVEMENT (INTERSTATE)/TEMPORARY SHOULDER
 - TEMPORARY CONCRETE BARRIER

STATIONING
 +###.## STATION PROVIDED FROM THE NB I-90/94 EXPRESS LANES
 (+##.##) STATION PROVIDED FROM THE NB I-90/94 LOCAL LANES
 [+##.##] STATION PROVIDED FROM THE SLIP RAMP

REVISIONS	
NAME	DATE

ILLINOIS DEPARTMENT OF TRANSPORTATION
 F.A.I. 94/90 (DAN RYAN EXPRESSWAY)
 31ST STREET TO 71ST STREET
 NB EXPRESS LANE RECONSTRUCTION
 EXISTING AND PROPOSED PLAN
 NORTHBOUND STA. 2502+00 TO STA. 2517+00

SCALE: 1"=50'
 DATE: 7/7/05

DRAWN BY: TAI
 CHECKED BY: PJM

Edwards AND Kelcey
 ONE NORTH FRANKLIN
 CHICAGO, IL 60606
 PHONE: (312) 251-3000
 FAX: (312) 251-3015
 WEB: WWW.EKCORP.COM

RDY-10
 06/24/2005 11:00:45 AM