

F.A.I.	SECTION	COUNTY	TOTAL SHEETS	SHEET NO.
94/90	*	COOK	556	94
STA. 2530+00		TO STA. 2554+00		
FED. ROAD DIST. NO.		ILLINOIS FED. AID PROJECT		
62300		*(1818, ETC, 2324.6-1P)R-8		

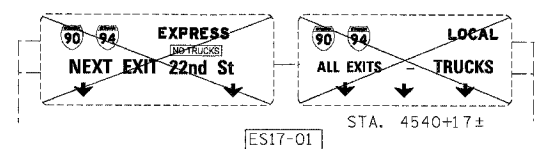

EXISTING SIGN PANEL FROM STA 4545+43 INSTALLED ON STRUCTURAL STEEL SIGN SUPPORT-BREAKAWAY (W6X15) CONCRETE FOUNDATIONS - STA. 4540+00

- LEGEND**
- WORK ZONE
  - TEMPORARY PAVEMENT
  - 1LL TRAFFIC LANE & DIRECTION OF TRAFFIC
  - DRUM OR BARRICADE TYPE II WITH STEADY BURN LIGHT
  - IMPACT ATTENUATORS, TEMPORARY (NON-REDIRECTIVE), TEST LEVEL 3
  - BARRICADE TYPE III
  - TEMPORARY CONCRETE BARRIER
  - ① LINE 4" (YELLOW EDGE LINE)
  - ② LINE 4" (WHITE EDGE LINE)
  - ③ LINE 4" (SKIP DASH, 6' SKIP - 2' DASH, WHITE)
  - ④ LINE 5" (SKIP DASH, 30' SKIP - 10' DASH, WHITE)
  - ⑤ LINE 8" (WHITE GORE LINE)
  - ⑥ LINE 8" (SKIP DASH, 12' SKIP - 3' DASH, WHITE)
  - ⑦ LINE 12" (DIAGONAL, 30' C-C)
  - ⑧ LINE 12" (DIAGONAL, 500' C-C)
  - ⑨ LETTERS AND SYMBOLS
  - EXISTING SIGNS
  - TEMPORARY SIGNS

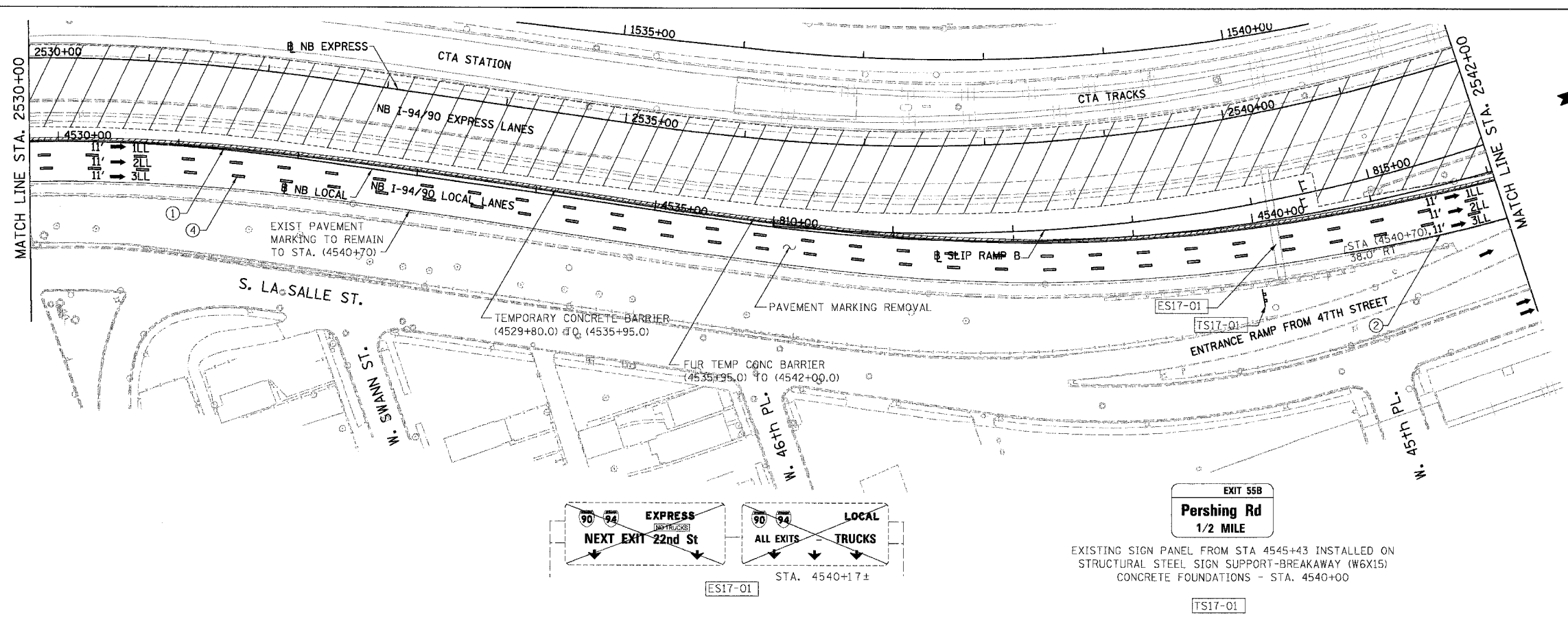
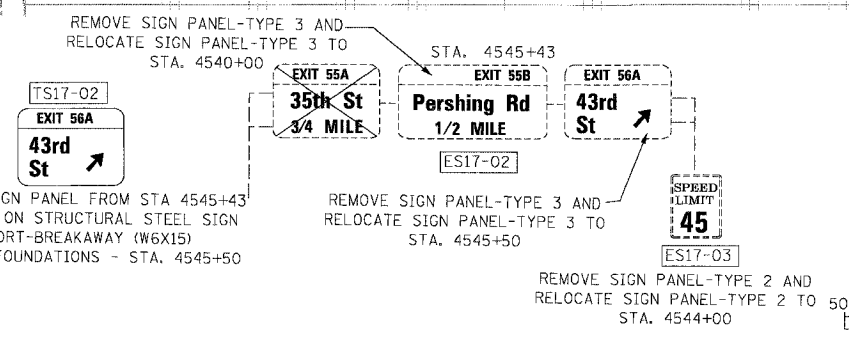
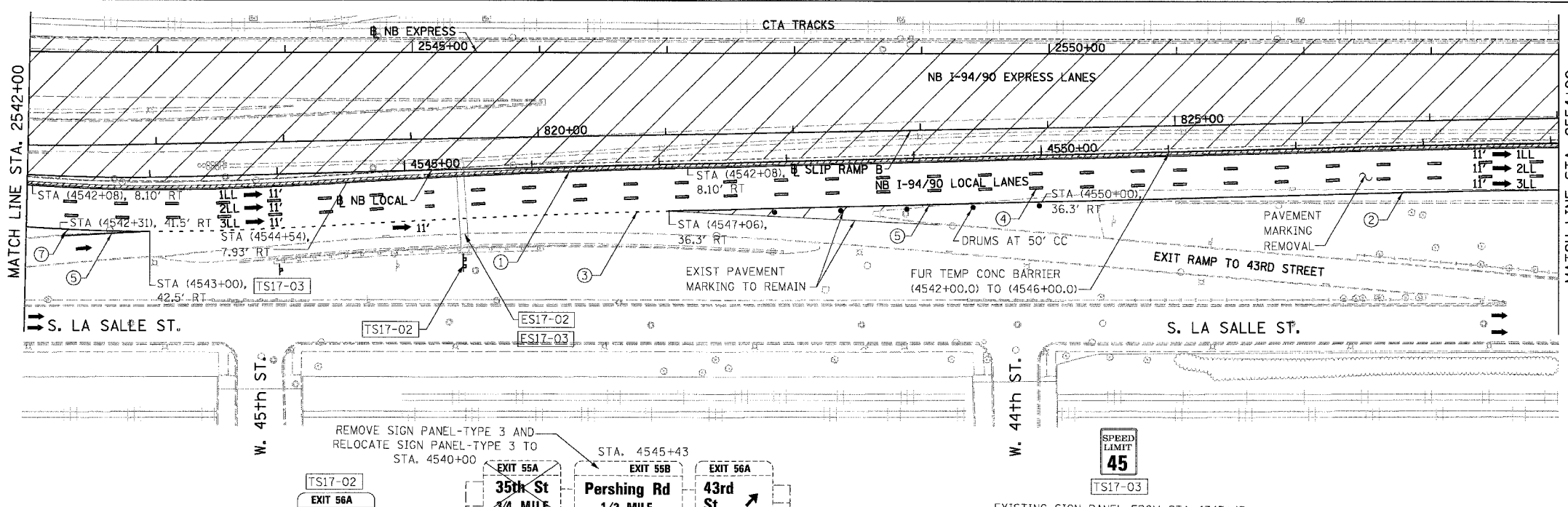

EXISTING SIGN PANEL FROM STA 4545+43 INSTALLED ON WOOD SIGN SUPPORT AT STA. 4544+00

**NOTE:**  
ALL PAVEMENT MARKINGS ON THIS SHEET WILL BE PAVEMENT MARKING TAPE, TYPE III, UNLESS OTHERWISE NOTED.

REVISIONS	NAME	DATE

ILLINOIS DEPARTMENT OF TRANSPORTATION  
**F.A.I. 94/90 (DAN RYAN EXPRESSWAY)**  
 31ST STREET TO 71ST STREET  
 NB EXPRESS LANE RECONSTRUCTION  
 MAINTENANCE OF TRAFFIC PLAN STAGE 1  
 NORTHBOUND STA. 2530+00 TO STA. 2554+00  
 SCALE: 1"=50'  
 DATE: 07/07/05  
 DRAWN BY: RA  
 CHECKED BY: RS

**STATIONING**  
 +\*\*.\*\* STATION PROVIDED FROM THE I-90/94 EXPRESS LANES  
 (+\*\*.\*\*\*) STATION PROVIDED FROM THE I-90/94 LOCAL LANES  
 [+\*\*.\*\*] STATION PROVIDED FROM THE SLIP RAMP

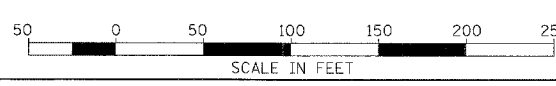

BOWMAN, BARRETT & ASSOCIATES INC.  
 CONSULTING ENGINEERS  
 Chicago, Illinois  
 312.228.0100  
 www.bbainc.com

MOT-14  
 6/27/2005