

**DROP MANHOLE LOCATIONS:**

- DMH 74: COULD NOT LOCATE.
- DMH 75: MANHOLE IS LOCATED UNDERNEATH THE I94 INBOUND EXPRESS LANES. TAKE THE 22ND STREET EXIT AND THE MANHOLE IS NEXT TO THE LEFT SHOULDER, APPROXIMATELY 100' SOUTH OF AN OVERHEAD SIGN FOR 22ND STREET.
- DMH 76: LOCATED BELOW THE I94 OUTBOUND EXPRESS LANES. MANHOLE IS IN THE LEFT SHOULDER OF THE SOUTHBOUND CHINA TOWN RAMP SOUTH OF 27TH STREET.
- DMH 76A: COULD NOT LOCATE.
- DMH 77: LOCATED BELOW I94 IN A LOT AT 27TH STREET AND WENTWORTH. MANHOLE IS 50' WEST OF WENTWORTH AND 125' NORTH OF 27TH STREET.

F.A.I.	SECTION	COUNTY	TOTAL SHEETS	SHEET NO.
94/90	*	COOK	556	203
STA. 2638+00		TO STA.		
FED. ROAD DIST. NO.	ILLINOIS	FED. AID PROJECT		
62300		* (1818, ETC, 2324.6-1PIR-8		

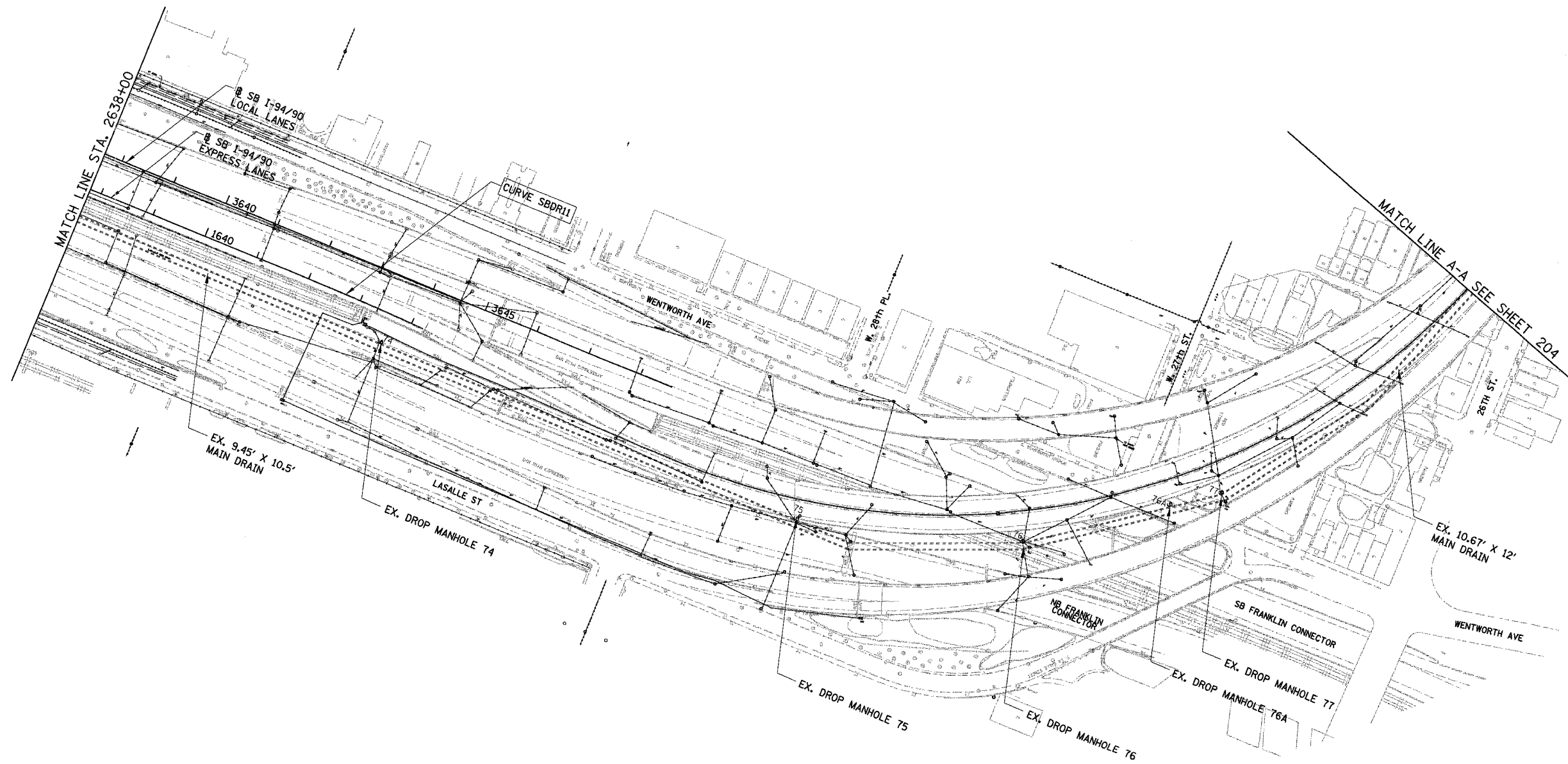

NOTE: NO PROPOSED DRAINAGE WORK THIS SHEET. THIS SHEET PROVIDED FOR INFORMATION ONLY EXISTING MAIN DRAIN DROP MANHOLE LOCATIONS SHOWN BASED ON 2002 MAIN DRAIN TELEVISIONING REPORT.

BOWMAN, BARRETT & ASSOCIATES INC.  
CONSULTING ENGINEERS  
134 EAST RANDOLPH STREET SUITE 2450 CHICAGO, ILLINOIS 60601  
JOB NO. 600

REVISIONS	
NAME	DATE

ILLINOIS DEPARTMENT OF TRANSPORTATION  
F.A.I. 94/90 (DAN RYAN EXPRESSWAY)  
31ST STREET TO 71ST STREET  
NB EXPRESS LANE RECONSTRUCTION  
DRAINAGE AND UTILITIES PLAN  
EXISTING MAIN DRAIN NORTH OF 31ST  
SCALE: 1"=100'  
DATE: 07/07/05  
DRAWN BY: JAM  
CHECKED BY: DDM

DU-47  
03/26/05 PM