

STATE OF ILLINOIS
DEPARTMENT OF TRANSPORTATION

F.A.I. RT.:	SECTION	COUNTY	TOTAL SHEETS	SHEET NO.
90/94	•	COOK	556	383
STA.	TO STA.			
FED. ROAD DIST. NO. 1 ILLINOIS FED. AID PROJECT				
• (1818, ETC, 2324.6-1P)R-8				62300

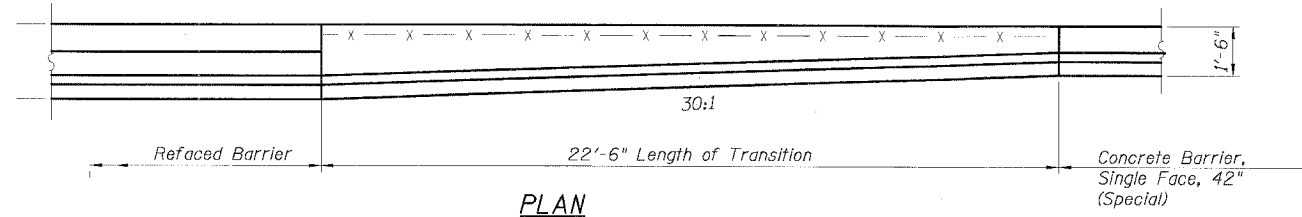

PLAN

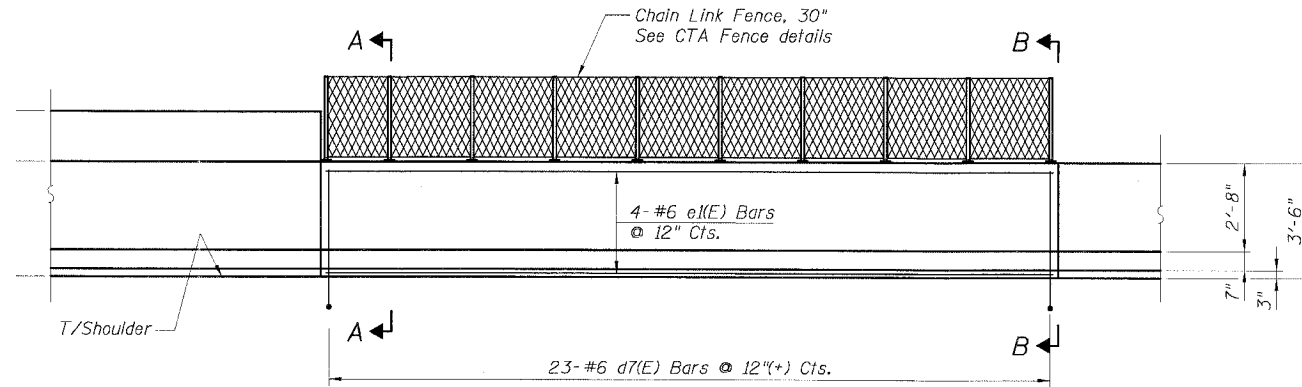

ELEVATION

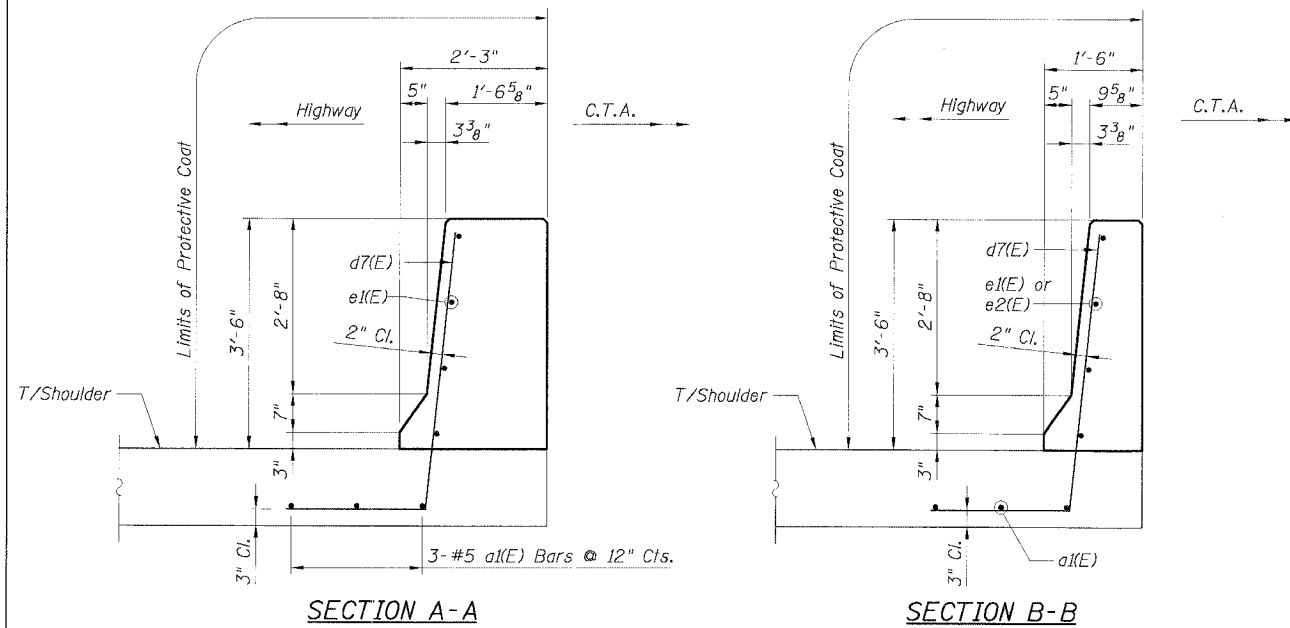

SECTION A-A

SECTION B-B

BILL OF MATERIAL

Bar	No.	Size	Length	Shape
a1(E)	3	#5	22'-2"	—
d7(E)	23	#6	6'-9"	—
e1(E)	4	#6	22'-2"	—
Item	Unit	Quantity		
Reinforcement Bars, Epoxy Coated	Lbs.	470		
Concrete Structures	Cu. Yd.	4.2		
Protective Coat	Sq. Yd.	12.2		

NOTES:

- Provide joints in facing to match those in the Existing Barrier.
- For d7(E) bar details, see Sheet B14.
- For Refaced Barrier details, see Sheets B4 and B5.
- For Concrete Barrier, Single Face, 42" (Special), see Civil details.
- For locations of Transition, see Roadway Plans.

Sheet B15 of 16

REVISIONS		ILLINOIS DEPARTMENT OF TRANSPORTATION F.A.I. 90/94 (DAN RYAN EXPRESSWAY) EXISTING BARRIER WALL MODIFICATIONS AT CTA STATIONS PROPOSED T/SHOULDER AT OR ABOVE EXISTING REFACED BARRIER TO NEW 42" BARRIER TRANSITION DETAILS
NAME	DATE	
		SCALE: None
		DATE: JULY 7, 2005
		DRAWN BY: CHD
		CHECKED BY: RDP

CTE | AECOM

CTE
301 East Wacker Drive, Suite 600, Chicago, Illinois 60601-5276
773.293.0300 F 773.293.1105 www.cte.aecom.com

06/24/2005 02:44:06 PM