

F.A.I. RTE.	SECTION	COUNTY	TOTAL SHEETS	SHEET NO.
94/90		COOK	598	60
STA.	TO STA.			
FED. ROAD DIST. NO.	ILLINOIS FED. AID PROJECT			
62302	1815, ETC, 2324.6-1P/R-9			

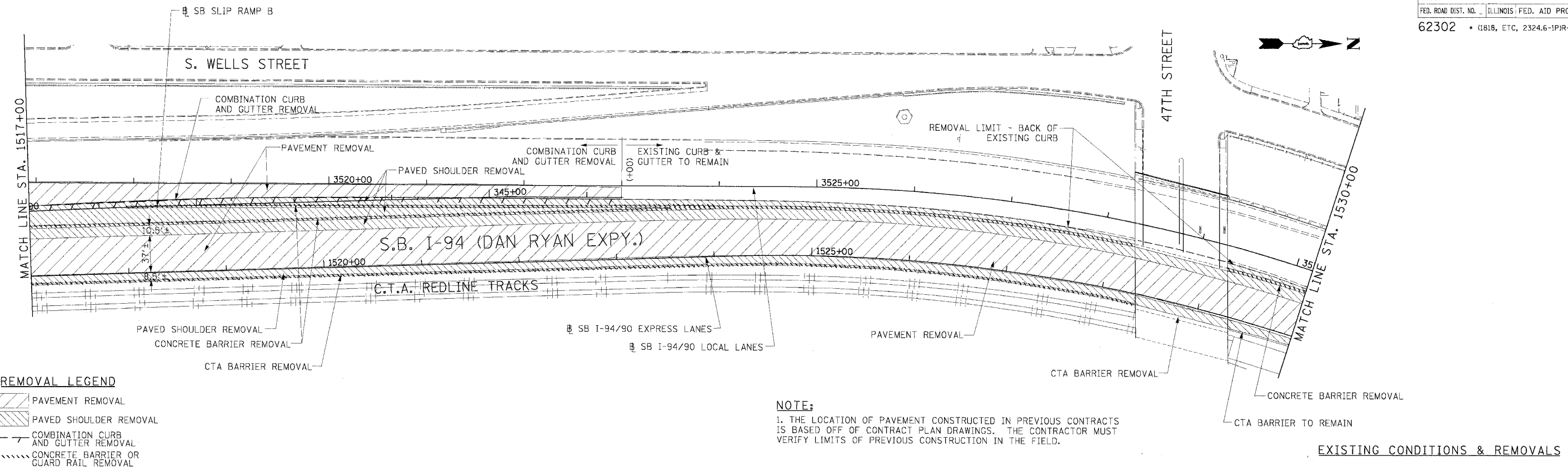

- REMOVAL LEGEND**
- PAVEMENT REMOVAL
  - PAVED SHOULDER REMOVAL
  - COMBINATION CURB AND GUTTER REMOVAL
  - CONCRETE BARRIER OR GUARD RAIL REMOVAL

**NOTE:**  
1. THE LOCATION OF PAVEMENT CONSTRUCTED IN PREVIOUS CONTRACTS IS BASED OFF OF CONTRACT PLAN DRAWINGS. THE CONTRACTOR MUST VERIFY LIMITS OF PREVIOUS CONSTRUCTION IN THE FIELD.

**EXISTING CONDITIONS & REMOVALS**

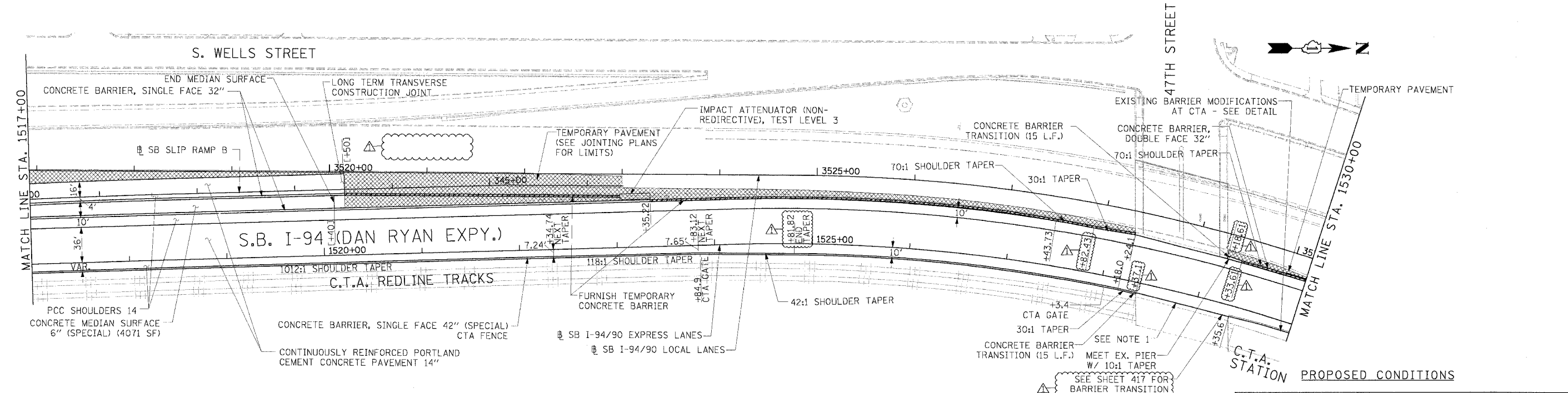

- LEGEND**
- TEMPORARY PAVEMENT (INTERSTATE)/TEMPORARY SHOULDER

**NOTE:**  
1. BRIDGE OVER EXPRESS LANES OMITTED FOR CLARITY.

**STATIONING**  
 +\*\*.\* STATION PROVIDED FROM THE SB I-90/94 EXPRESS LANES  
 (+\*\*.\*\*) STATION PROVIDED FROM THE SB I-90/94 LOCAL LANES  
 [+\*\*.\*\*\*] STATION PROVIDED FROM THE SLIP RAMP

REVISIONS	
NAME	DATE
ADDENDUM 1	8/12/05

ILLINOIS DEPARTMENT OF TRANSPORTATION  
 F.A.I. 94/90 (DAN RYAN EXPRESSWAY)  
 31ST STREET TO 71ST STREET  
 SB EXPRESS LANE RECONSTRUCTION  
 EXISTING AND PROPOSED PLAN  
 SOUTHBOUND STA. 1517+00 TO STA. 1530+00

SCALE: 1"=50'  
 DATE: 7/7/05

DRAWN BY: TAJ  
 CHECKED BY: PJM

**Edwards AND Kelcey**  
 ONE NORTH FRANKLIN  
 CHICAGO, IL 60606  
 PHONE: (312) 251-3000  
 FAX: (312) 251-3015  
 WEB: WWW.EDKCORP.COM

RDY-11  
 02.31.09 PM