

F.A.I. RTE.	SECTION	COUNTY	TOTAL SHEETS	SHEET NO.
90/94		COOK	598	424K
STA.		TO STA.		
FED. ROAD DIST. NO. 1		ILLINOIS FED. AID PROJECT		
4818, ETC. 2324.6-191R-9		62302		

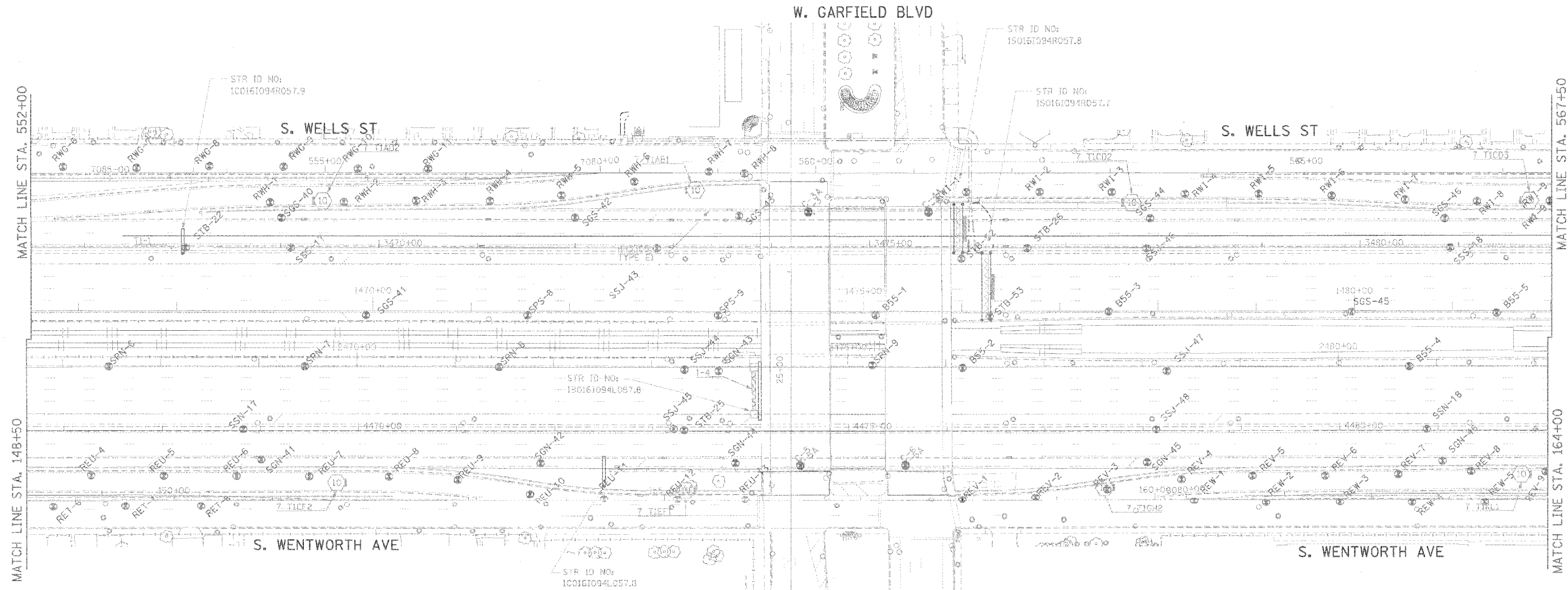

LEGEND FOR BORINGS

- PROPOSED SIGN STRUCTURE
- HIGH MAST LIGHT POLE
- HML : HIGH MAST LIGHT POLE
- REC : RETAINING WALL, EAST SIDE, WALL-D
- REW : RETAINING WALL, EAST SIDE, WALL-W
- RWC : RETAINING WALL, WEST SIDE, WALL-C
- RWL : RETAINING WALL, WEST SIDE, WALL-L
- SIA : RETAINING WALL, INTERCHANGE, WALL IA
- SSN : STORM SEWER, NORTHBOUND
- SSS : STORM SEWER, SOUTHBOUND
- SSJ : STORM SEWER, JACKING
- STB : SIGN STRUCTURE
- SSB : BRIDGE
- SSW : BRIDGE
- SGN : SUBGRADE, NORTHBOUND
- SGS : SUBGRADE, SOUTHBOUND
- BRN : 47th ST. RAMP
- C : CURBING

ADDED SHEET



REVISIONS	
NAME	DATE
ADDENDUM #2	9-16-05

ILLINOIS DEPARTMENT OF TRANSPORTATION
 F.A.I. 90/94 (DAN RYAN EXPRESSWAY)
 71ST STREET TO 31ST STREET (SB EXPRESS LANES)

SOIL BORING LOCATIONS

SCALE: 1"=50'
 DATE: September 16, 2005
 DRAWN BY: PHP
 CHECKED BY: JAL

CTE | AECOM