

F.A.I. R/F.C.	SECTION	COUNTY	TOTAL SHEETS	SHEET NO.
90/94		COOK	598	424M
STA.	TO STA.		PROJECT	
			FED. ROAD DIST. NO. 1 ILLINOIS FED. AID PROJECT	
			• GB18, ETC. 2324.6-IPR-9 62302	

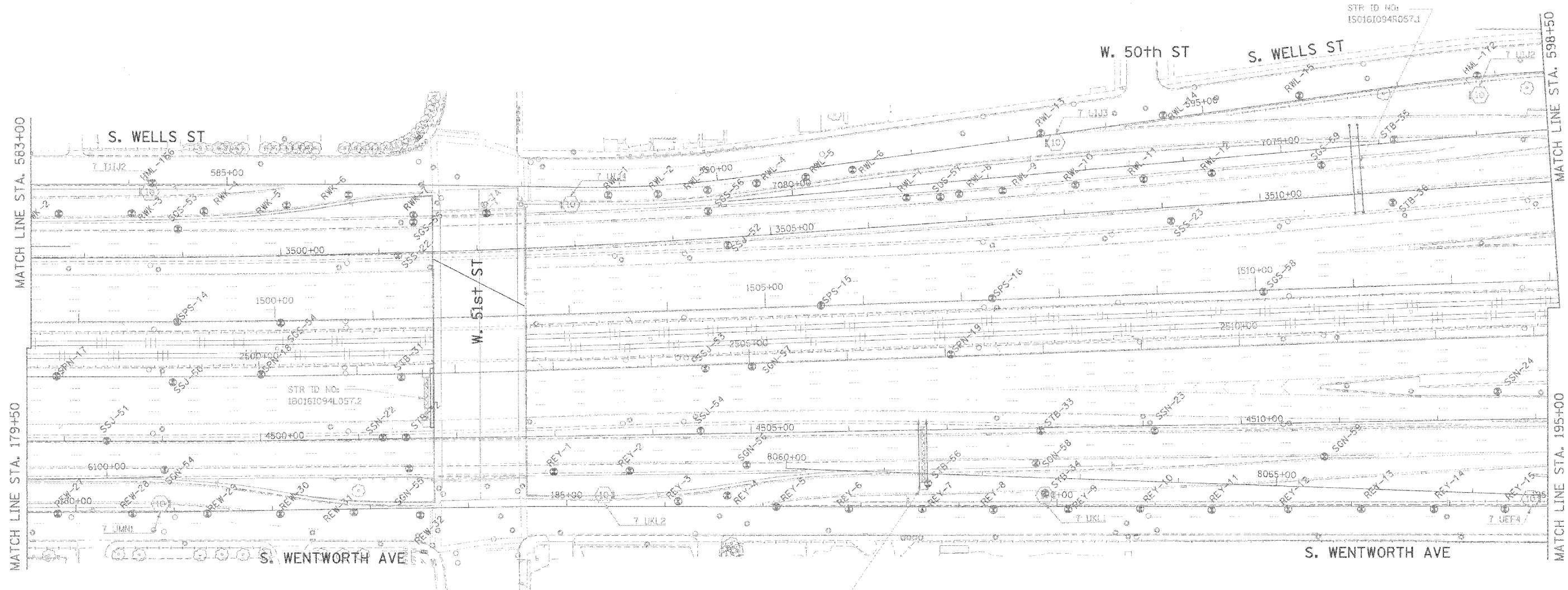

**LEGEND FOR BORINGS**

- PROPOSED SIGN STRUCTURE
- HIGH MAST LIGHT POLE
- HML : HIGH MAST LIGHT POLE
- RED : RETAINING WALL, EAST SIDE, WALL-D
- REW : RETAINING WALL, EAST SIDE, WALL-W
- RWC : RETAINING WALL, WEST SIDE, WALL-C
- RWL : RETAINING WALL, WEST SIDE, WALL-L
- SIA : RETAINING WALL, INTERCHANGE, WALL IA
- SSN : STORM SEWER, NORTHBOUND
- SSS : STORM SEWER, SOUTHBOUND
- SSJ : STORM SEWER, JACKING
- STB : SIGN STRUCTURE
- SSB : BRIDGE
- SEN, SWW : BRIDGE
- SGN : SUBGRADE, NORTHBOUND
- SOS : SUBGRADE, SOUTHBOUND
- BRN : 47TH ST. RAMP
- C : BORING

ADDU SHEET



REVISIONS	
NAME	DATE
ADDENDUM #2	9-16-05

ILLINOIS DEPARTMENT OF TRANSPORTATION  
 F.A.I. 90/94 (DAN RYAN EXPRESSWAY)  
 71ST STREET TO 31ST STREET (SB EXPRESS LANES)

**SOIL BORING LOCATIONS**

SCALE: 1"=50'  
 DATE: September 16, 2005  
 DRAWN BY: PHP  
 CHECKED BY: JAL