

F.A.I. RFL	SECTION	COUNTY	TOTAL SHEETS	SHEET NO.
90/94		COOK	598	4241
STA.	TO STA.		FED. AID PROJECT	
			• 01816, ETC, 2324.6-1PR-9	62302

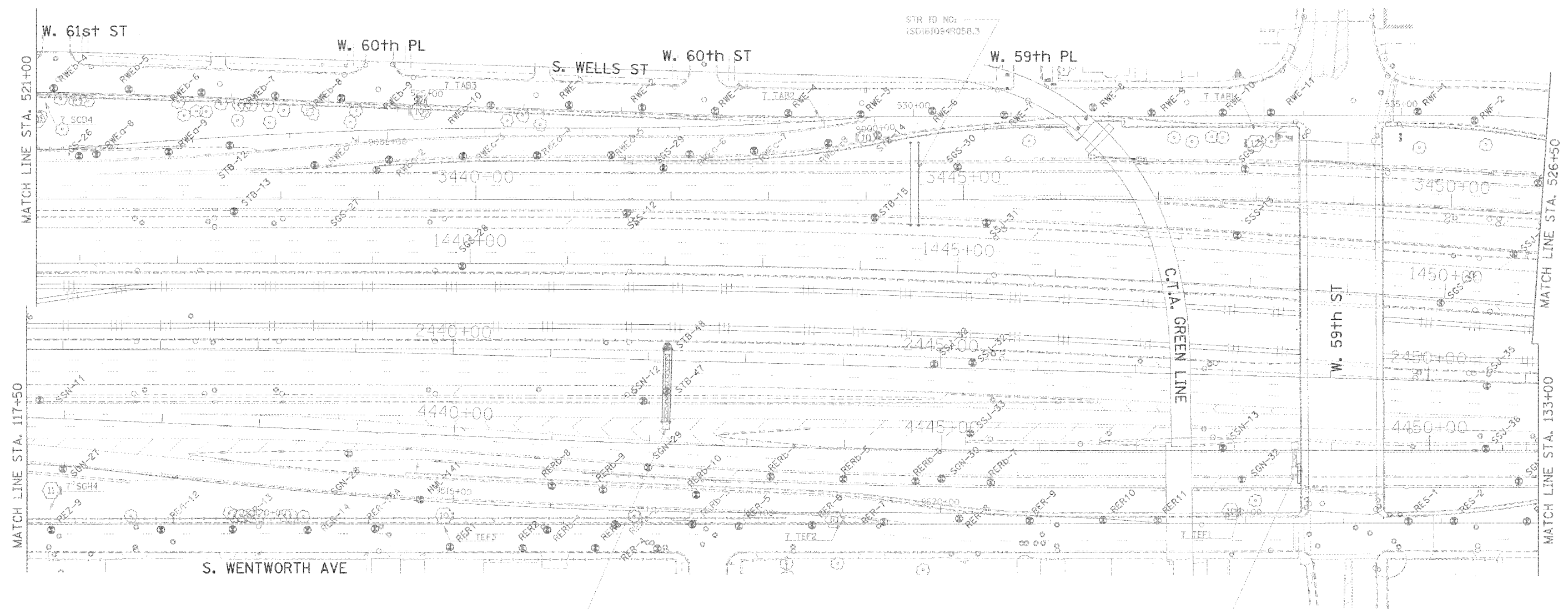

STR ID NO:
150161094L058.4

LEGEND FOR BORINGS

- PROPOSED SIGN STRUCTURE
- HIGH MAST LIGHT POLE
- HML : HIGH MAST LIGHT POLE
- RED : RETAINING WALL, EAST SIDE, WALL-D
- REW : RETAINING WALL, EAST SIDE, WALL-W
- RWC : RETAINING WALL, WEST SIDE, WALL-C
- RWL : RETAINING WALL, WEST SIDE, WALL-L
- SJA : RETAINING WALL, INTERCHANGE, WALL IA
- SSN : STORM SEWER, NORTHBOUND
- SSS : STORM SEWER, SOUTHBOUND
- SSJ : STORM SEWER, JACKING
- STB : SIGN STRUCTURE
- SSB : BRIDGE
- SEW.SRW : BRIDGE
- SGN : SUBGRADE, NORTHBOUND
- SGS : SUBGRADE, SOUTHBOUND
- BRN : 47th ST. RAMP
- C : CURBING

STR ID NO:
150161094L058.2

ADDED SHEET



REVISIONS	
NAME	DATE
ADDENDUM #2	9-15-05

ILLINOIS DEPARTMENT OF TRANSPORTATION
F.A.I. 90/94 (DAN RYAN EXPRESSWAY)
71ST STREET TO 31ST STREET (SB EXPRESS LANES)

SOIL BORING LOCATIONS

SCALE: 1"=50'
DATE: September 16, 2005
DRAWN BY: PHP
CHECKED BY: JAL

CTE | AECOM