

LEGEND

ELEVATION STATIONED OFF OF SB I-94/90 EXPRESS LANES
 (###) ELEVATION STATIONED OFF OF SB I-94/90 LOCAL LANES
 [###] ELEVATION STATIONED OFF OF SLIP RAMP ALIGNMENT

SB I-94/90 LOCAL LANES
 SB I-94/90 EXPRESS LANES

NOTE:

1. PAVEMENT ELEVATIONS ALONG RAMPS, GORES AND IN AREAS OF SUPERELEVATION TRANSITION ARE PROVIDED AT 25' INTERVALS. FOR ALL OTHER ELEVATIONS, REFER TO PROFILE AND TYPICAL SECTIONS.

| | | | | |
|---|---------|-----------------------------------|---------------------|------------------|
| F.A.I. RTE. 94/90 | SECTION | COUNTY COOK | TOTAL SHEETS 598 | SHEET NO. 267 |
| STA. 62302 | | TO STA. 11818, ETC. 2324.6-1PJR-9 | | |
| FED. ROAD DIST. NO. ILLINOIS FED. AID PROJECT | | | | |

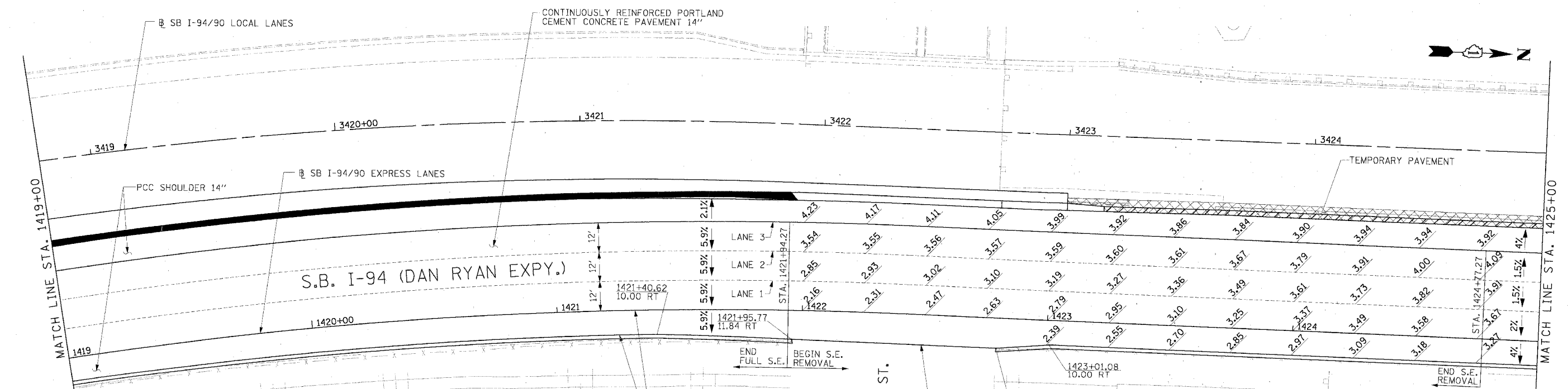
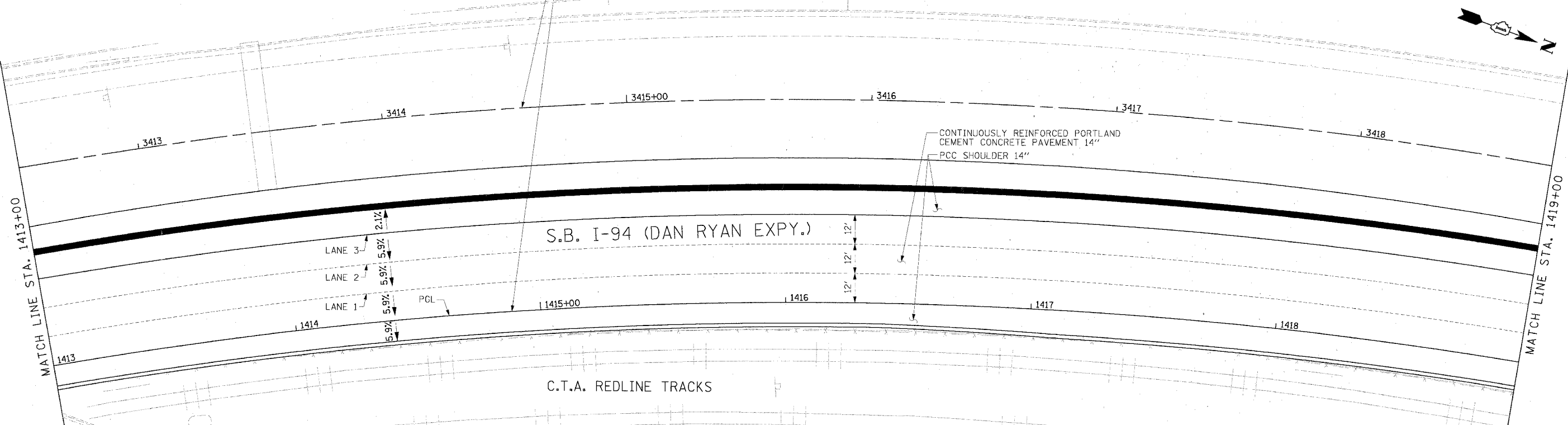

Edwards AND Kelcey
 ONE NORTH FRANKLIN CHICAGO, IL 60608
 PHONE: (312) 251-3000
 FAX: (312) 251-3015
 WEB: WWW.EKCORP.COM

| REVISIONS NAME | DATE |
|----------------|------|
| | |
| | |
| | |
| | |

ILLINOIS DEPARTMENT OF TRANSPORTATION
 F.A.I. 94/90 (DAN RYAN EXPRESSWAY)
 31ST STREET TO 71ST STREET
 SB EXPRESS LANE RECONSTRUCTION
 PAVEMENT JOINTING AND ELEVATION PLAN
 SOUTHBOUND STA. 1413+00 TO STA. 1425+00
 SCALE: 1"=20'
 DATE: 7/7/05
 DRAWN BY: TAI
 CHECKED BY: PJM

06/21/2005 10:06:59 AM