

F.A.I.	SECTION	COUNTY	TOTAL SHEETS	SHEET NO.
94/90		COOK	556	94
STA. 2530+00		TO STA. 2554+00		
FED. ROAD DIST. NO.	ILLINOIS	FED. AID PROJECT		
62300		*(1818, ETC, 2324.6-1P)R-8		

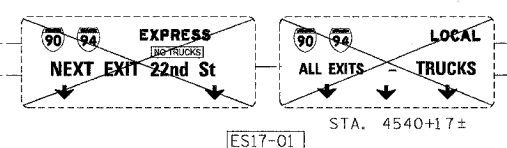

EXISTING SIGN PANEL FROM STA 4545+43 INSTALLED ON STRUCTURAL STEEL SIGN SUPPORT-BREAKAWAY (W6X15) CONCRETE FOUNDATIONS - STA. 4540+00

- LEGEND**
- WORK ZONE
 - TEMPORARY PAVEMENT
 - 1LL TRAFFIC LANE & DIRECTION OF TRAFFIC
 - DRUM OR BARRICADE TYPE II WITH STEADY BURN LIGHT
 - IMPACT ATTENUATORS, TEMPORARY (NON-REDIRECTIVE), TEST LEVEL 3
 - BARRICADE TYPE III
 - TEMPORARY CONCRETE BARRIER
 - LINE 4" (YELLOW EDGE LINE)
 - LINE 4" (WHITE EDGE LINE)
 - LINE 4" (SKIP DASH, 6' SKIP - 2' DASH, WHITE)
 - LINE 5" (SKIP DASH, 30' SKIP - 10' DASH, WHITE)
 - LINE 8" (WHITE GORE LINE)
 - LINE 8" (SKIP DASH, 12' SKIP - 3' DASH, WHITE)
 - LINE 12" (DIAGONAL, 30' C-C)
 - LINE 12" (DIAGONAL, 500' C-C)
 - LETTERS AND SYMBOLS
 - EXISTING SIGNS
 - TEMPORARY SIGNS

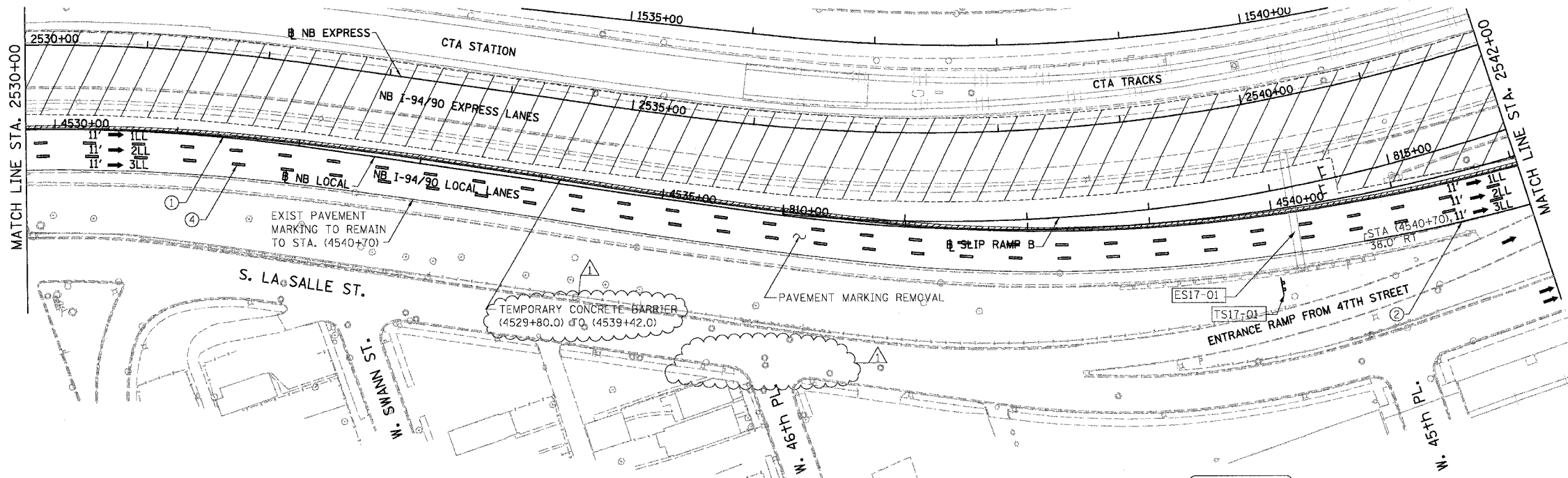
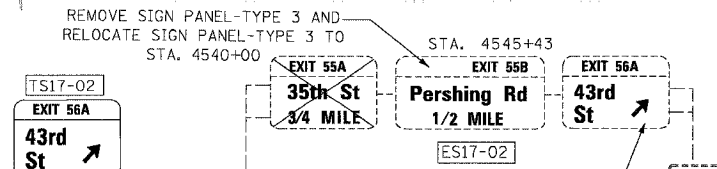
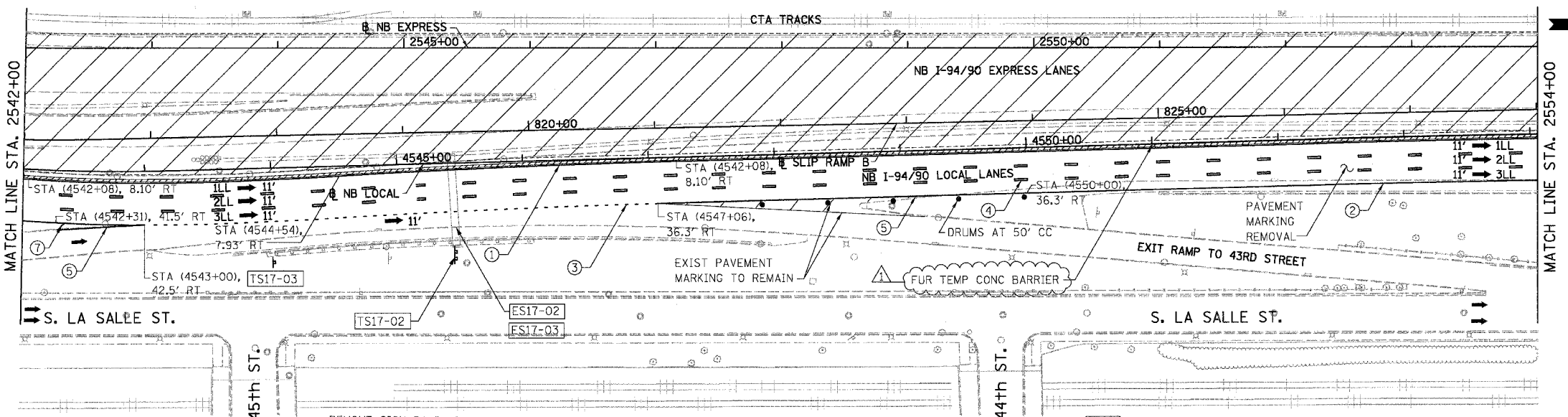

EXISTING SIGN PANEL FROM STA 4545+43 INSTALLED ON STRUCTURAL STEEL SIGN SUPPORT-BREAKAWAY (W6X15) CONCRETE FOUNDATIONS - STA. 4545+50

REMOVE SIGN PANEL-TYPE 3 AND RELOCATE SIGN PANEL-TYPE 3 TO STA. 4545+50

REMOVE SIGN PANEL-TYPE 2 AND RELOCATE SIGN PANEL-TYPE 2 TO STA. 4544+00

EXISTING SIGN PANEL FROM STA 4545+43 INSTALLED ON WOOD SIGN SUPPORT AT STA. 4544+00

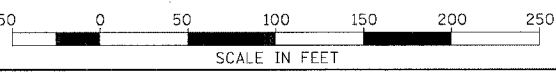

NOTE:
ALL PAVEMENT MARKINGS ON THIS SHEET WILL BE PAVEMENT MARKING TAPE, TYPE III, UNLESS OTHERWISE NOTED.

BOWMAN, BARRETT & ASSOCIATES INC
CONSULTING ENGINEERS
Chicago, Illinois
312.228.0100
www.bbainc.com

STATIONING
+###.## STATION PROVIDED FROM THE I-90/94 EXPRESS LANES
(+###.##) STATION PROVIDED FROM THE I-90/94 LOCAL LANES
[+###.##] STATION PROVIDED FROM THE SLIP RAMP

REVISIONS	
NAME	DATE
ADDENDUM 1	8/12/05

ILLINOIS DEPARTMENT OF TRANSPORTATION
F.A.I. 94/90 (DAN RYAN EXPRESSWAY)
31ST STREET TO 71ST STREET
NB EXPRESS LANE RECONSTRUCTION
MAINTENANCE OF TRAFFIC PLAN STAGE 1
NORTHBOUND STA. 2530+00 TO STA. 2554+00
SCALE: 1"=50'
DATE: 07/07/05

DRAWN BY: RA
CHECKED BY: RS

MOT-14
3/28/05