

F.A.I. RTE.	SECTION	COUNTY	TOTAL SHEETS	SHEET NO.
94/90		COOK	556	255
STA.	TO STA.			
	62300		ILLINOIS FED. AID PROJECT	
1818, ETC, 2324.6-1PR-8				

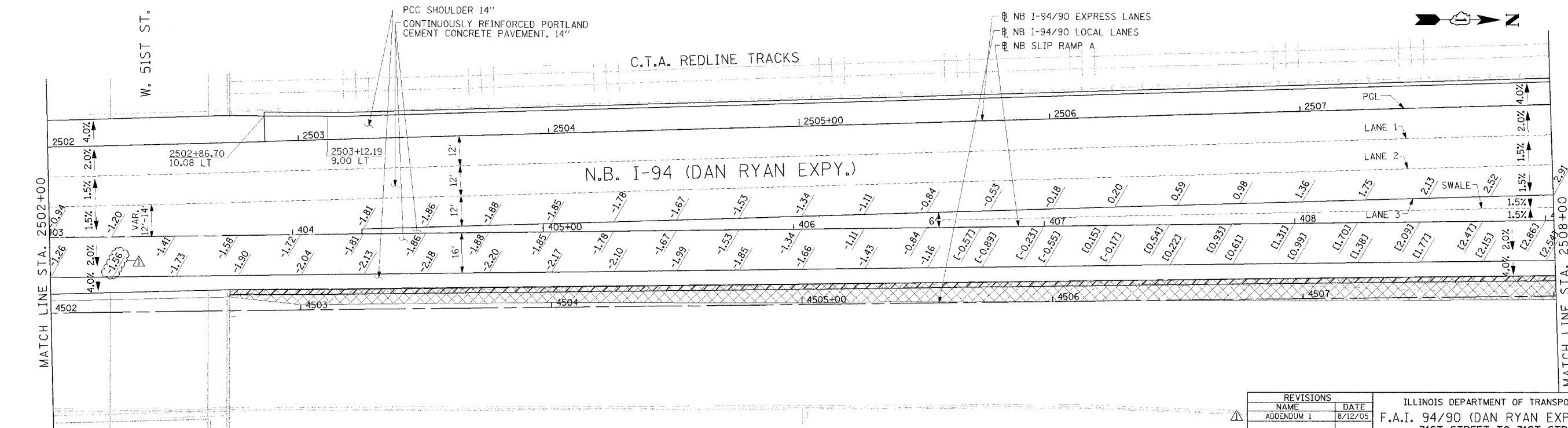
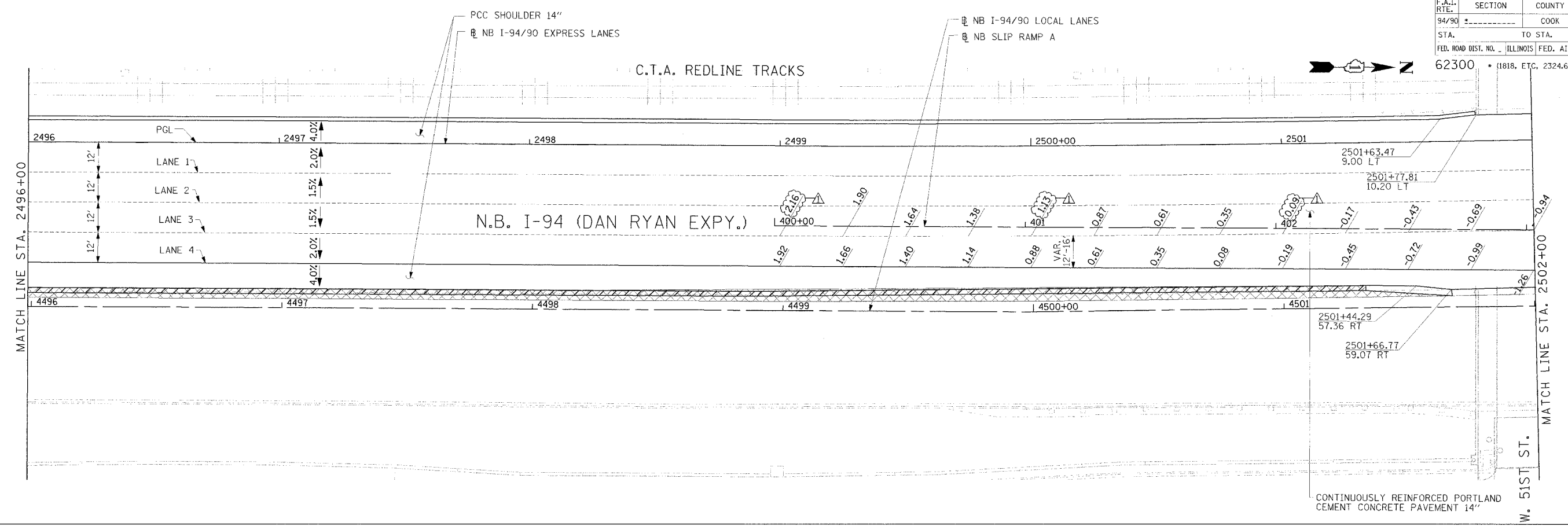

Edwards and Kelcey
 ONE NORTH FRANKLIN
 CHICAGO, IL 60606
 PHONE: (312) 251-3000
 FAX: (312) 251-3015
 WEB: WWW.EKCORP.COM

LEGEND
 [**] ELEVATION STATIONED OFF OF NB I-94/90 EXPRESS LANES
 [*]**] ELEVATION STATIONED OFF OF SB I-94/90 LOCAL LANES
 [#]**] ELEVATION STATIONED OFF OF SLIP RAMP ALIGNMENT

NOTE:
 1. PAVEMENT ELEVATIONS ALONG RAMPS, GORES AND IN AREAS OF SUPERELEVATION TRANSITION ARE PROVIDED AT 25' INTERVALS. FOR ALL OTHER ELEVATIONS, REFER TO PROFILE AND TYPICAL SECTIONS.

REVISIONS	
NAME	DATE
ADDENDUM 1	8/12/05

ILLINOIS DEPARTMENT OF TRANSPORTATION
 F.A.I. 94/90 (DAN RYAN EXPRESSWAY)
 31ST STREET TO 71ST STREET
 NB EXPRESS LANE RECONSTRUCTION
 PAVEMENT JOINTING AND ELEVATION PLAN
 NORTHBOUND STA. 2496+00 TO STA. 2508+00
 SCALE: 0' 10' 20' 30' 40'
 DATE: 7/7/05
 DRAWN BY: TAI
 CHECKED BY: PJM

JT-12
 08/11/2005 02:34:23 PM