

F.A.I. RTE. 90/94	SECTION	COUNTY	TOTAL SHEETS 556	SHEET NO. 3841
STA.	TO STA.			
FED. ROAD DIST. NO. 1	ILLINOIS	FED. AID PROJECT		
• (1818, ETC, 2324.6-JPR-8			62300	

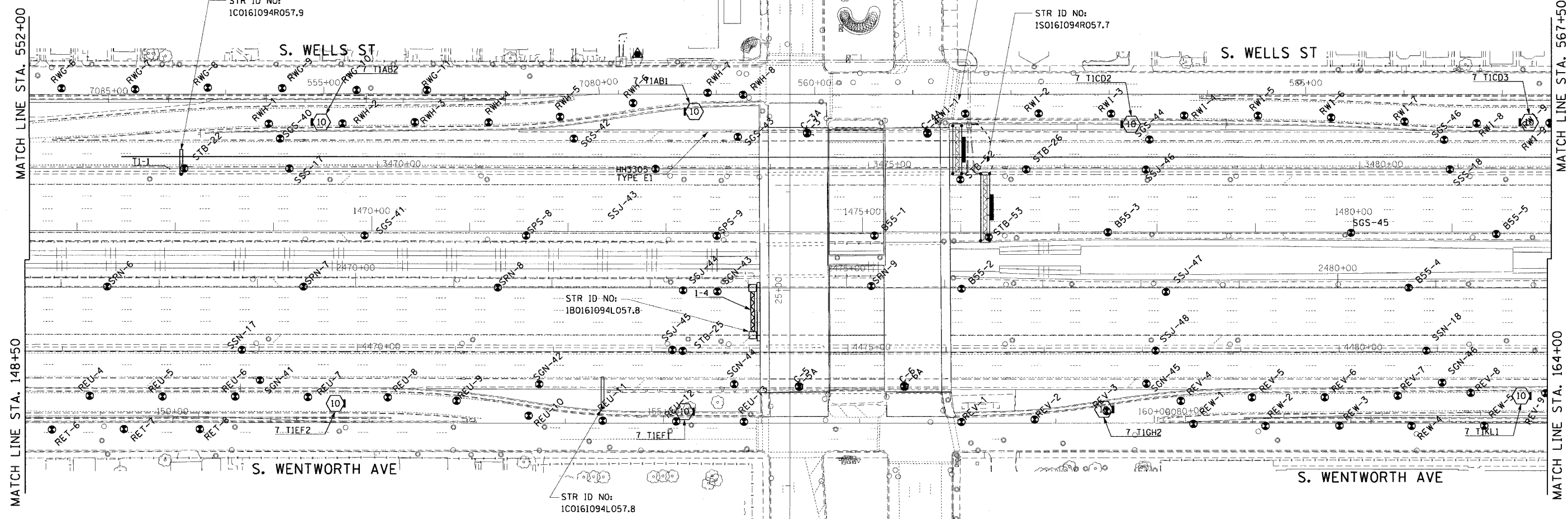

**LEGEND FOR BORINGS**

- PROPOSED SIGN STRUCTURE
- HIGH MAST LIGHT POLE
- HML : HIGH MAST LIGHT POLE
- REO : RETAINING WALL, EAST SIDE, WALL-O
- REW : RETAINING WALL, EAST SIDE, WALL-W
- RWC : RETAINING WALL, WEST SIDE, WALL-C
- RWL : RETAINING WALL, WEST SIDE, WALL-L
- SIA : RETAINING WALL, INTERCHANGE, WALL IA
- SSN : STORM SEWER, NORTHBOUND
- SSS : STORM SEWER, SOUTHBOUND
- SSJ : STORM SEWER, JACKING
- STB : SIGN STRUCTURE
- SSB : BRIDGE
- SEW.SWW : BRIDGE
- SGN : SUBGRADE, NORTHBOUND
- SGS : SUBGRADE, SOUTHBOUND
- BRN : 47th ST. RAMP
- C : CORING

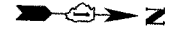
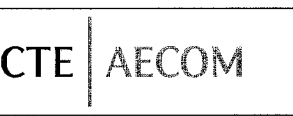

REVISIONS	
NAME	DATE
ADDENDUM #2	9-16-05



ILLINOIS DEPARTMENT OF TRANSPORTATION  
 F.A.I. 90/94 (DAN RYAN EXPRESSWAY)  
 71ST STREET TO 31ST STREET (NB EXPRESS LANES)

**SOIL BORING LOCATIONS**

SCALE: 1"=50'  
 DATE: September 16, 2005  
 DRAWN BY: PHP  
 CHECKED BY: JAL

9/16/2005 9:34:47 AM