

EXISTING CONDITIONS & REMOVALS

| | | | | |
|----------------------------------|----------|------------------|--------------|-----------|
| F.A.I. | SECTION | COUNTY | TOTAL SHEETS | SHEET NO. |
| 94/90 | | COOK | 598 | 208 |
| STA. | TO STA. | | | |
| FED. ROAD DIST. NO. | ILLINOIS | FED. AID PROJECT | | |
| 62302 • (1818, ETC, 2324.6-1)R-9 | | | | |

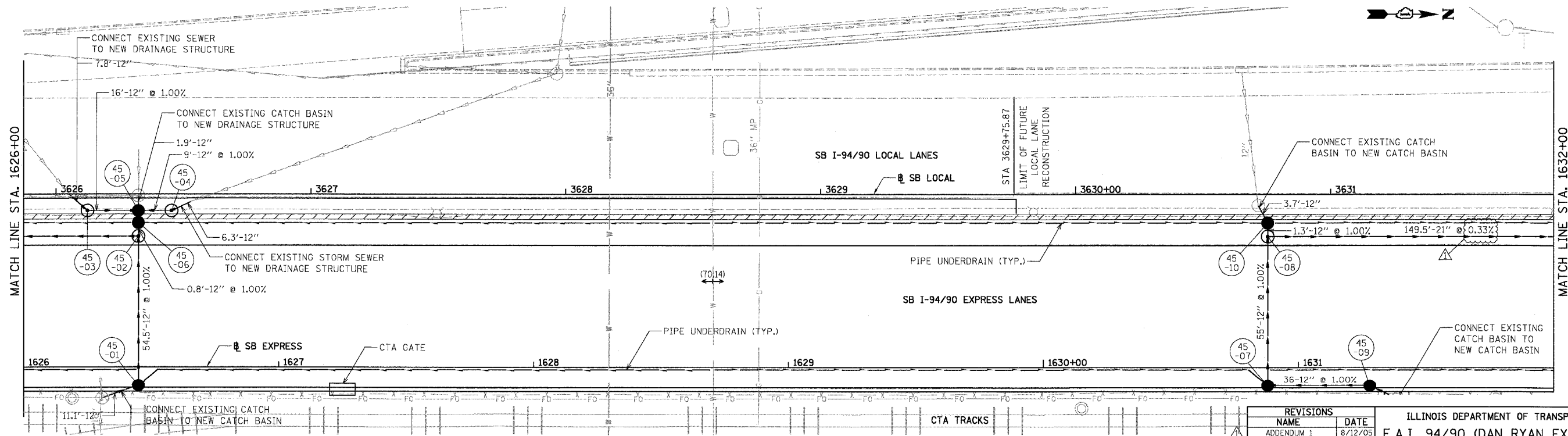

BOWMAN, BARRETT & ASSOCIATES INC.
CONSULTING ENGINEERS
Chicago, Illinois
312.228.0100
www.bbainc.com

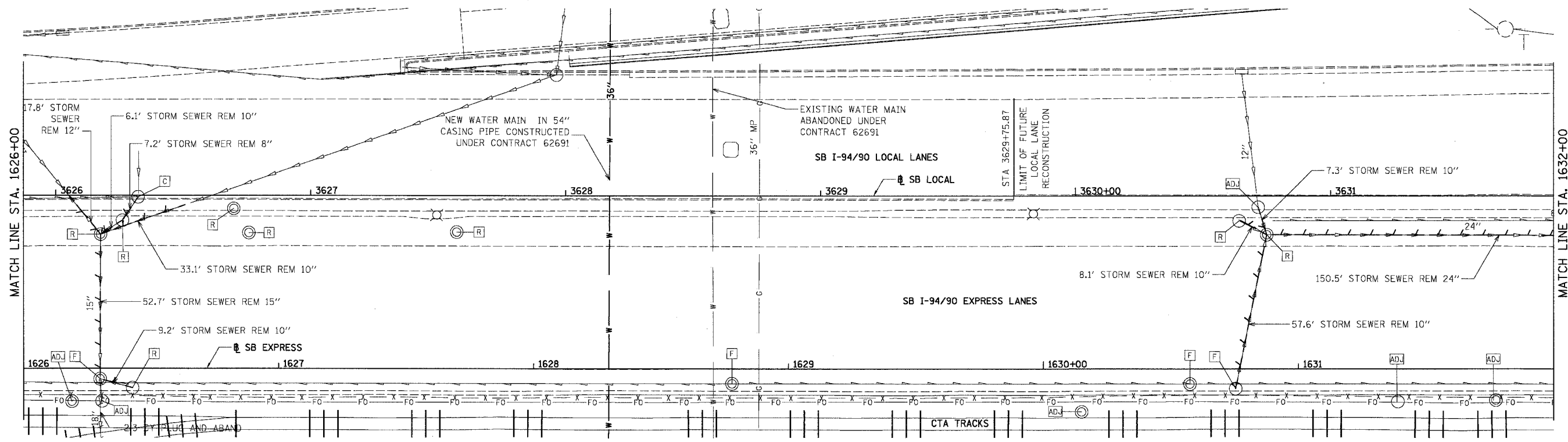
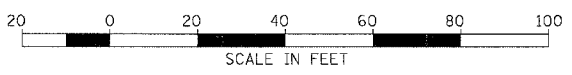

PROPOSED CONDITIONS

| REVISIONS | |
|------------|---------|
| NAME | DATE |
| ADDENDUM 1 | 8/12/05 |
| | |
| | |
| | |
| | |
| | |

ILLINOIS DEPARTMENT OF TRANSPORTATION
F.A.I. 94/90 (DAN RYAN EXPRESSWAY)
31ST STREET TO 71ST STREET
SB EXPRESS LANE RECONSTRUCTION
DRAINAGE AND UTILITIES PLAN
SOUTHBOUND STA. 1626+00 TO STA. 1632+00
SCALE: 1"=20'
DATE: 07/07/05
DRAWN BY: OC
CHECKED BY: DDM

DU-45
12-36-05 PM
8/11/2005