

F.A.I. R.T.E.	SECTION	COUNTY	TOTAL SHEETS	SHEET NO.
94/90		COOK	598	274
STA. 62302		TO STA. 62302		
FED. ROAD DIST. NO. ILLINOIS FED. AID PROJECT 1818, ETC. 2324.6-1P/R-9				

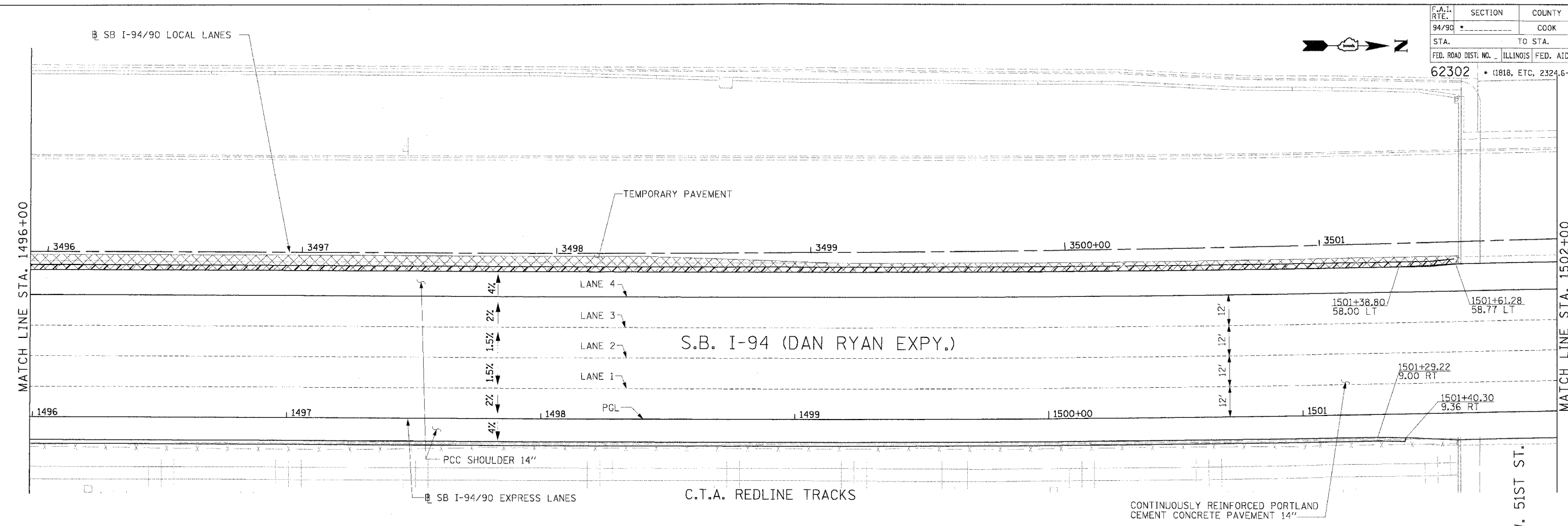

NOTE:
 1. PAVEMENT ELEVATIONS ALONG RAMPS, GORES AND IN AREAS OF SUPERELEVATION TRANSITION ARE PROVIDED AT 25' INTERVALS. FOR ALL OTHER ELEVATIONS, REFER TO PROFILE AND TYPICAL SECTIONS.

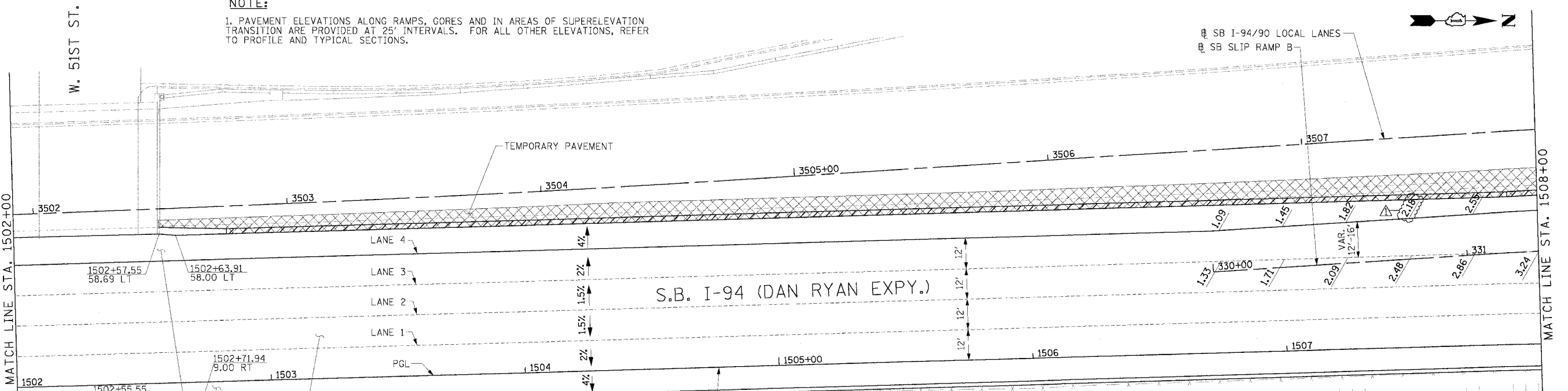

Edwards AND Kelcey
 ONE NORTH FRANKLIN
 CHICAGO, IL 60606
 PHONE: (312) 251-3000
 FAX: (312) 251-3015
 WEB: WWW.EKCORP.COM

LEGEND
 #.# ELEVATION STATIONED OFF OF SB I-94/90 EXPRESS LANES
 #.#.# ELEVATION STATIONED OFF OF SB I-94/90 LOCAL LANES
 [#.#.#] ELEVATION STATIONED OFF OF SLIP RAMP ALIGNMENT

REVISIONS	
NAME	DATE
ADDENDUM 1	8/12/05

ILLINOIS DEPARTMENT OF TRANSPORTATION
 F.A.I. 94/90 (DAN RYAN EXPRESSWAY)
 31ST STREET TO 71ST STREET
 SB EXPRESS LANE RECONSTRUCTION
 PAVEMENT JOINTING AND ELEVATION PLAN
 SOUTHBOUND STA. 1496+00 TO STA. 1508+00
 SCALE: 0" 10' 20' 30' 40'
 DATE: 7/7/05
 DRAWN BY: TAI
 CHECKED BY: PJM

P:\03\09\90\35\work\148\p\card\5\15151228.dwg 08/10/2005 02:57:57 PM