

STATE OF ILLINOIS
DEPARTMENT OF TRANSPORTATION

F.A.I. RTE.	SECTION	COUNTY	TOTAL SHEETS	SHEET NO.
90/94		COOK	598	420
STA.	TO STA.			
FED. ROAD DIST. NO. 1 ILLINOIS FED. AID PROJECT				
• (1816, ETC, 2324.6-10R-9 62302				

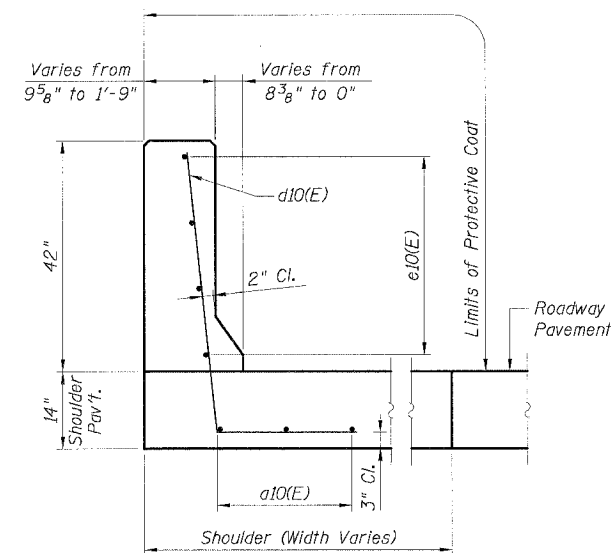
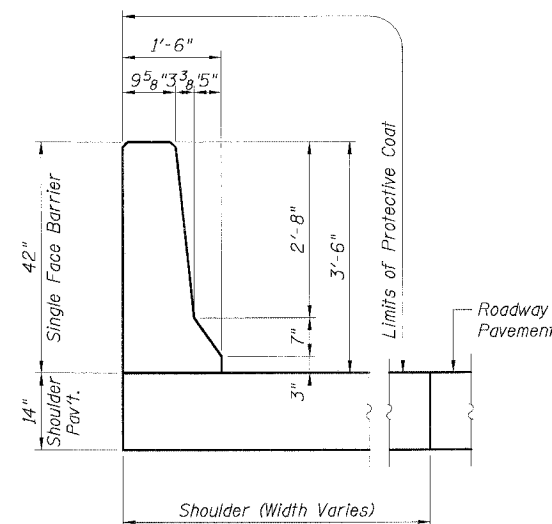
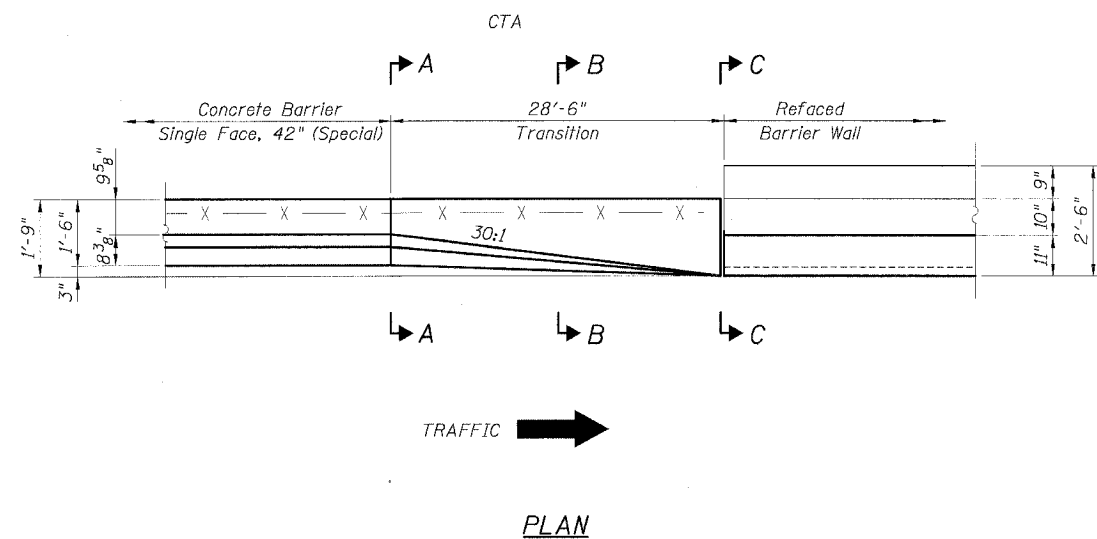

SECTION A-A

SECTION B-B

BILL OF MATERIAL
FOR ONE TRANSITION

Bar	No.	Size	Length	Shape
a10	3	#5	28'-2"	—
d10	29	#6	6'-9"	L
e10	4	#4	28'-2"	—
Item	Unit	Quantity		
Reinforcement Bars, Epoxy Coated	Pound	457		
Concrete Superstructure	Cu. Yd.	5.2		
Protective Coat	Sq. Yd.	15		

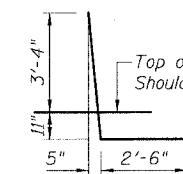

BAR d10(E)

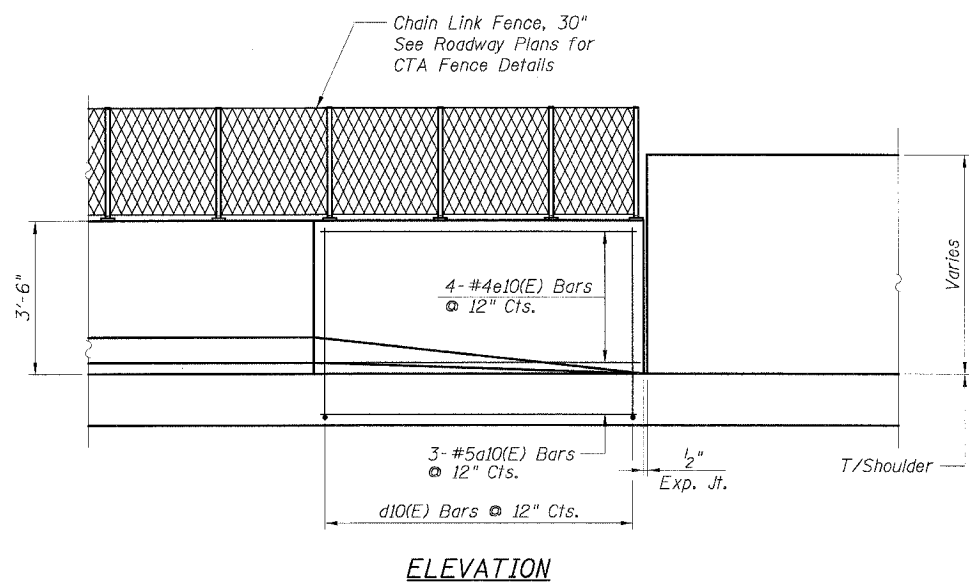

ELEVATION

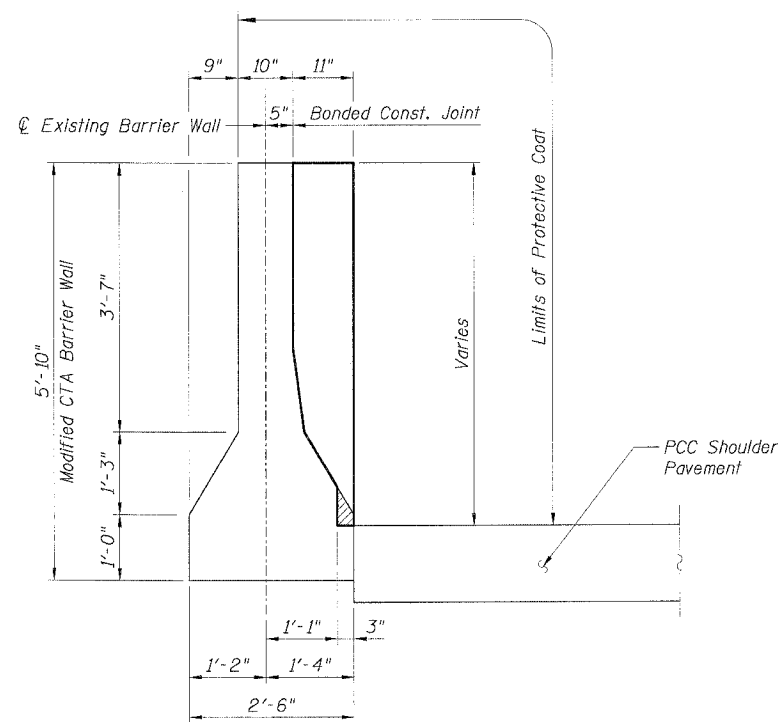

SECTION C-C

NOTES:

1. For alternative vertical reinforcing details, see "Concrete Barrier Single Face, 42" Alternates".
2. For existing CTA Barrier modifications - vertical facing, see sheet B7.
3. For Expansion Joint details see Sheet B6.
4. For locations of Transition, see Roadway Plans.

CTE | AECOM

REVISIONS	
NAME	DATE
MJP	8-12-05

ILLINOIS DEPARTMENT OF TRANSPORTATION
F.A.I. 90/94 (DAN RYAN EXPRESSWAY)
71ST STREET TO 31ST STREET (SB EXPRESS LANES)
EXISTING BARRIER WALL MODIFICATIONS
AT CTA STATIONS
PROPOSED T/S SHOULDER AT OR ABOVE EXISTING
NEW 42" BARRIER TO VERT. REFACED BARRIER
TRANSITION DETAILS (TAPER)
SCALE: None DRAWN BY: CHD
DATE: July 7, 2005 CHECKED BY: RDP

Sheet B12 of 18

3/10/2005 11:02:41 AM