

F.A.I. RTE.	SECTION	COUNTY	TOTAL SHEETS	SHEET NO.
94/90		COOK	598	51
STA.	TO STA.		FED. AID PROJECT	
62302	(1818, ETC, 2324.6-1)PR-9			

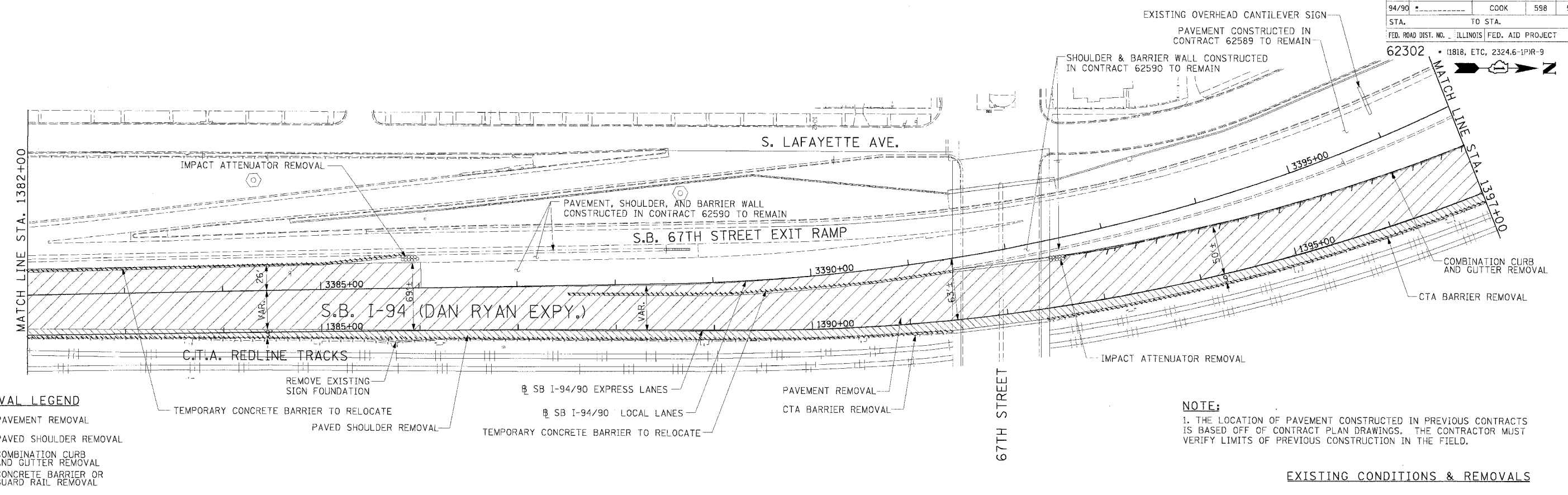

- REMOVAL LEGEND**
- PAVEMENT REMOVAL
 - PAVED SHOULDER REMOVAL
 - COMBINATION CURB AND GUTTER REMOVAL
 - CONCRETE BARRIER OR GUARD RAIL REMOVAL

NOTE:
1. THE LOCATION OF PAVEMENT CONSTRUCTED IN PREVIOUS CONTRACTS IS BASED OFF OF CONTRACT PLAN DRAWINGS. THE CONTRACTOR MUST VERIFY LIMITS OF PREVIOUS CONSTRUCTION IN THE FIELD.

EXISTING CONDITIONS & REMOVALS

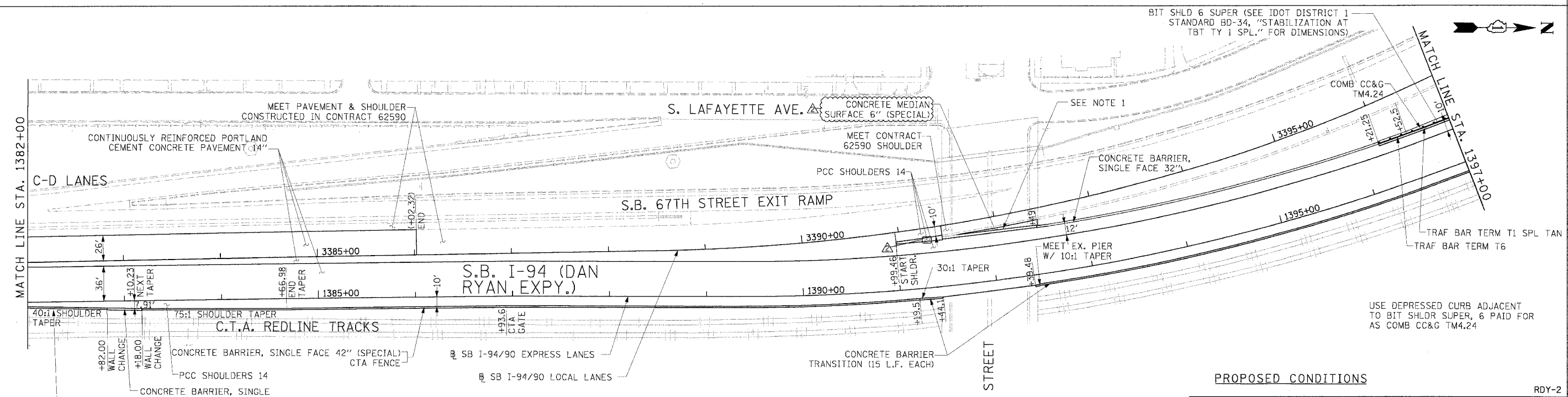

USE DEPRESSED CURB ADJACENT TO BIT SHLDR SUPER, 6 PAID FOR AS COMB CC&G TM4.24

PROPOSED CONDITIONS

Edwards AND Kelcey
ONE NORTH FRANKLIN CHICAGO, IL 60606
PHONE: (312) 251-3000
FAX: (312) 251-3015
WEB: WWW.EKCORP.COM

NOTE:
1. BRIDGE OVER EXPRESS LANES OMITTED FOR CLARITY.

- LEGEND**
- TEMPORARY PAVEMENT (INTERSTATE)/TEMPORARY SHOULDER
 - TEMPORARY CONCRETE BARRIER

STATIONING

+**.** STATION PROVIDED FROM THE SB I-90/94 EXPRESS LANES

(+**.** STATION PROVIDED FROM THE SB I-90/94 LOCAL LANES

[+**.** STATION PROVIDED FROM THE SLIP RAMP

REVISIONS	
NAME	DATE
ADDENDUM 2	9/16/05

ILLINOIS DEPARTMENT OF TRANSPORTATION
F.A.I. 94/90 (DAN RYAN EXPRESSWAY)
31ST STREET TO 71ST STREET
SB EXPRESS LANE RECONSTRUCTION
EXISTING AND PROPOSED PLAN
SOUTHBOUND STA. 1382+00 TO STA. 1397+00

SCALE: 1"=50'
DATE: 7/7/05

DRAWN BY: TAI
CHECKED BY: PJM

09/14/2005 10:53:55 AM