

# INDEX OF SHEETS

SHEET NO.	DESCRIPTION
1	COVER SHEET
2	INDEX OF SHEETS / HIGHWAY STANDARDS
3 - 4	GENERAL NOTES
5 - 7	SUMMARY OF QUANTITIES
8 - 9	TYPICAL CROSS SECTIONS
10 - 12	STAGING TYPICAL CROSS SECTIONS
13 - 30	SCHEDULE OF QUANTITIES
31 - 32	TIE POINTS & BENCHMARKS
33 - 39	F.A.I 70 PLAN SHEETS
40 - 47	GUARDRAIL PLAN SHEETS
48 - 51	TEMPORARY CONCRETE BARRIER LAYOUT DETAILS
52 - 57	PROPOSED PAVING DETAILS
58	SLOPE DETAILS FOR PIPE UNDERDRAINS, TYPE 2, 6"
59	MISCELLANEOUS DETAILS
60	WINGWALL MODIFICATION DETAIL TR 138 OVER FAI 70 SN 018-0017
61	DISTRICT 7 DETAIL NO. 601101A - OUTLET PROTECTOR
62 - 65	DISTRICT 7 DETAIL NO. 78000001 - PAVEMENT MARKING AND RAISED REFLECTIVE PAVEMENT MARKERS (RURAL & URBAN APPLICATIONS)

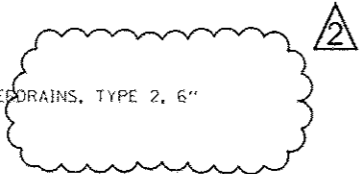

# HIGHWAY STANDARDS

STANDARD NO.	DESCRIPTION
000001-06	STANDARD SYMBOLS, ABBREVIATIONS AND PATTERNS
001001-02	AREAS OF REINFORCEMENT BARS
001006	DECIMAL OF AN INCH AND OF A FOOT
442001-04	CLASS A PATCHES
482001-02	HMA SHOULDER ADJACENT TO FLEXIBLE PAVEMENT
601001-05	PIPE UNDERDRAINS
630001-10	STEEL PLATE BEAM GUARDRAIL
630301-06	SHOULDER WIDENING FOR TYPE 1 (SPECIAL) GUARDRAIL TERMINALS
631011-09	TRAFFIC BARRIER TERMINAL, TYPE 2
631031-14	TRAFFIC BARRIER TERMINAL, TYPE 6
631033-06	TRAFFIC BARRIER TERMINAL, TYPE 6B
635001-02	DELINEATORS
642001-02	SHOULDER RUMBLE STRIPS, 16 IN.
701101-05	OFF-RD OPERATIONS, MULTILANE, 15' (4.5 M) TO 24" (600MM) FROM PAVEMENT EDGE
701106-02	OFF-RD OPERATIONS, MULTILANE, MORE THAN 15' (4.5 M) AWAY
701201-04	LANE CLOSURE, 2L, 2W, DAY ONLY, FOR SPEEDS >= 45 MPH
701400-08	APPROACH TO LANE CLOSURE, FREEWAY/EXPRESSWAY
701401-09	LANE CLOSURE, FREEWAY/EXPRESSWAY
701402-11	LANE CLOSURE, FREEWAY/EXPRESSWAY, WITH BARRIER
701406-10	LANE CLOSURE, FREEWAY/EXPRESSWAY, DAY OPERATIONS ONLY
701426-08	LANE CLOSURE, MULTILANE, INTERMITTENT OR MOVING OPERATION, FOR SPEEDS >= 45 MPH
701901-05	TRAFFIC CONTROL DEVICES
720011-01	METAL POSTS FOR SIGNS, MARKERS & DELINEATORS
725001	OBJECT AND TERMINAL MARKERS
780001-05	TYPICAL PAVEMENT MARKINGS
781001-04	TYPICAL APPLICATIONS RAISED REFLECTIVE PAVEMENT MARKERS
782006	GUARDRAIL AND BARRIER WALL REFLECTOR MOUNTING DETAILS

REV. 10-27-2016

SUMMARY OF QUANTITIES			90% FED, 10% STATE TOTAL QUANTITIES	CONSTRUCTION TYPE CODE		
CODE NO	ITEM	UNIT		0005		
31101200	SUBBASE GRANULAR MATERIAL, TYPE B 4"	SQ YD	3670	3670		
40600290	BITUMINOUS MATERIALS (TACK COAT)	POUND	270640	270640		
40600990	TEMPORARY RAMP	SQ YD	230	230		
40603090	HOT-MIX ASPHALT BINDER COURSE, IL-19.0, N90	TON	23270	23270		
40603153	POLYMERIZED HOT-MIX ASPHALT SURFACE COURSE, STONE MATRIX ASPHALT, N80	TON	23660	23660		
40603240	POLYMERIZED HOT-MIX ASPHALT BINDER COURSE, IL-19.0, N90	TON	22930	22930		
40800029	BITUMINOUS MATERIALS (TACK COAT)	POUND	260	260		
40800050	INCIDENTAL HOT-MIX ASPHALT SURFACING	TON	70	70		
44000157	HOT-MIX ASPHALT SURFACE REMOVAL, 2"	SQ YD	77670	77670		
44000189	HOT-MIX ASPHALT SURFACE REMOVAL, 10"	SQ YD	90970	90970		
44200629	CLASS A PATCHES, TYPE I, 15 INCH	SQ YD	20	20		
44200630	CLASS A PATCHES, TYPE II, 15 INCH	SQ YD	130	130		
44200631	CLASS A PATCHES, TYPE III, 15 INCH	SQ YD	280	280		

SUMMARY OF QUANTITIES			90% FED, 10% STATE TOTAL QUANTITIES	CONSTRUCTION TYPE CODE		
CODE NO	ITEM	UNIT		0005		
44200632	CLASS A PATCHES, TYPE IV, 15 INCH	SQ YD	5500	5500		
44213000	PATCHING REINFORCEMENT	SQ YD	5930	5930		
44213200	SAW CUTS	FOOT	13040	13040		
44213204	TIE BARS 3/4"	EACH	2420	2420		
48102100	AGGREGATE WEDGE SHOULDER, TYPE B	TON	3330	3330		
48203005	HOT-MIX ASPHALT SHOULDERS, 2"	SQ YD	122580	122580		
48203029	HOT-MIX ASPHALT SHOULDERS, 8"	SQ YD	45490	45490		
48203037	HOT-MIX ASPHALT SHOULDERS, 10"	SQ YD	45490	45490		
50300225	CONCRETE STRUCTURES	CU YD	1.1	1.1		
50800105	REINFORCEMENT BARS	POUND	9690	9690		
50800205	REINFORCEMENT BARS, EPOXY COATED	POUND	190	190		
60100070	SHOULDER REMOVAL AND REPLACEMENT	FOOT	139670	139670		
<del>60108106</del>	<del>PIPE UNDERDRAINS, TYPE 1, 6"</del>	<del>FOOT</del>	<del>137470</del>	<del>137470</del>		
<del>60108206</del>	<del>PIPE UNDERDRAINS, TYPE 2, 6"</del>	<del>FOOT</del>	<del>137470</del>	<del>137470</del>		
60108200	PIPE UNDERDRAINS 6" (SPECIAL)	FOOT	5860	5860		

REV. 10-27-2016

FILE NAME =	USER NAME = steffennk	DESIGNED -	REVISED -
D:\11.284EB\ID\INTEG\Illinois.gov\PI\DOT\Do	Comments\DOT Offices\District 7\Projects\747	DRAWN -	REVISED -
		CHECKED -	REVISED -
Default	PLOT DATE = 8/11/2016	DATE -	REVISED -

STATE OF ILLINOIS  
DEPARTMENT OF TRANSPORTATION

SUMMARY OF QUANTITIES

SCALE: SHEET 1 OF 3 SHEETS STA. TO STA.

F.A.I. RTE.	SECTION	COUNTY	TOTAL SHEET SHEETS
70	(18-45)RS-5	CUMBERLAND	65 5
			CONTRACT NO. 74722
ILLINOIS FED. AID PROJECT			

# EXISTING TYPICAL CROSS SECTION ①

## F.A.I. 70

STATION TO STATION  
 2771+40.00 2772+59.71  
 2772+59.71 (BK.) = 9+02.89 (AH.)  
 9+02.89  
 50+00.00 410+00.00

STATION EQUATION ②

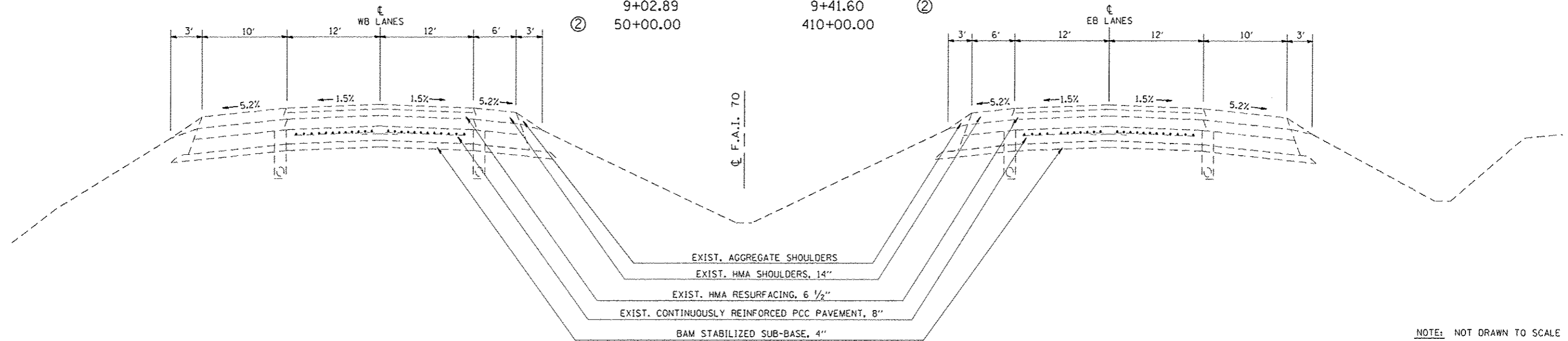

NOTE: NOT DRAWN TO SCALE

NOTE: ALL WORK IN WB LANES SHALL BE OMITTED FROM STA. 2771+40.00 TO STA. 108+45.00.

# PROPOSED TYPICAL CROSS SECTION ①

## F.A.I. 70

STATION TO STATION  
 2771+40.00 2772+59.71  
 2772+59.71 (BK.) = 9+02.89 (AH.)  
 9+02.89  
 50+00.00 410+00.00

STATION EQUATION ②

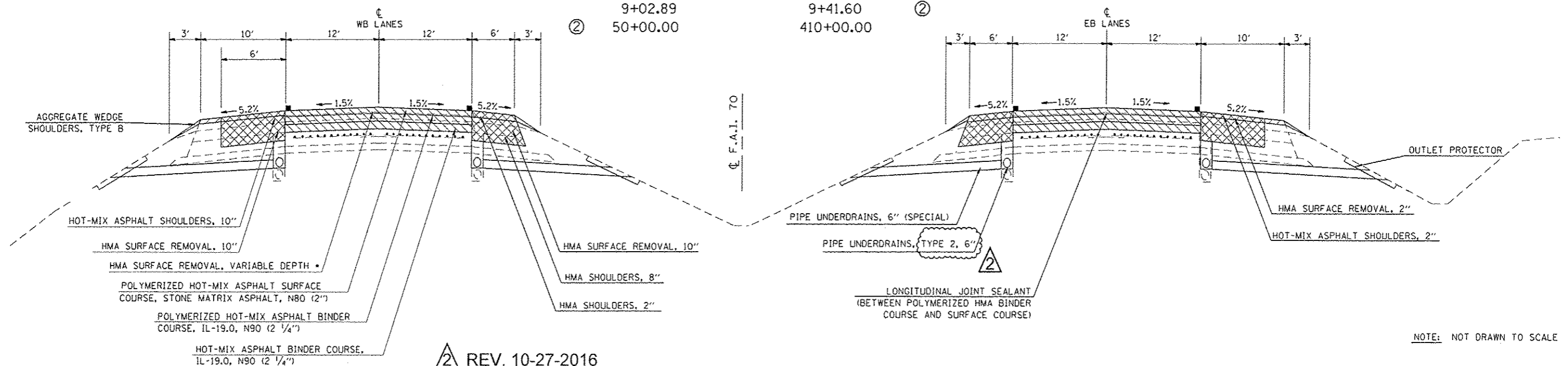

NOTE: NOT DRAWN TO SCALE

REV. 10-27-2016

STATE OF ILLINOIS  
 DEPARTMENT OF TRANSPORTATION

TYPICAL CROSS SECTIONS

FILE NAME : p:\11084EBID\HTEG\Illinois.gov\PW\DOT\Bo	USER NAME : staff\cmnk	DESIGNED : -	REVISED : -	SCALE: N/A	SHEET 1 OF 2 SHEETS	STA. TO STA.	F.A.I. RTE. 70	SECTION (18-45)RS-5	COUNTY CUMBERLAND	TOTAL SHEETS 65	SHEET NO. 8
PROJECTS\DOT Offices\District 7\Projects\747	DRAWN : CAB\shears\0774722-shr\typical	CHECKED : -	REVISED : -				CONTRACT NO. 74722				
PLOT SCALE : 100.0000 / in.	DATE : -	REVISED : -	REVISED : -				ILLINOIS FED. AID PROJECT				
PLOT DATE : 10/26/2016	DATE : -	REVISED : -	REVISED : -								

## EXISTING TYPICAL CROSS SECTION ②

F.A.I. 70

STATION ① 9+41.60 TO STATION ① 50+00.00

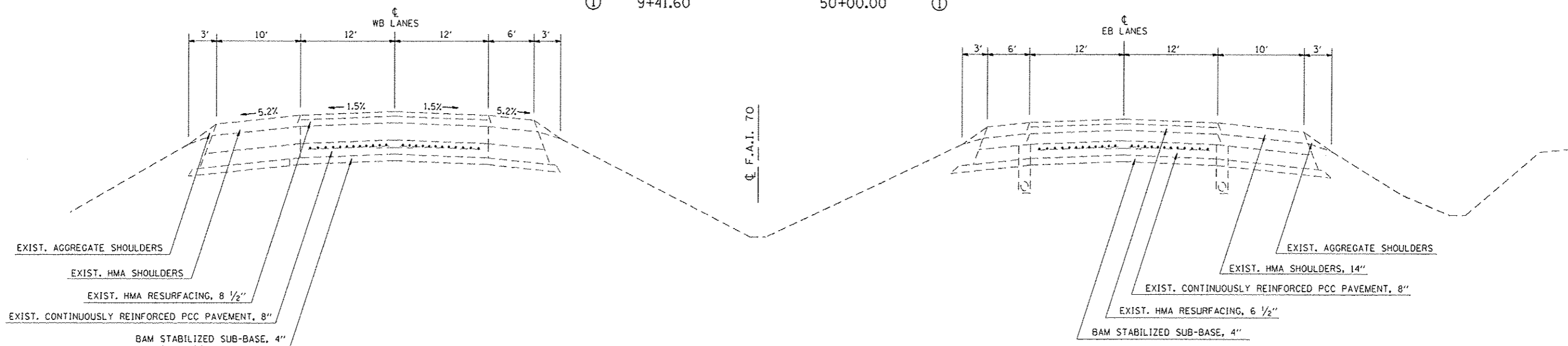

NOTE: NOT DRAWN TO SCALE

NOTE: ALL WORK IN WB LANES SHALL BE OMITTED FROM STA. 2771+40.00 TO STA. 108+45.00.

## PROPOSED TYPICAL CROSS SECTION ②

F.A.I. 70

STATION ① 9+41.60 TO STATION ① 50+00.00

• COMPLETE HMA OVERLAY SHALL BE REMOVED TO PCC PAVEMENT. SEE CORING REPORT FOR HMA OVERLAY DEPTHS.

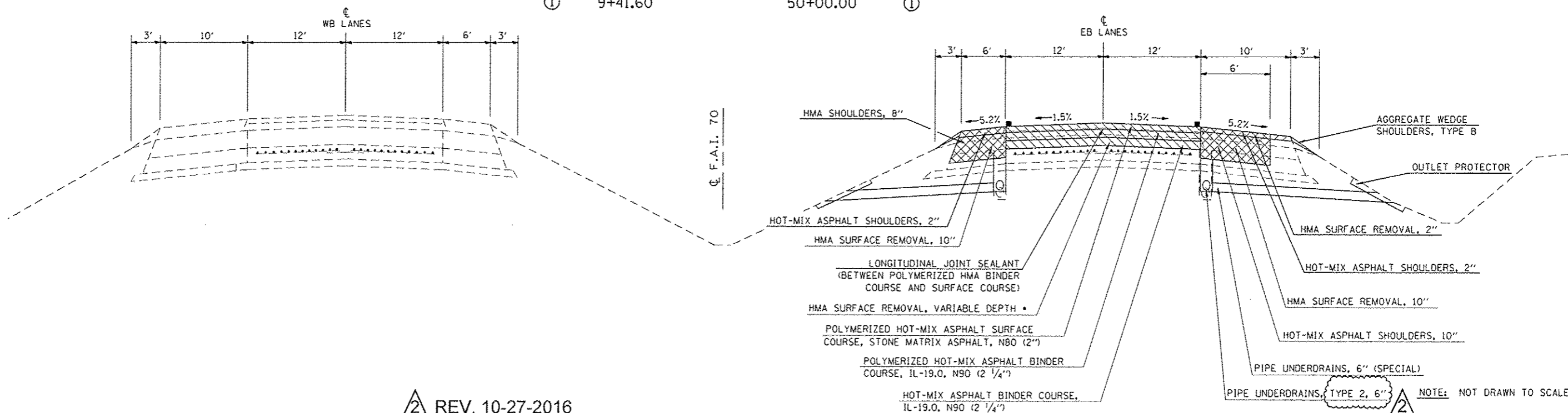

NOTE: NOT DRAWN TO SCALE

REV. 10-27-2016

STATE OF ILLINOIS  
DEPARTMENT OF TRANSPORTATION

TYPICAL CROSS SECTIONS

FILE NAME	USER NAME = steffennk	DESIGNED -	REVISED -
pl\11.084EBID\INTEG\Illinois.gov\PWIDOT\Documents\1001 Offices\District 7\Projects\742\DRAWING\CAD\Sheets\0774722-ent-typical		CHECKED -	REVISED -
		DATE -	REVISED -

SCALE: N/A	SHEET 2 OF 2 SHEETS	STA. TO STA.	F.A.I. RTE. 70	SECTION (18-45)RS-5	COUNTY CUMBERLAND	TOTAL SHEETS 65	SHEET NO. 9	
							CONTRACT NO. 74722	
ILLINOIS FED. AID PROJECT								

# SCHEDULE OF QUANTITIES

## PIPE UNDERDRAINS (MAINLINE)

	STATION	TO	STATION	MAINLINE SHOULDER REMOVAL AND REPLACEMENT 60100070 (FEET)	PIPE UNDERDRAINS, TYPE 2, 6" 60108206	
					LANE (FOOT)	LANE (FOOT)
EB	2771+40.00		2772+59.71	238.8	119.4	119.4
EB	9+02.89		15+50.00	1,303.9	653.2	650.7
EB	15+50.00		20+50.00	1,008.2	505.1	503.1
EB	20+50.00		25+50.00	1,008.2	505.1	503.1
EB	25+50.00		29+00.00	705.7	353.7	352.0
EB	29+00.00		37+00.00	1,613.1	808.5	804.6
EB	37+00.00		42+00.00	1,008.2	505.1	503.1
EB	42+00.00		47+00.00	1,001.0	500.6	500.4
EB	47+00.00		52+00.00	1,000.0	500.0	500.0
EB	52+00.00		57+00.00	1,000.0	500.0	500.0
EB	57+00.00		64+00.00	1,400.0	700.0	700.0
EB	64+00.00		68+00.00	800.0	400.0	400.0
EB	68+00.00		77+00.00	1,800.0	900.0	900.0
EB	77+00.00		82+50.00	1,097.3	548.3	549.0
EB	82+50.00		88+00.00	1,090.9	544.3	546.6
EB	88+00.00		93+00.00	991.8	494.7	497.1
EB	93+00.00		97+80.00	952.1	474.9	477.2
EB	97+80.00		102+80.00	999.2	499.5	499.7
EB	102+80.00		107+80.00	1,000.0	500.0	500.0
EB	107+80.00		114+15.00	1,270.0	635.0	635.0
EB	114+15.00		118+75.00	920.0	460.0	460.0
EB	118+75.00		123+75.00	1,000.0	500.0	500.0
EB	123+75.00		128+75.00	1,000.0	500.0	500.0
EB	128+75.00		133+75.00	1,000.0	500.0	500.0
EB	133+75.00		138+75.00	1,000.0	500.0	500.0
EB	138+75.00		148+75.00	2,000.0	1,000.0	1,000.0
EB	148+75.00		153+75.00	1,000.0	500.0	500.0
EB	153+75.00		158+88.00	1,026.0	513.0	513.0
EB	158+88.00		164+00.00	1,024.0	512.0	512.0
EB	164+00.00		168+50.00	900.0	450.0	450.0
EB	168+50.00		172+75.00	850.0	425.0	425.0
EB	172+75.00		180+75.00	1,600.0	800.0	800.0
EB	180+75.00		185+75.00	1,000.0	500.0	500.0
EB	185+75.00		190+75.00	1,000.0	500.0	500.0
EB	190+75.00		195+75.00	999.7	499.8	499.9
EB	195+75.00		200+75.00	997.3	498.3	499.0
EB	200+75.00		206+20.00	1,087.4	543.4	544.0
EB	206+20.00		210+00.00	760.0	380.0	380.0
EB	210+00.00		214+65.00	930.0	465.0	465.0
EB	214+65.00		217+65.00	600.0	300.0	300.0

	STATION	TO	STATION	MAINLINE SHOULDER REMOVAL AND REPLACEMENT 60100070 (FEET)	PIPE UNDERDRAINS, TYPE 2, 6" 60108206	
					LANE (FOOT)	LANE (FOOT)
EB	217+65.00		225+65.00	1,600.0	800.0	800.0
EB	225+65.00		230+65.00	1,000.0	500.0	500.0
EB	230+65.00		235+65.00	1,000.0	500.0	500.0
EB	235+65.00		240+65.00	1,000.0	500.0	500.0
EB	240+65.00		245+58.00	986.0	493.0	493.0
EB	245+58.00		250+02.50	889.0	437.0	452.0
EB	251+77.50		259+55.00	1,547.5	777.5	770.0
EB	261+20.00		266+65.00	1,090.0	545.0	545.0
EB	266+65.00		272+10.00	1,090.0	545.0	545.0
EB	272+10.00		277+60.00	1,100.0	550.0	550.0
EB	277+60.00		282+60.00	1,000.0	500.0	500.0
EB	282+60.00		288+10.00	1,100.0	550.0	550.0
EB	288+10.00		293+00.00	980.0	490.0	490.0
EB	293+00.00		297+00.00	800.0	400.0	400.0
EB	297+00.00		301+00.00	800.0	400.0	400.0
EB	301+00.00		305+10.00	820.0	410.0	410.0
EB	305+10.00		309+60.00	900.0	450.0	450.0
EB	309+60.00		313+80.00	840.0	420.0	420.0
EB	313+80.00		319+50.00	1,140.0	570.0	570.0
EB	319+50.00		324+50.00	1,000.0	500.0	500.0
EB	324+50.00		329+60.00	1,020.0	510.0	510.0
EB	329+60.00		334+00.00	880.0	440.0	440.0
EB	334+00.00		338+50.00	900.0	450.0	450.0
EB	338+50.00		343+00.00	900.0	450.0	450.0
EB	343+00.00		351+00.00	1,600.0	800.0	800.0
EB	351+00.00		355+00.00	800.0	400.0	400.0
EB	355+00.00		357+72.50	545.0	265.0	280.0
EB	360+32.50		364+50.00	842.1	426.3	415.8
EB	364+50.00		369+50.00	1,002.7	501.7	501.0
EB	369+50.00		374+50.00	1,002.7	501.7	501.0
EB	374+50.00		380+00.00	982.0	491.3	490.7
EB	380+00.00		384+50.00	900.0	450.0	450.0
EB	384+50.00		389+50.00	1,000.0	500.0	500.0
EB	389+50.00		394+50.00	1,000.0	500.0	500.0
EB	394+50.00		399+50.00	1,000.0	500.0	500.0
EB	399+50.00		410+00.00	2,100.0	1,050.0	1,050.0
EASTBOUND TOTAL				79,139.8	39,567.4	39,572.4
EASTBOUND ROUNDED				79,140.0	39,567.4	39,572.4

	STATION	TO	STATION	MAINLINE SHOULDER REMOVAL AND REPLACEMENT 60100070 (FEET)	PIPE UNDERDRAINS, TYPE 2, 6" 60108206	
					LANE (FOOT)	LANE (FOOT)
WB	108+45.00		114+15.00	1,140.0	570.0	570.0
WB	114+15.00		118+75.00	920.0	460.0	460.0
WB	118+75.00		123+75.00	1,000.0	500.0	500.0
WB	123+75.00		128+75.00	1,000.0	500.0	500.0
WB	128+75.00		133+75.00	1,000.0	500.0	500.0
WB	133+75.00		138+75.00	1,000.0	500.0	500.0
WB	138+75.00		148+75.00	2,000.0	1,000.0	1,000.0
WB	148+75.00		153+75.00	1,000.0	500.0	500.0
WB	153+75.00		158+88.00	1,026.0	513.0	513.0
WB	158+88.00		164+00.00	1,024.0	512.0	512.0
WB	164+00.00		168+50.00	900.0	450.0	450.0
WB	168+50.00		172+75.00	850.0	425.0	425.0
WB	172+75.00		180+75.00	1,600.0	800.0	800.0
WB	180+75.00		185+75.00	1,000.0	500.0	500.0
WB	185+75.00		190+75.00	1,000.0	500.0	500.0
WB	190+75.00		195+75.00	1,000.3	500.2	500.1
WB	195+75.00		200+75.00	1,002.7	501.7	501.0
WB	200+75.00		206+20.00	1,092.6	546.6	546.0
WB	206+20.00		210+00.00	730.0	350.0	380.0
WB	210+00.00		214+65.00	930.0	465.0	465.0
WB	214+65.00		217+65.00	600.0	300.0	300.0
WB	217+65.00		225+65.00	1,600.0	800.0	800.0
WB	225+65.00		230+65.00	1,000.0	500.0	500.0
WB	230+65.00		235+65.00	1,000.0	500.0	500.0
WB	235+65.00		240+65.00	1,000.0	500.0	500.0
WB	240+65.00		245+58.00	986.0	493.0	493.0
WB	245+58.00		250+40.00	964.0	487.0	477.0
WB	252+15.00		259+55.00	1,480.0	740.0	740.0
WB	262+20.00		266+65.00	890.0	445.0	445.0
WB	266+65.00		272+10.00	1,090.0	545.0	545.0
WB	272+10.00		277+60.00	1,100.0	550.0	550.0
WB	277+60.00		282+60.00	1,000.0	500.0	500.0
WB	282+60.00		288+10.00	1,100.0	550.0	550.0
WB	288+10.00		293+00.00	980.0	490.0	490.0
WB	293+00.00		297+00.00	800.0	400.0	400.0
WB	297+00.00		301+00.00	800.0	400.0	400.0
WB	301+00.00		305+10.00	820.0	410.0	410.0
WB	305+10.00		309+60.00	900.0	450.0	450.0
WB	309+60.00		313+80.00	840.0	420.0	420.0
WB	313+80.00		319+50.00	1,140.0	570.0	570.0
WB	319+50.00		324+50.00	1,000.0	500.0	500.0
WB	324+50.00		329+60.00	1,020.0	510.0	510.0
WB	329+60.00		334+00.00	880.0	440.0	440.0
WB	334+00.00		338+50.00	900.0	450.0	450.0
WB	338+50.00		343+00.00	900.0	450.0	450.0
WB	343+00.00		351+00.00	1,600.0	800.0	800.0
WB	351+00.00		355+00.00	800.0	400.0	400.0
WB	355+00.00		357+72.50	635.0	325.0	310.0
WB	360+72.50		364+50.00	752.9	368.7	384.2
WB	364+50.00		369+50.00	998.3	498.3	500.0
WB	369+50.00		374+50.00	998.3	498.3	500.0
WB	374+50.00		380+00.00	987.0	488.7	498.3
WB	380+00.00		384+50.00	900.0	450.0	450.0
WB	384+50.00		389+50.00	1,000.0	500.0	500.0
WB	389+50.00		394+50.00	1,000.0	500.0	500.0
WB	394+50.00		399+50.00	1,000.0	500.0	500.0
WB	399+50.00		407+75.00	1,650.0	825.0	825.0
WESTBOUND TOTAL				58,327.1	29,147.5	29,179.6
WESTBOUND ROUNDED				58,330.0	29,147.5	29,179.6

REV. 10-27-2016



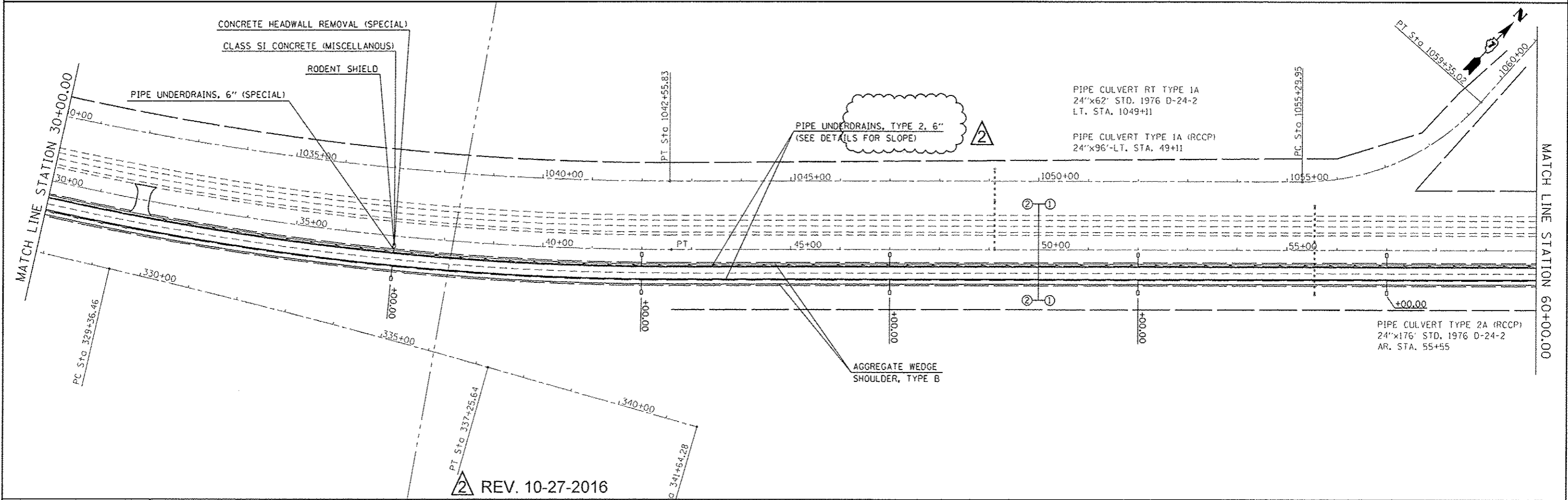
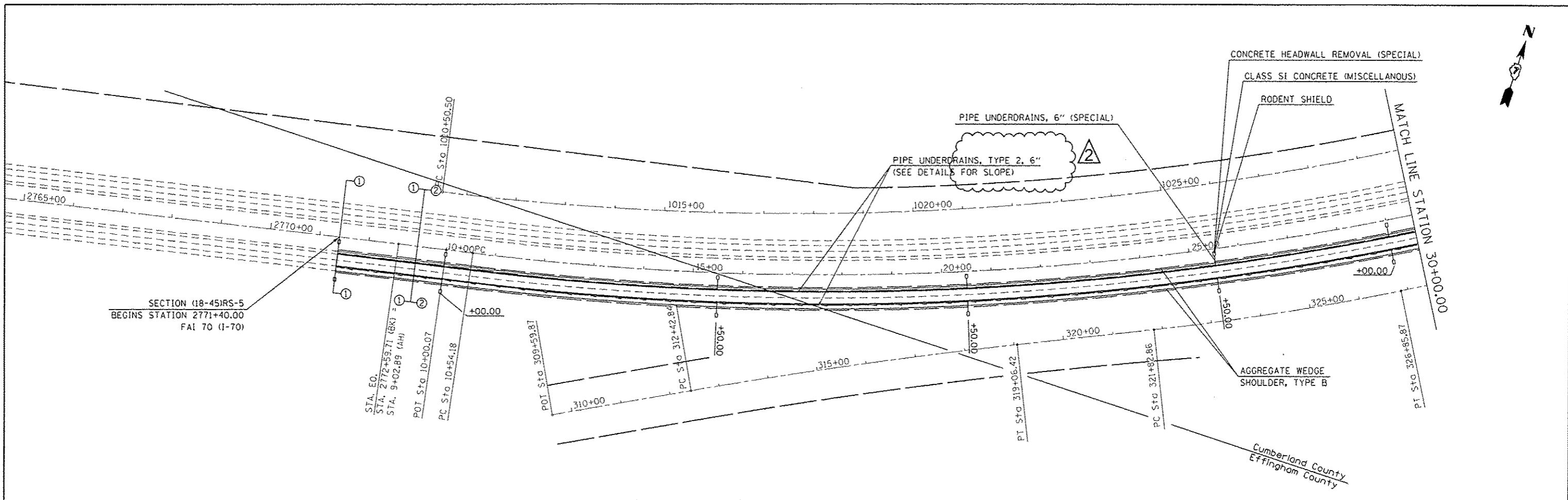

REV. 10-27-2016

FILE NAME :	USER NAME : xstaffmk	DESIGNED :	REVISOR :	<b>STATE OF ILLINOIS DEPARTMENT OF TRANSPORTATION</b>	<b>F.A.I. 70 PLAN SHEET</b>	F.A.I. RTE.:	SECTION:	COUNTY:	TOTAL SHEETS:	SHEET NO.:
p:\1\084EB10\ITC\Illinois.gov\PIWIDOT\Documents\1007 Offices\District 7\Projects\747		CHECKED :	REVISOR :			70	(18-45)RS-5	CUMBERLAND	65	33
PLOT SCALE = 200,0000 1/ in.		DATE :	REVISOR :			SCALE: SHEET NO. 1 OF 7 SHEETS STA. 2771+40.00 TO STA. 60+00.00		CONTRACT NO. 74722		
PLOT DATE = 10/26/2016						ILLINOIS FED. AID PROJECT				







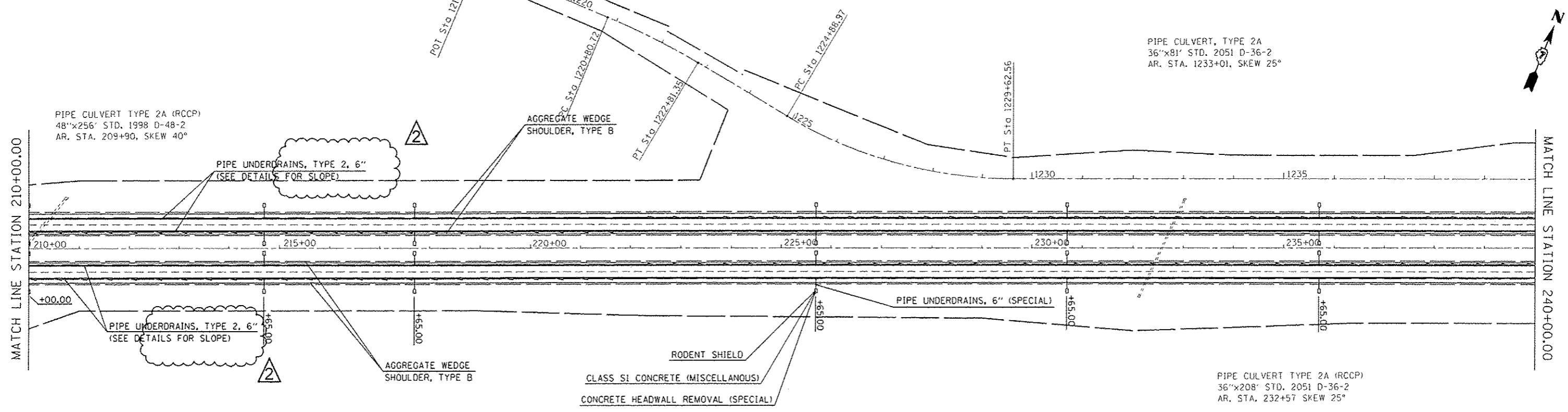
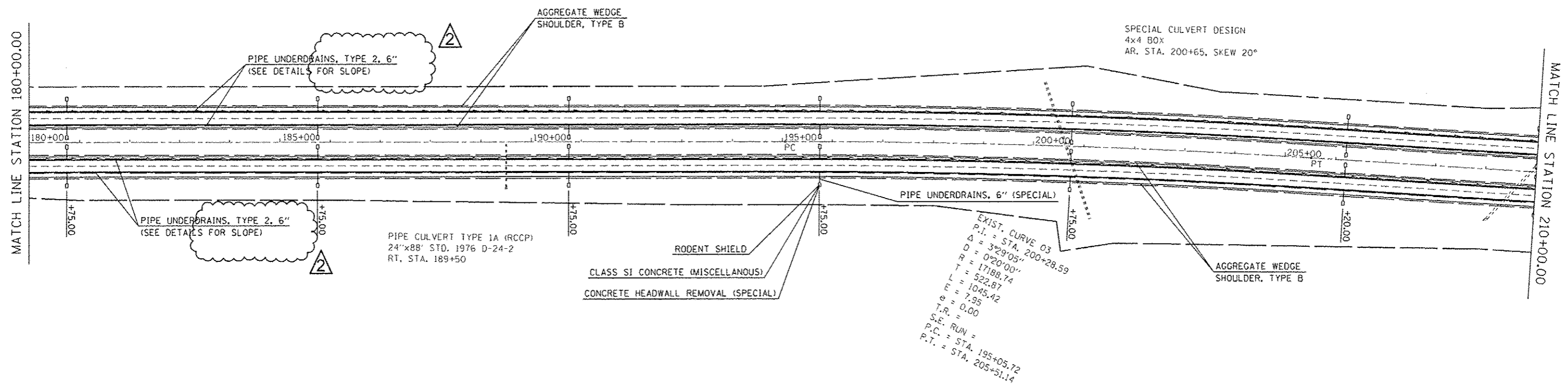

REV. 10-27-2016

FILE NAME =	USER NAME = steffennk	DESIGNED -	REVISD -	<b>STATE OF ILLINOIS DEPARTMENT OF TRANSPORTATION</b>	<b>F.A.I. 70 PLAN SHEET</b>	F.A.I. RTE.	SECTION	COUNTY	TOTAL SHEETS	SHEET NO.	
pw\1184684E\BID\INTEG\Illinois.gov\PIWID\Documents\DDOT Offices\District 7\Projects\7472\Drawings\7472-180-240-Plan.dwg		DRAWN TO SCALE SHEETS 0774722-shd-plan.dwg	REVISD -			70	(18-45)RS-5	CUMBERLAND	65	36	
PLOT SCALE = 200.0000 1/16" = 1'		CHECKED -	REVISD -			CONTRACT NO. 74722					
PLOT DATE = 10/26/2016		DATE -	REVISD -			ILLINOIS FED. AID PROJECT					

SCALE: SHEET NO. 4 OF 7 SHEETS STA. 180+00.00 TO STA. 240+00.00

MATCH LINE STATION 240+00.00

MATCH LINE STATION 270+00.00

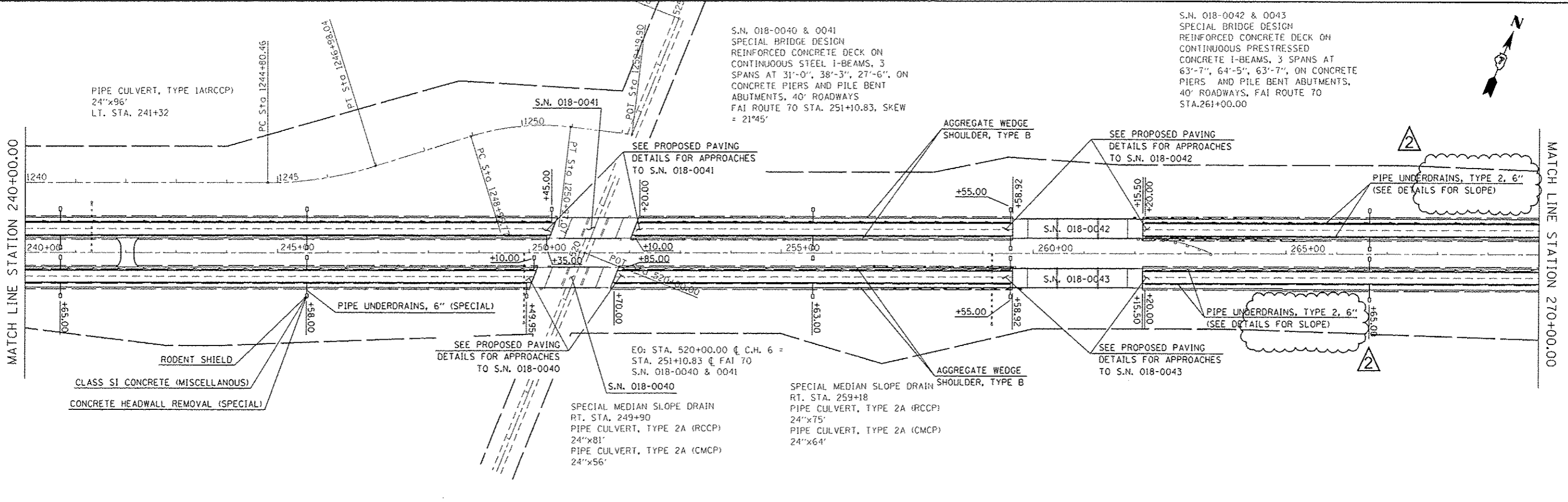

MATCH LINE STATION 270+00.00

MATCH LINE STATION 300+00.00

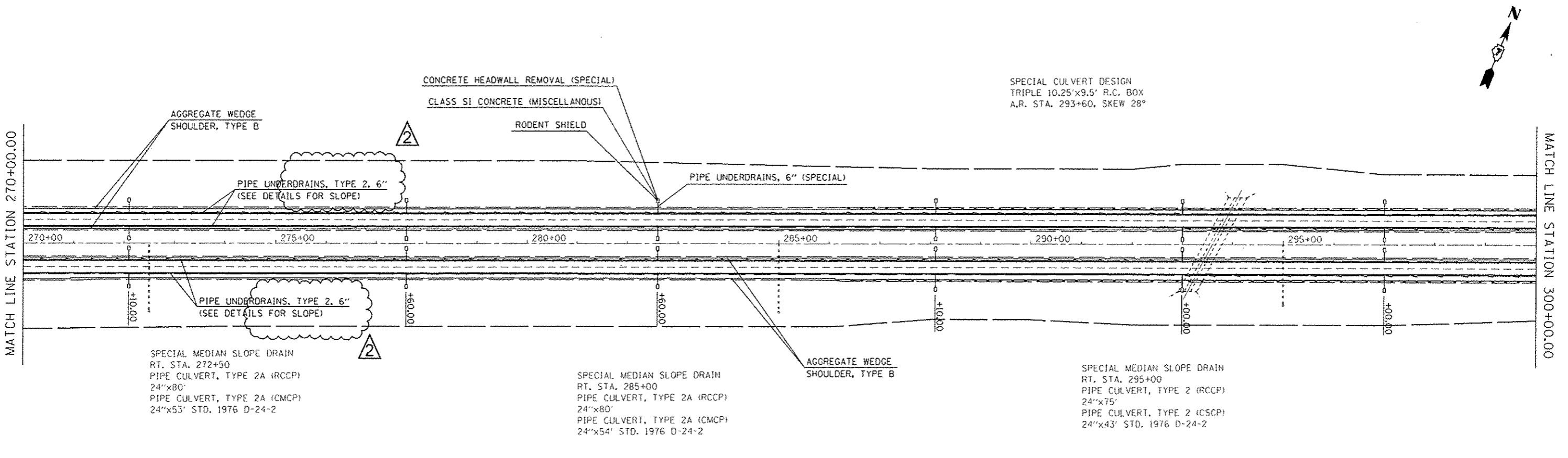

2 REV. 10-27-2016

FILE NAME :	USER NAME :	DESIGNED :	REVISED :
g:\1\08\EBID\INTEG.1\1nsis.gov\PI007\Documents\1001\Office\District 7\Projects\7472\Drawings\CAB\Sheets\0774722-sht-plan.dwg	staffennh		
PLOT SCALE :	CHECKED :	DATE :	REVISED :
200.0000' / 1"			
PLOT DATE :			
10/26/2016			

STATE OF ILLINOIS  
DEPARTMENT OF TRANSPORTATION

F.A.I. 70 PLAN SHEET

SCALE: SHEET NO. 5 OF 7 SHEETS STA. 240+00.00 TO STA. 300+00.00

F.A.I. RTE.	SECTION	COUNTY	TOTAL SHEETS	SHEET NO.
70	(18-45)RS-5	CUMBERLAND	65	37
				CONTRACT NO. 74722
ILLINOIS FED. AID PROJECT				

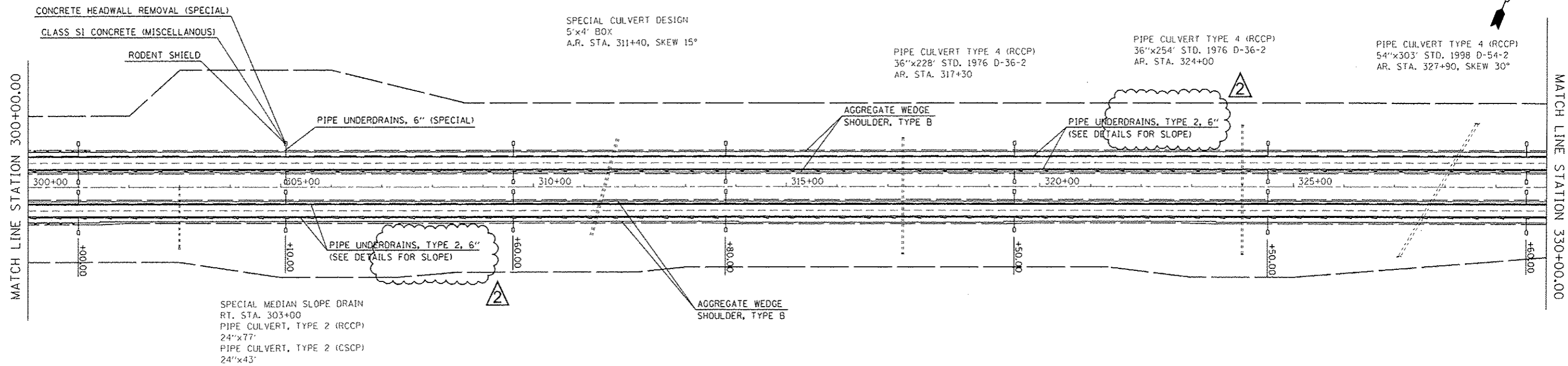

EXISTING HOT-MIX ASPHALT CORING DETAILS NEAR S.N. 018-0036

LOCATION	STATION	HMA DEPTH
EBPL	349+88	6 3/8"
EBPL	350+88	6 1/2"
EBPL	351+88	6 1/2"
EBPL	352+88	6 1/2"
EBPL	353+88	6 1/2"
EBPL	356+60	6 7/8"
WBPL	351+72	6 1/2"

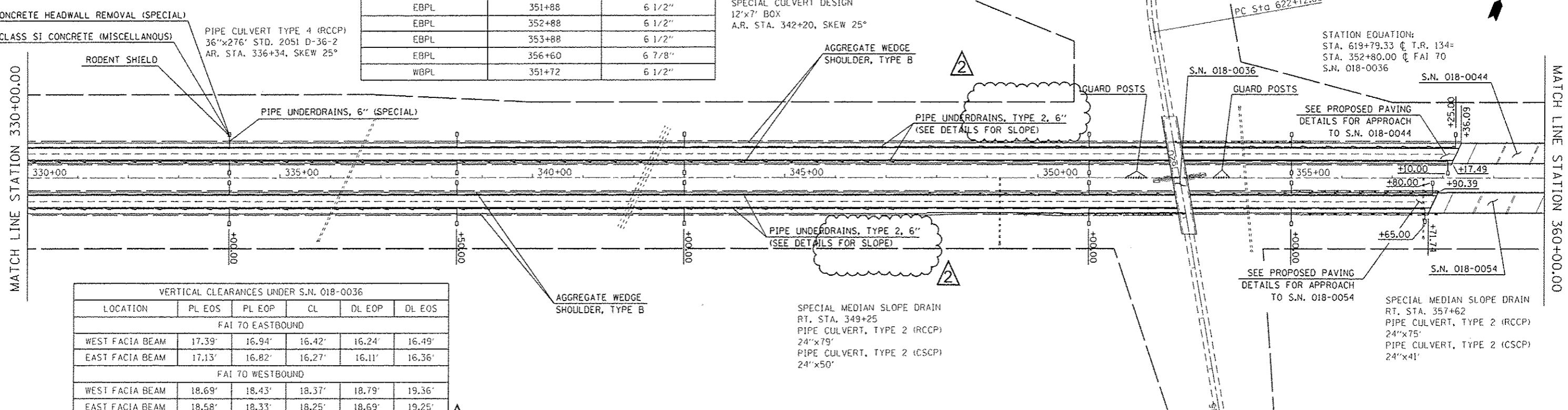

VERTICAL CLEARANCES UNDER S.N. 018-0036

LOCATION	PL EOS	PL EOP	CL	DL EOP	DL EOS
FAI 70 EASTBOUND					
WEST FACIA BEAM	17.39'	16.94'	16.42'	16.24'	16.49'
EAST FACIA BEAM	17.13'	16.82'	16.27'	16.11'	16.36'
FAI 70 WESTBOUND					
WEST FACIA BEAM	18.69'	18.43'	18.37'	18.79'	19.36'
EAST FACIA BEAM	18.58'	18.33'	18.25'	18.69'	19.25'

REV. 10-27-2016

S.N. 018-0044 & 0054  
 SPECIAL BRIDGE DESIGN  
 REINFORCED CONCRETE DECK ON  
 CONTINUOUS STEEL I-BEAMS, 3  
 SPANS AT 55'-6 1/2", 65'-0", 55'-6 1/2", ON  
 CONCRETE PIERS AND PILE BENT  
 ABUTMENTS, 40' ROADWAYS  
 FAI ROUTE 70 STA. 359+25.00, SKEW  
 = 25°

PIPE CULVERT, TYPE 2(RCCP)  
 24"x109" STD. 1976 D-24-2  
 LT. STA. 382+00

PIPE CULVERT, TYPE 3(RCCP)  
 36"x236" STD. 2051 D-36-2  
 AR. STA. 373+84, SKEW 25°

MATCH LINE STATION 360+00.00

MATCH LINE STATION 390+00.00

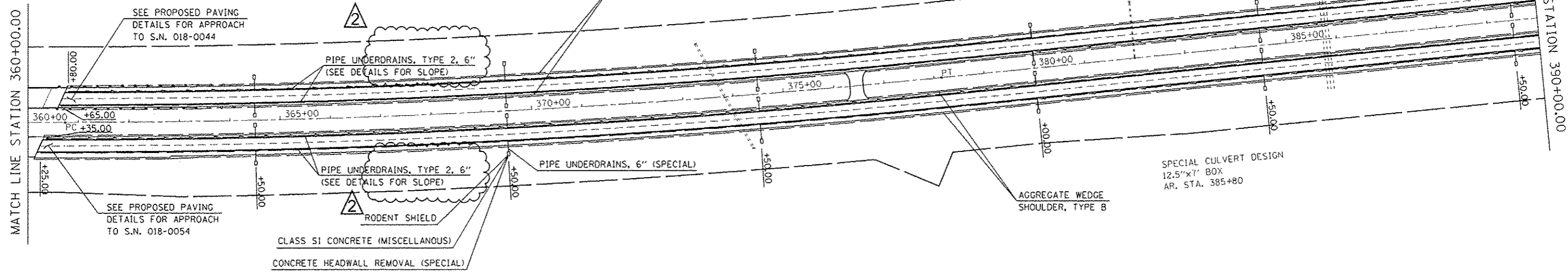

VERTICAL CLEARANCES UNDER S.N. 018-0017					
LOCATION	PL EOS	PL EOP	CL	DL EOP	DL EOS
FAI 70 EASTBOUND					
WEST FACIA BEAM	17.39'	17.08'	16.66'	16.64'	17.03'
EAST FACIA BEAM	16.89'	16.54'	16.10'	16.08'	16.45'
FAI 70 WESTBOUND					
WEST FACIA BEAM	18.16'	17.73'	17.55'	17.91'	18.44'
EAST FACIA BEAM	17.56'	17.26'	17.22'	17.41'	17.95'

PIPE CULVERT, TYPE 3(RCCP)  
 24"x117" STD. 1976 D-24-2  
 LT. STA. 396+00

PIPE CULVERT, TYPE 1(RCCP)  
 24"x88"  
 LT. STA. 409+30

PIPE CULVERT, TYPE 2(RCCP)  
 36"x181" STD. 2051 D-36-2  
 AR. STA. 417+60, SKEW 10°

MATCH LINE STATION 390+00.00

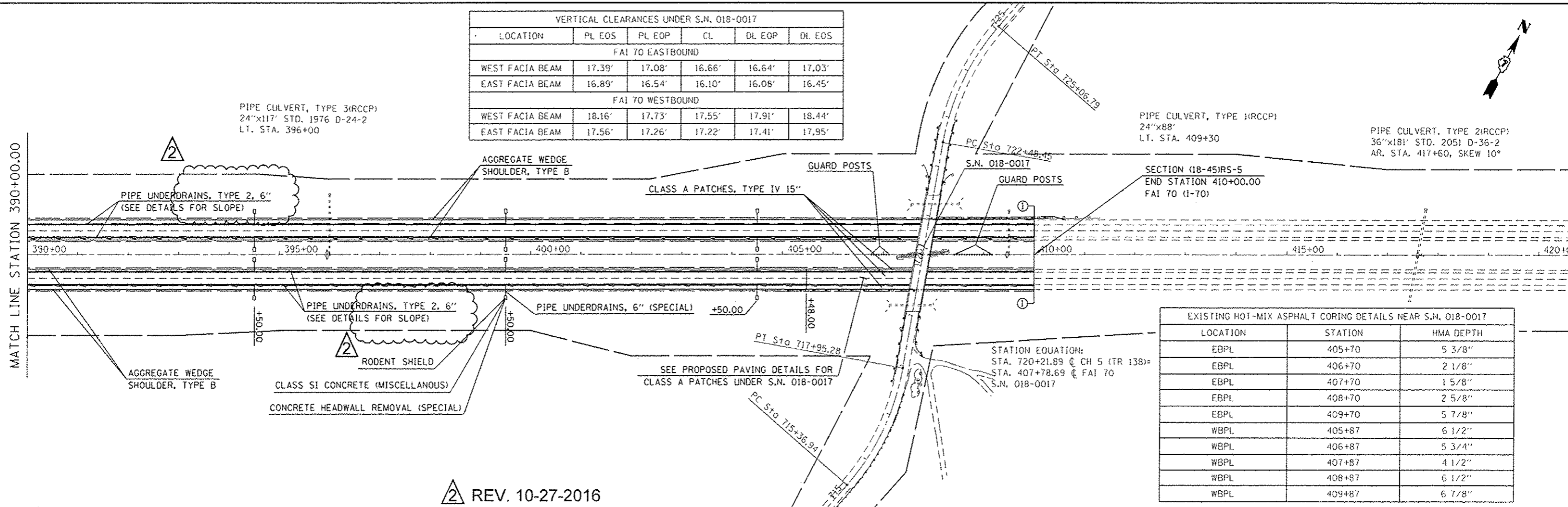

EXISTING HOT-MIX ASPHALT CORING DETAILS NEAR S.N. 018-0017		
LOCATION	STATION	HMA DEPTH
EBPL	405+70	5 3/8"
EBPL	406+70	2 1/8"
EBPL	407+70	1 5/8"
EBPL	408+70	2 5/8"
EBPL	409+70	5 7/8"
WBPL	405+87	6 1/2"
WBPL	406+87	5 3/4"
WBPL	407+87	4 1/2"
WBPL	408+87	6 1/2"
WBPL	409+87	6 7/8"

REV. 10-27-2016

STATE OF ILLINOIS  
 DEPARTMENT OF TRANSPORTATION

F.A.I. 70 PLAN SHEET

FILE NAME =	USER NAME = steffens	DESIGNED -	REVISED -
PROJECT =	PROJECT =	CHECKED -	REVISED -
DATE =	DATE =	CHECKED -	REVISED -

SCALE:	SHEET NO. 7 OF 7 SHEETS	STA. 360+00.00 TO STA. 410+00.00	F.A.I. RTE. 70	SECTION (18-45)RS-5	COUNTY CUMBERLAND	TOTAL SHEETS 65	SHEET NO. 39
							CONTRACT NO. 74722
ILLINOIS FED. AID PROJECT							

# SLOPE DETAILS FOR PIPE UNDERDRAINS, TYPE 2, 6"

2

DIRECTION	STATION	TO	STATION	PAVEMENT PROFILE GRADE LINE (%)	PROPOSED UNDERDRAIN SLOPE (%)
EB	2771+40.00		2772+59.71	+0.20	+0.40
EB	9+02.89		32+00.00	+0.20	+0.40
EB	32+00.00		64+00.00	-0.20	-0.40
EB	64+00.00		72+00.00	+0.20	+0.40
EB	72+00.00		114+15.00	-0.24	-0.40
EB	114+15.00		144+00.00	+0.28	+0.40
EB	144+00.00		164+00.00	-0.25	-0.40
EB	164+00.00		176+00.00	+0.15	+0.40
EB	176+00.00		210+00.00	-0.30	-0.40
EB	210+00.00		221+00.00	+0.30	+0.40
EB	221+00.00		250+09.37	-1.70	PGL
EB	251+71.28		256+00.00	-1.70	PGL
EB	256+00.00		259+58.92	-0.14	-0.40
EB	262+15.50		293+00.00	-0.14	-0.40
EB	293+00.00		349+00.00	+0.10	+0.40
EB	349+00.00		357+82.00	-0.15	-0.40
EB	360+23.50		380+00.00	-0.15	-0.40
EB	380+00.00		394+50.00	+0.19	+0.40
EB	394+50.00		410+00.00	+1.98	PGL

DIRECTION	STATION	TO	STATION	PAVEMENT PROFILE GRADE LINE (%)	PROPOSED UNDERDRAIN SLOPE (%)
WB	108+45.00		114+15.00	-0.24	-0.40
WB	114+15.00		144+00.00	+0.28	+0.40
WB	144+00.00		164+00.00	-0.25	-0.40
WB	164+00.00		176+00.00	+0.15	+0.40
WB	176+00.00		210+00.00	-0.30	-0.40
WB	210+00.00		221+00.00	+0.30	+0.40
WB	221+00.00		250+46.87	-1.70	PGL
WB	252+08.78		256+00.00	-1.70	PGL
WB	256+00.00		259+58.92	-0.14	-0.40
WB	262+15.50		293+00.00	-0.14	-0.40
WB	293+00.00		349+00.00	+0.10	+0.40
WB	349+00.00		358+25.83	-0.15	-0.40
WB	360+67.33		380+00.00	-0.15	-0.40
WB	380+00.00		394+50.00	+0.19	+0.40
WB	394+50.00		410+00.00	+1.98	PGL

## PIPE UNDERDRAIN DETAIL

(USE WHEN PGL IS LESS THAN 0.4%)

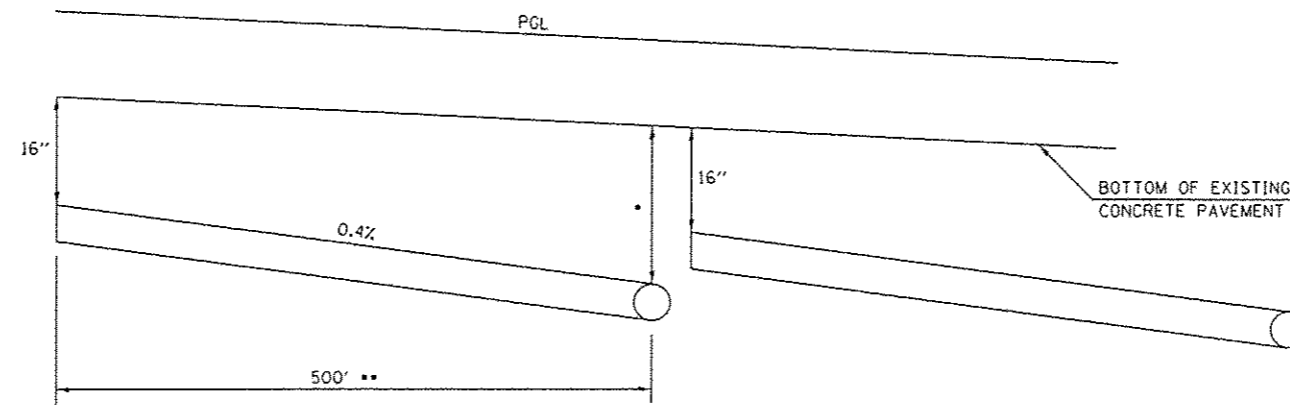

- DEPTH OF OUTLET DETERMINED BY SLOPE
- UNLESS OTHERWISE NOTED IN THE PLANS

2 REV. 10-27-2016

2

FILE NAME :	USER NAME : staffennk	DESIGNED :	REVISED :	<b>STATE OF ILLINOIS DEPARTMENT OF TRANSPORTATION</b>	<b>SLOPE DETAILS FOR PIPE UNDERDRAINS, TYPE 2, 6"</b>	F.A.I. RTE.	SECTION	COUNTY	TOTAL SHEETS	SHEET NO.	
						70	(18-45)RS-5	CUMBERLAND	65	5B	
						CONTRACT NO. 74722					
						ILLINOIS FED. AID PROJECT					
PLOT SCALE = 100.0000' / in.		CHECKED :		SCALE: NA		SHEET NO. 1 OF 1 SHEETS		STA. TO STA.			
PLOT DATE = 10/26/2016		DATE :									