

F.A. RTE.	SECTION	COUNTY	TOTAL SHEETS	SHEET NO.
VARIOUS	15-00275-00-SG	COOK	4	1
		ILLINOIS	CONTRACT NO. 61D19	

11-4-2016 LETTING ITEM 035

STATE OF ILLINOIS
DEPARTMENT OF TRANSPORTATION
DIVISION OF HIGHWAYS
PLANS FOR PROPOSED
FEDERAL AID HIGHWAY

VARIOUS ROUTES
RADAR SPEED SIGNS
SECTION 15-00275-00-SG
PROJECT SRTS-4009(341)
CITY OF EVANSTON
COOK COUNTY

C-91-029-16



LOCATION OF SECTION INDICATED THUS: — [shaded box] —

STATE OF ILLINOIS
DEPARTMENT OF TRANSPORTATION

APPROVED 8/3 2016
Lara Piggs
CITY ENGINEER
CITY OF EVANSTON

PASSED AUGUST 18 2016
Charles Holt
DISTRICT ENGINEER OF LOCAL ROADS AND STREETS

RELEASING FOR BID August 18 2016
John F. ...
REGIONAL ENGINEER

PRINTED BY THE AUTHORITY OF THE STATE OF ILLINOIS



FOR INDEX OF SHEETS, INDEX OF HIGHWAY STANDARDS, AND GENERAL NOTES, SEE SHEET 2

TRAFFIC DATA

ROAD NAME: VARIES, SEE SHEET 3
FUNCTIONAL CLASSIFICATION: MINOR ARTERIALS
POSTED SPEED LIMIT: VARIES, 25-35 MPH
ADT: VARIES

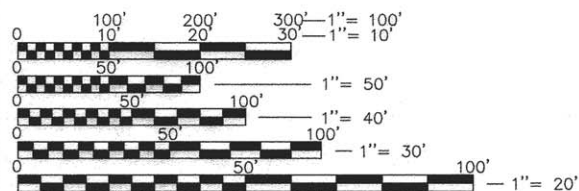

FULL SIZE PLANS HAVE BEEN PREPARED USING STANDARD ENGINEERING SCALES. REDUCED SIZED PLANS WILL NOT CONFORM TO STANDARD SCALES. IN MAKING MEASUREMENTS ON REDUCED PLANS, THE ABOVE SCALES MAY BE USED.

J.U.L.I.E. JOINT UTILITY LOCATION INFORMATION FOR EXCAVATION
1-800-892-0123
OR 811

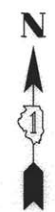
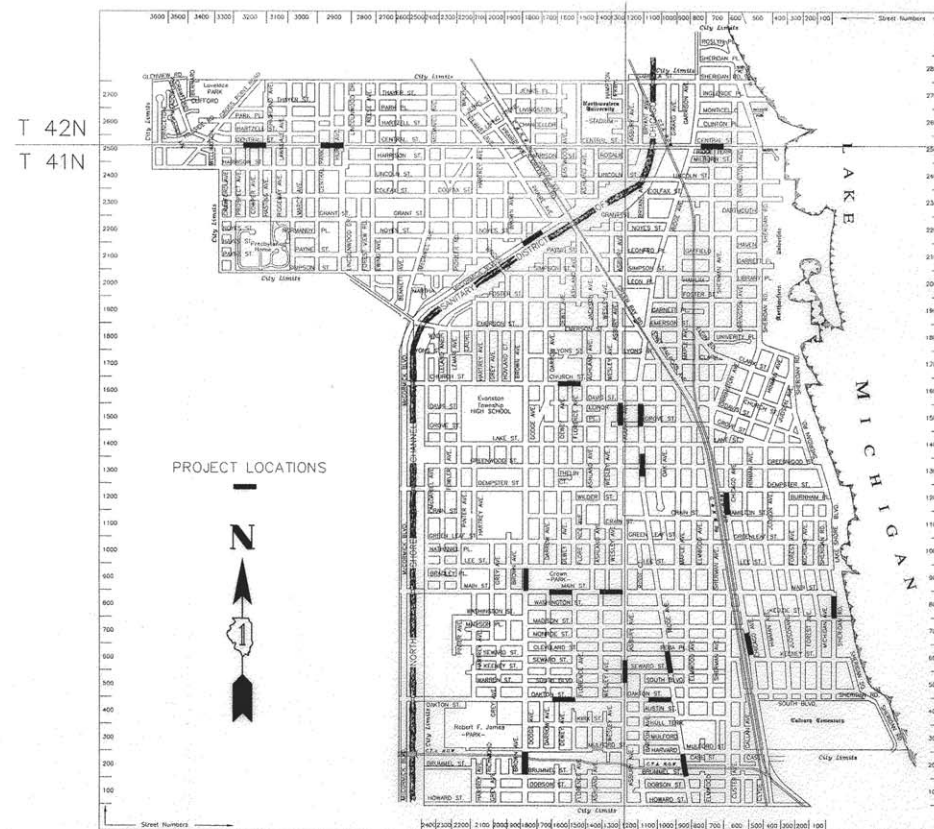

R 13E R 14E

N.T.S.

GROSS AND NET LENGTH: N/A

CONTRACT NO. 61D19

PROGRAM AND OFFICE ENGINEER: CHARLES F. RIDDLE, P.E. 847-705-4406 SCHLAUMBURG, IL

INDEX OF SHEETS	
1	TITLE SHEET
2	INDEX OF SHEETS, INDEX OF HIGHWAY STANDARDS, SUMMARY OF QUANTITIES, & GENERAL NOTES
3	LOCATION MAP
4	TYPICAL SECTION

INDEX OF HIGHWAY STANDARDS
701006-05
701101-05
701301-04
701427-04
701606-10
701901-05

SUMMARY OF QUANTITIES			
CODE NO.	ITEM	UNIT	TOTAL QUANTITY
67100100	MOBILIZATION	LSUM	1
70102625	TRAFFIC CONTROL AND PROTECTION, STANDARD 701606	LSUM	1
X1400145	RADAR SPEED SIGN	EACH	20

GENERAL NOTES

- ALL DIMENSIONS SHOWN ON THE PLANS ARE TO THE FACE OF CURB.
- ANY REFERENCE TO "STANDARDS" THROUGHOUT THE PLANS, SPECIFICATIONS OR SPECIAL PROVISIONS SHALL BE INTERPRETED TO THE LATEST STANDARDS OF THE ILLINOIS DEPARTMENT OF TRANSPORTATION.
- THE CONTRACTOR IS RESPONSIBLE FOR ALL CONSTRUCTION TRAFFIC CONTROL AND LANE CLOSURE. IF AT ANY TIME DURING THE PROJECT A DETOUR IS REQUIRED, THE CONTRACTOR SHALL SUBMIT DETOUR PLANS FOR APPROVAL BY THE CITY. THIS WORK WILL NOT BE PAID FOR SEPARATELY BUT SHALL BE INCLUDED IN THE UNIT PRICE OF TRAFFIC CONTROL AND PROTECTION, PAY ITEM.
- ALL ITEMS WITHIN THE EXISTING STREET SCAPE WHICH ARE DAMAGED OR DISTURBED AS A RESULT OF THIS WORK SHALL BE REPLACED TO EQUAL OR BETTER QUALITY AT THE CONTRACTOR'S EXPENSE.
- CONSTRUCTION ACTIVITIES MAY OCCUR BETWEEN 7:00AM AND 5:00PM MONDAY THROUGH FRIDAY AND 8:00AM TO 4:00PM ON SATURDAYS (AS APPROVED BY THE ENGINEER). CONSTRUCTION ACTIVITIES ON SUNDAY ARE PROHIBITED. NO WORK WILL BE PERFORMED ON STATE OF ILLINOIS OBSERVED HOLIDAYS. CONSTRUCTION ACTIVITIES ARE IDENTIFIED AS THE OPERATION OF HEAVY EQUIPMENT, INCLUDING BUT NOT LIMITED TO THE WARMING UP OF ANY PIECE OF EQUIPMENT OR TURNING ON ENGINES. CONSTRUCTION ACTIVITIES SHALL NOT BEGIN BEFORE 7:00AM.
- THE CONTRACTOR SHALL NOT COMPLETELY CLOSE A ROAD AT ANY GIVEN TIME.
- THE CONTRACTOR SHALL PROVIDE ACCESS TO ABUTTING PROPERTY AT ALL TIMES DURING THE CONSTRUCTION OF THIS PROJECT, EXCEPT FOR PERIODS OF SHORT INTERRUPTION. THE CONTRACTOR SHALL NOTIFY THE PROPERTY OWNER NO LESS THAN 48 HOURS IN ADVANCE OF THE INTERRUPTION OF ACCESS AND /OR SERVICES AND SHALL NOTIFY THE OWNER OF THE TIME AND DURATION OF THE INTERRUPTION.
- THE STORAGE OF EQUIPMENT AND/OR MATERIALS WITHIN THE PARKWAYS SHALL REQUIRE PRIOR APPROVAL OF THE ENGINEER.

PLANS PREPARED BY:



CITY OF EVANSTON
PUBLIC WORKS DEPARTMENT
DIVISION OF TRANSPORTATION
PHONE: (847) 866-2940

DESIGNED -- BN	REVISED -- 07/12/2016
DRAWN -- BN	REVISED --
CHECKED -- RD, DM	REVISED --
DATE -- 06/08/2016	REVISED --

STATE OF ILLINOIS
DEPARTMENT OF TRANSPORTATION

INDEX OF SHEETS, INDEX OF HIGHWAY STANDARDS,
SUMMARY OF QUANTITIES, & GENERAL NOTES

SCALE: AS NOTED SHEET OF SHEETS STA. TO STA.

F.A. RTE.	SECTION	COUNTY	TOTAL SHEETS	SHEET NO.
VARIOUS	15-00275-00-SG	COOK	4	2
CONTRACT NO.			61D19	
ILLINOIS FED. AID PROJECT				

RADAR SPEED SIGNS PROPOSED LOCATIONS

Sign No.	Install Street	Address	Side Of Street	School Crossings	Jurisdiction
1	Asbury Avenue	Kamen Park	East	Chute, St. Nicholas	Evanston
2	Asbury Avenue	1574 Asbury Ave	West	Dewey, Roycemore	Evanston
3	Central Street	736 Central St	South	Orrington	Evanston
4	Central Street	2935 Central St	North	Willard, Lincolnwood	Evanston
5	Central Street	Bent Park	South	Willard	Evanston
6	Chicago Avenue	1236 Chicago Ave	West	Nichols, Chiaravalle	Evanston
7	Chicago Avenue	635 Chicago Ave	East	Lincoln	Evanston
8	Church Street	Mason Park	South	Dewey	Evanston
9	Dodge Avenue	920 Dodge Ave	West	Washington	Evanston
10	Dodge Avenue	221 Dodge Ave	East	Dawes	Evanston
11	Main Street	1319 Main St	North	Washington	Evanston
12	Main Street	1700 Main St	South	Washington	Evanston
13	McCormick Blvd	Arboretum	South	Kingsley, Haven	Evanston
14	Oakton Street	Chute Grnds	South	Dawes, Chute	Evanston
15	Oakton Street	1031 Oakton St	North	Oakton, Chute	Evanston
16	Ridge Avenue	Alexander Park	West	Dewey, Roycemore	Evanston
17	Ridge Avenue	209 Ridge Ave	East	Oakton	Evanston
18	Ridge Avenue	622 Ridge Ave	West	Oakton, Chute	Evanston
19	Ridge Avenue	1400 Ridge Ave	East	Dewey, Roycemore	Evanston
20	Sheridan Road	Clark Square Park	West	Lincoln	Evanston

TRAFFIC CONTROL FOR SIGN NOS. 16, 17, 18, AND 19 WILL BE INCLUDED IN THE LUMP SUM PRICE FOR "TRAFFIC CONTROL AND PROTECTION, STANDARD 701606." TRAFFIC CONTROL FOR THE INSTALLATION OF ALL OTHER SIGNS WILL BE PERFORMED IN ACCORDANCE WITH HIGHWAY STANDARD 701301-04 AND WILL NOT BE MEASURED FOR PAYMENT, BUT WILL BE INCLUDED IN THE TOTAL COST FOR THE PROJECT.

T 42N
T 41N

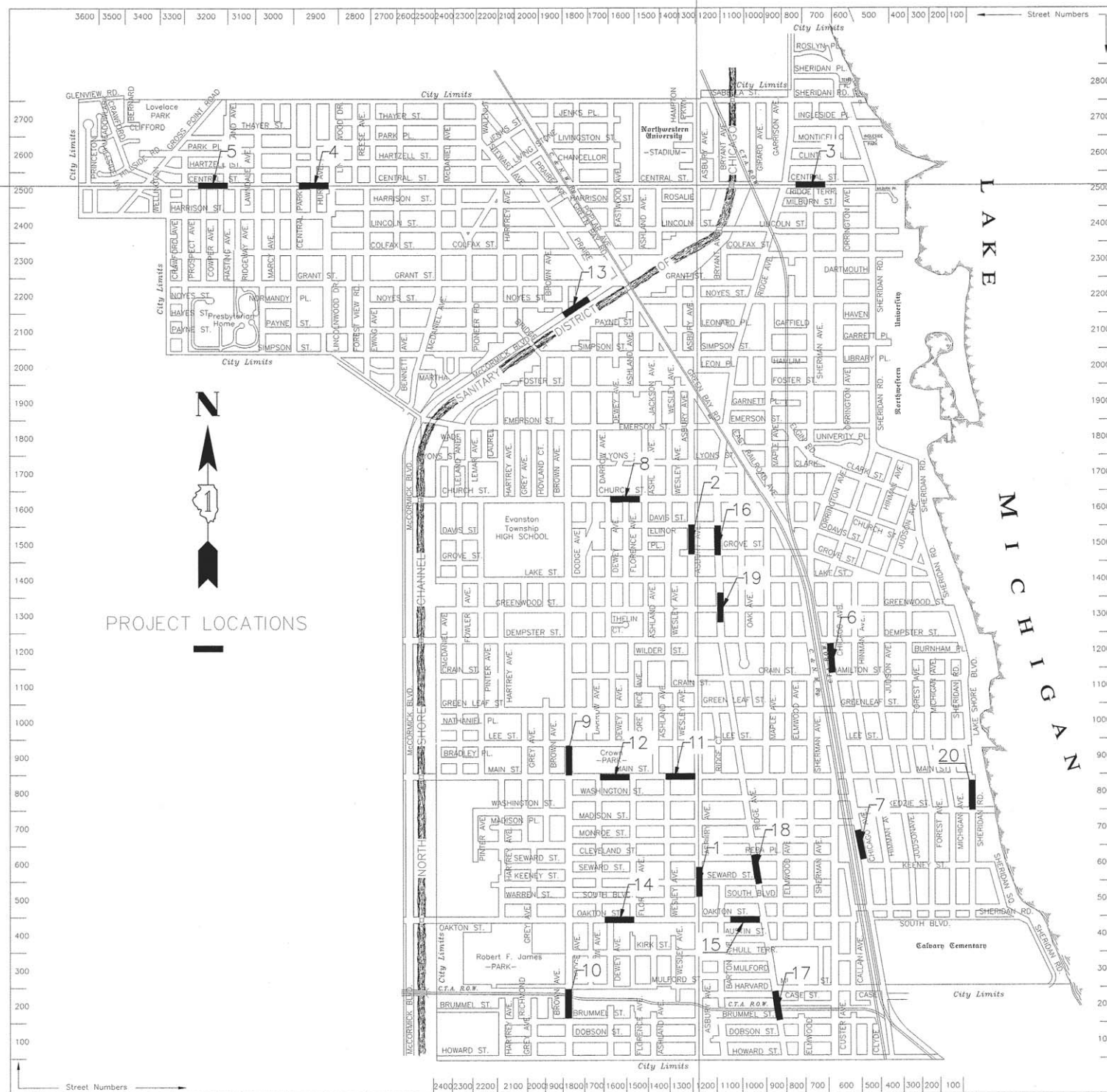

R 13E R 14E

N.T.S.

PLANS PREPARED BY:



CITY OF EVANSTON
PUBLIC WORKS DEPARTMENT
DIVISION OF TRANSPORTATION
PHONE: (847) 866-2940

DESIGNED -- BN
DRAWN -- BN
CHECKED -- RD, DM
DATE -- 06/08/2016

REVISED -- 07/12/2016
REVISED --
REVISED --
REVISED --

STATE OF ILLINOIS
DEPARTMENT OF TRANSPORTATION

LOCATION MAP

SCALE: AS NOTED SHEET OF SHEETS STA. TO STA.

F.A. RTE.	SECTION	COUNTY	TOTAL SHEETS	SHEET NO.
VARIOUS	15-00275-00-SG	COOK	4	3
CONTRACT NO. 61D19			ILLINOIS FED. AID PROJECT	

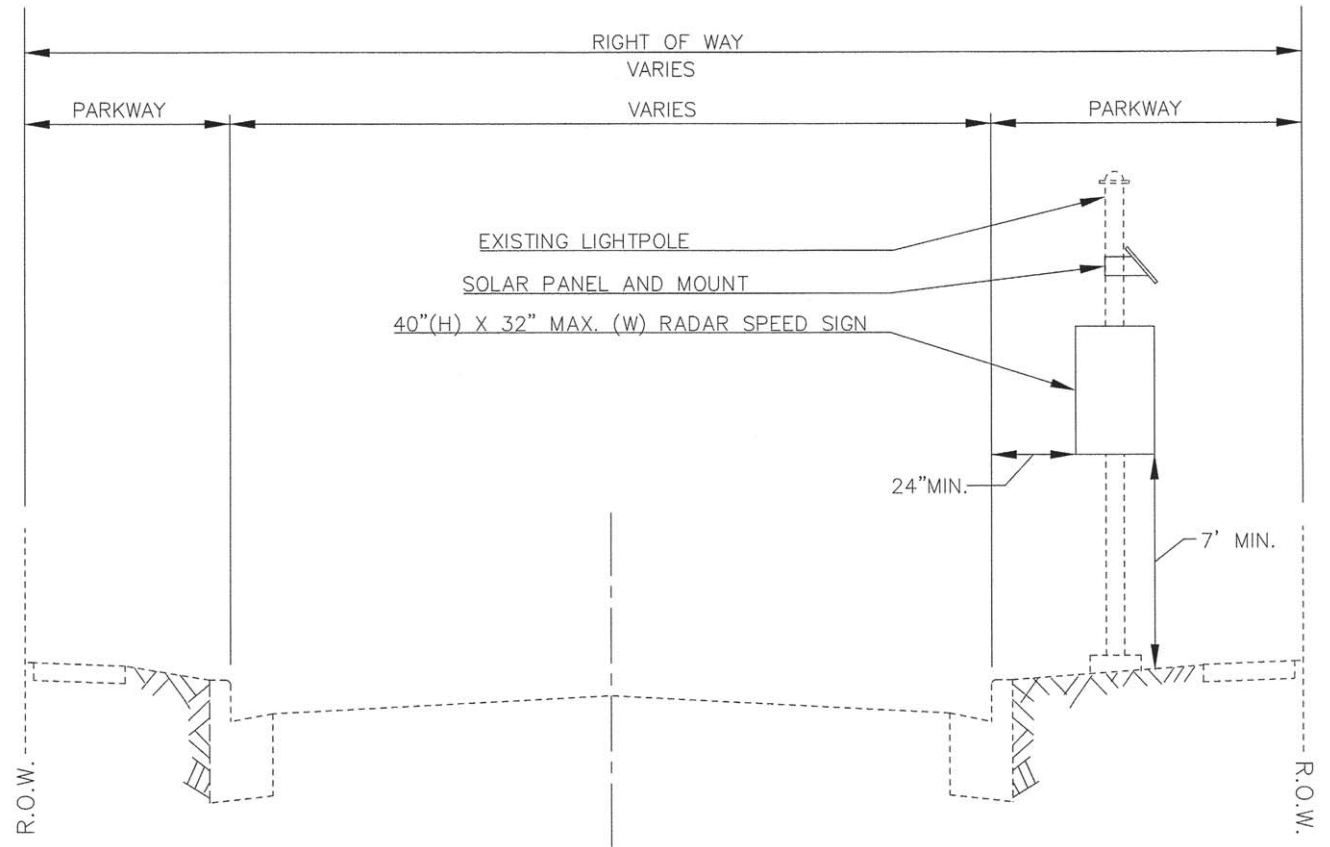

TYPICAL SECTION
N.T.S.

PLANS PREPARED BY:



CITY OF EVANSTON
PUBLIC WORKS DEPARTMENT
DIVISION OF TRANSPORTATION
PHONE: (847) 866-2940

DESIGNED — BN	REVISED — 07/12/2016
DRAWN — BN	REVISED —
CHECKED — RD, DM	REVISED —
DATE — 06/08/2016	REVISED —

STATE OF ILLINOIS
DEPARTMENT OF TRANSPORTATION

TYPICAL SECTION

SCALE: AS NOTED SHEET OF SHEETS STA. TO STA.

F.A. RTE.	SECTION	COUNTY	TOTAL SHEETS	SHEET NO.
VARIOUS	15-00275-00-SG	COOK	4	4
CONTRACT NO.			61D19	
ILLINOIS FED. AID PROJECT				