

INDEX OF SHEETS

- 1. COVER SHEET
- 2. GENERAL NOTES
- 3. SUMMARY OF QUANTITIES
- 4 - 5. TYPICAL SECTIONS
- 6. SCHEDULES
- 7 - 14. OVERHEAD SIGN TRUSS - SPAN
- 15 - 23. OVERHEAD SIGN TRUSS - CANTILEVER
- 24 - 25. SOIL BORING LOGS

STANDARDS

- 000001-05 STANDARD SYMBOLS, ABBREVIATIONS AND PATTERNS
- 001001-02 AREAS OF REINFORCEMENT BARS
- 001006 DECIMAL OF AN INCH AND OF A FOOT
- 701101-02 OFF-ROAD OPERATIONS MULTILANE, 15' (4.5 m) TO 24" (600 mm) FROM PAVEMENT EDGE
- 701106-02 OFF-ROAD OPERATIONS, MULTILANE, MORE THAN 15' (4.5 m) AWAY
- 701411-06 LANE CLOSURE, MULTILANE, AT ENTRANCE OR EXIT RAMP FOR SPEEDS ≥ 45 MPH
- 701901-01 TRAFFIC CONTROL DEVICES

**STATE OF ILLINOIS
DEPARTMENT OF TRANSPORTATION
DIVISION OF HIGHWAYS**

**PROPOSED
HIGHWAY PLANS**

**VARIOUS ROUTES
SECTION D-3 OVD SIN STR REPL 2011-08**

**OVERHEAD SIGN STRUCTURE REHABILITATION OR REPLACEMENT
LASALLE, GRUNDY, IROQUOIS COUNTIES**

C-60-008-11

F.A.I. RTE.	SECTION	COUNTY	TOTAL SHEETS	SHEET NO.
VAR D-3 OVD SIN STR REPL 2011-08		ILLINOIS	25	1
CONTRACT NO. 46131				

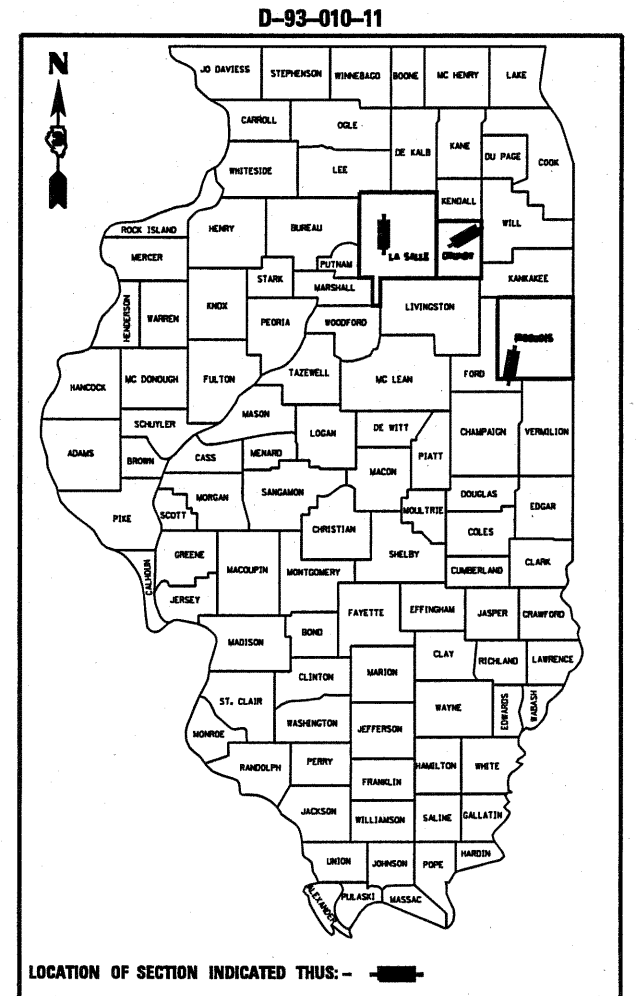

LOCATION 1 - FAI ROUTE 39
OVERHEAD SIGN STRUCTURE
S.N. #3S05010391061.2
(STA. 1158+78 SBL)
1.5 MI. NORTH OF I-80 INTERCHANGE

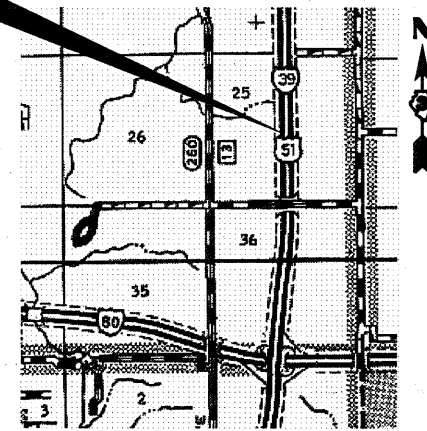

LASALLE COUNTY

LOCATION 5 - FAI ROUTE 57
OVERHEAD SIGN STRUCTURE - CANTILEVER
S.N. #3C03810571269.3
ENTRANCE TO SB MAINLINE REST AREA
(EXISTING STA. 1374+70 SBL)
(PROPOSED STA. 1374+50 SBL)
2.78 MI SOUTH OF BUCKLEY INTERCHANGE

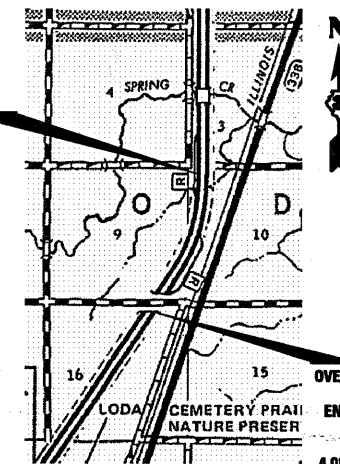

IROQUOIS COUNTY

LOCATION 4 - FAI ROUTE 57
OVERHEAD SIGN STRUCTURE - CANTILEVER
S.N. #3C0381057268.0
ENTRANCE TO NB MAINLINE REST AREA
(EXISTING STA. 1442+75 NBL)
(PROPOSED STA. 1442+55 NBL)
4.08 MI SOUTH OF BUCKLEY INTERCHANGE

LOCATION 2 - FAI ROUTE 80
OVERHEAD SIGN STRUCTURE
S.N. #3S03210801112.2
(STA. 1217+88 WB I)
0.08 MI. NORTHEAST OF IL RTE. 47

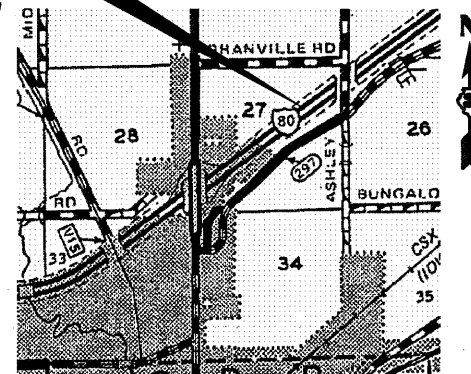

GRUNDY COUNTY

LOCATION 3 - FAI ROUTE 80
OVERHEAD SIGN STRUCTURE - CANTILEVER
S.N. #3C03210801118.7
ENTRANCE TO WB THREE RIVERS REST AREA
(EXISTING STA. 1548+00 SBL)
(PROPOSED STA. 1548+40 SBL)
3.1 MI. SOUTHWEST OF MINOOKA INTERCHANGE

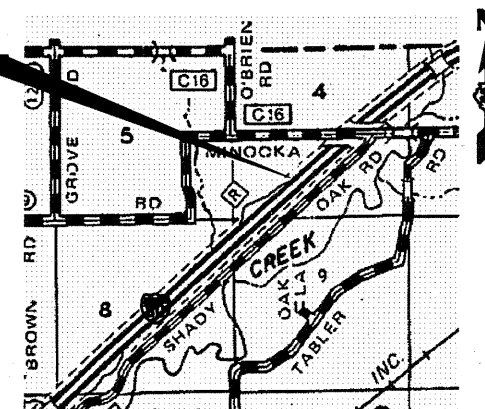

GRUNDY COUNTY

J.U.L.I.E.
JOINT UTILITY LOCATION INFORMATION FOR EXCAVATION
1-800-892-0123
OR 811

**PROJECT ENGINEER: JOE KANNEL
UNIT CHIEF: RON WOODSHANK
TOWNSHIP: VARIOUS**

CONTRACT NO. 46131

**FUNCTIONAL CLASSIFICATION
RURAL - INTERSTATE**

FAI ROUTE 39	FAI ROUTE 80	FAI ROUTE 57
2009 ADT = 18200	2009 ADT = 38500	2009 ADT = 15400
P.V. = 68.13%	P.V. = 75.71%	P.V. = 74.68%
M.U. = 26.92%	M.U. = 18.18%	M.U. = 19.48%
S.U. = 4.95%	S.U. = 6.10%	S.U. = 5.84%

STATE OF ILLINOIS
DEPARTMENT OF TRANSPORTATION
DIVISION OF HIGHWAYS

SUBMITTED Aug. 3, 2010

PASSED [Signature] ENGINEER OF OPERATIONS

_____ 20 _____ ENGINEER OF DESIGN AND ENVIRONMENT

APPROVED _____ 20 _____ DIRECTOR DIVISION OF HIGHWAYS

**PRINTED BY THE AUTHORITY
OF THE STATE OF ILLINOIS**