

Note:
There are twice as many horizontal diagonals as there are vertical diagonals.

TRUSS UNIT TABLE

Truss Type	Dimension "a"	Dimension "b"	Dimension "s"	Limits for Panel Spacing (P)*	Up. & Low. Chord		Verticals; Horizontals; Vertical, Horizontal, and Interior Diagonals	
					O.D.	Wall	O.D.	Wall
I-C-A	24"	54"	16"	36" min. to 48" max.	5"	5/16"	2 1/2"	5/16"
II-C-A	36"	66"	21"	42" min. to 54" max.	6 1/2"	5/16"	3 1/4"	5/16"
III-C-A (35' Max.)	36"	84"	21"	48" min. to 66" max.	7"	3/8"	3 1/2"	3/8"
III-C-A (>35' to 40')	36"	84"	21"	48" min. to 66" max.	8"	3/8"	3 1/2"	3/8"

$$*P = \frac{L - s - 3"}{\# \text{ Panels}}$$

Structure Number	Station	Truss Type	Design Length (L)	Number of Panels Per Unit	Panel Length (P)*
3C0321080L118.7	1548+40	II-C-A	30'-0"	7	4'-0"
3C0381057R268.0	1442+55	II-C-A	30'-0"	7	4'-0"
3C0381057L269.3	1374+50	II-C-A	30'-0"	7	4'-0"

SHOP CAMBER TABLE

Unit Length (L)	Shop Camber at End
15'	1 1/2"
16'-17'	1 3/4"
18'-20'	2"
21'-22'	2 1/4"
23'-25'	2 1/2"
26'-27'	2 3/4"
28'-30'	3"
31'-32'	3 1/4"
33'-35'	3 1/2"
36'-37'	4"
38'-40'	4 1/2"

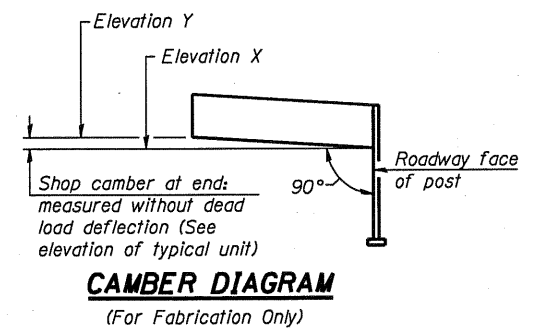
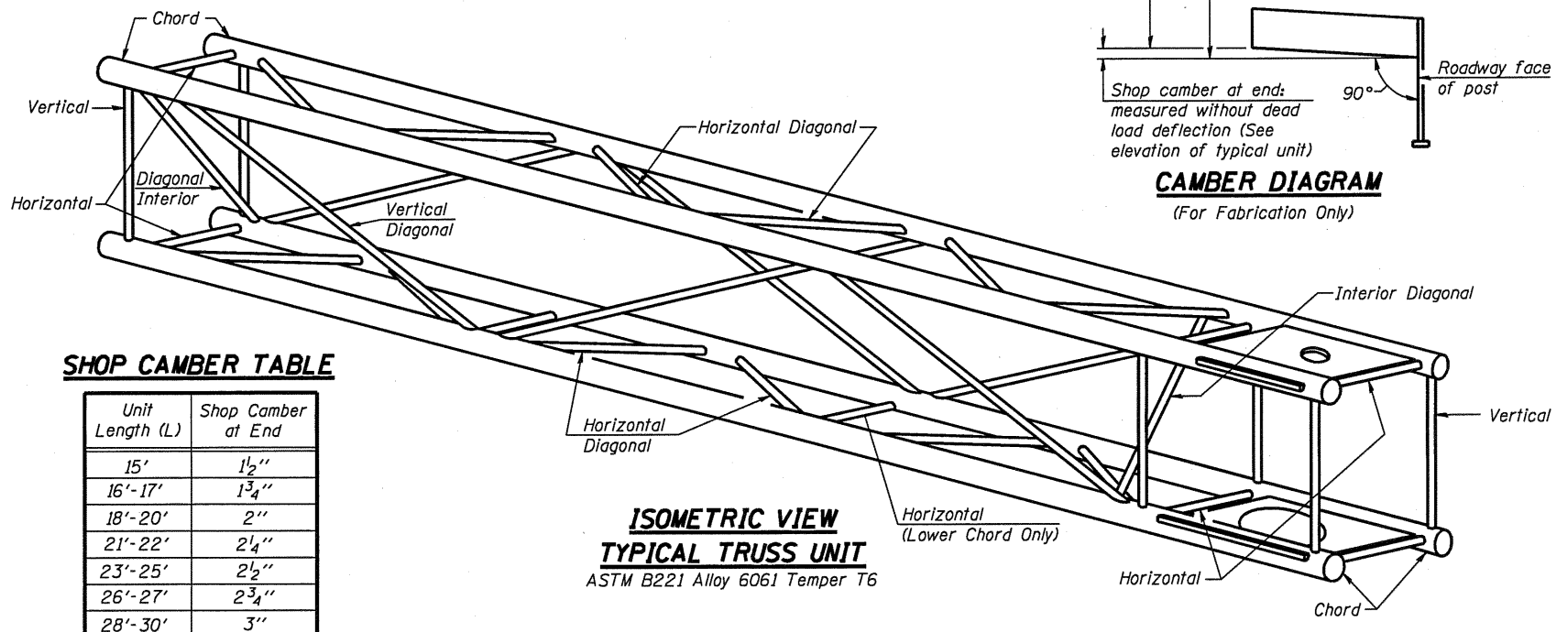

OSC-A-2 7-1-10

FILE NAME * c:\pwwork\pwwork\woodshankr1\d0235124\6131-Detail.dgn	USER NAME * woodshankr1	DESIGNED - RON WOODSHANK	REVISED - -----
PLOT SCALE * 100.0000 / IN.	CHECKED - ---	DRAWN - RON WOODSHANK	REVISED - -----
PLOT DATE * Sep 23, 2010 09:37:07 AM	DATE - -----	CHECKED - ---	REVISED - -----

STATE OF ILLINOIS
DEPARTMENT OF TRANSPORTATION

CANTILEVER SIGN STRUCTURES - TRUSS DETAILS
ALUMINUM TRUSS & STEEL POST

F.A.I. RTE. VAR	SECTION D-3 OVD SIN STR REPL 2011-08	COUNTY VAR	TOTAL SHEETS 25	SHEET NO. 16
SCALE: _____		SHEET NO. 2 OF 9 SHEETS		STA. _____ TO STA. _____
ILLINOIS				

CONTRACT NO. 46131