

ROUTE	SECTION	COUNTY	TOTAL SHEETS	SHEET NUMBER
FAI 94	2010-089-BP	COOK	35	8

CONTRACT NO. 60L85

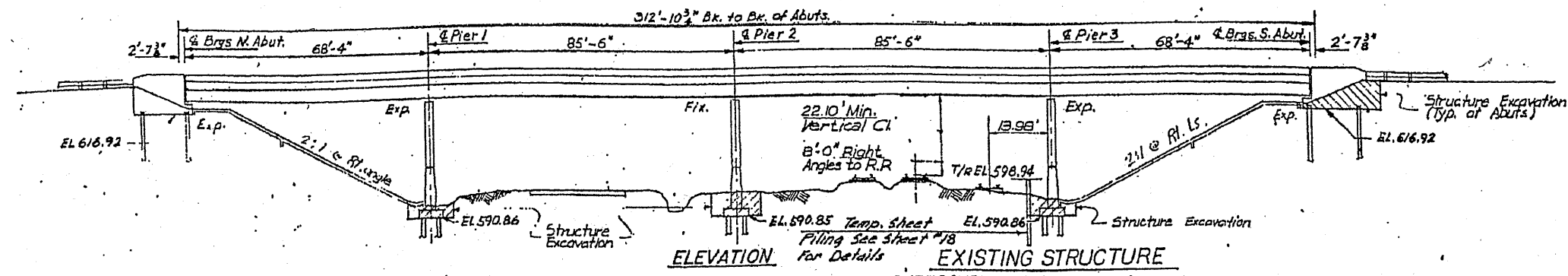

NOTE
RR TRACKS HAVE BEEN REMOVED.

EXISTING STRUCTURE
SUPERSTRUCTURE: R.C. Deck on steel beams
308'-4" long - 101'-0" wide
SUBSTRUCTURE: Abutments - Conc. Pile Bents
Piers - Multi-columns with crash wall on pile footings.

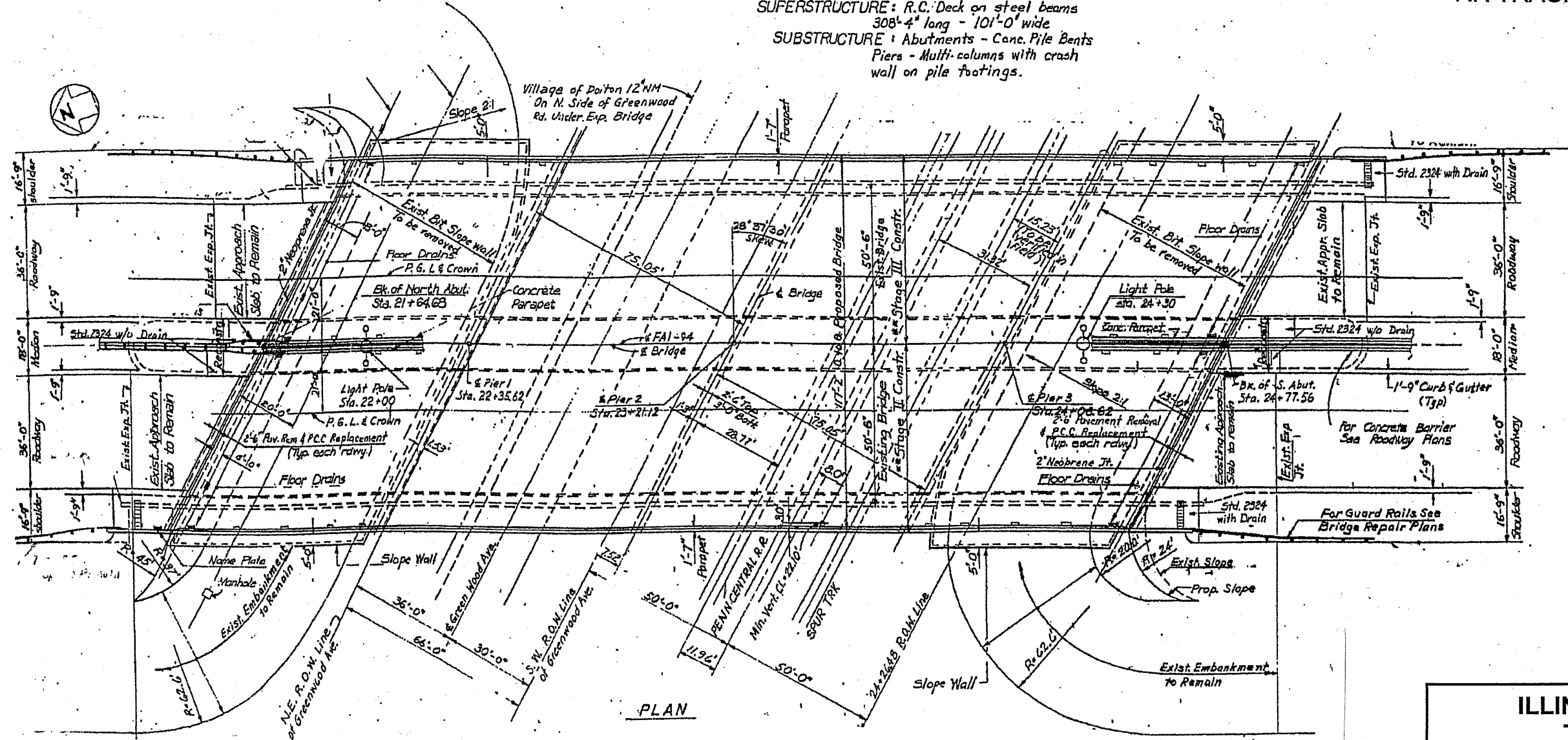

SHEET 1 OF 4

ILLINOIS DEPARTMENT OF TRANSPORTATION

EXISTING BRIDGE PLAN
SN 016-0162 (BRIDGE 1)

FOR INFORMATION ONLY