

F.A.P. RTE.	SECTION	COUNTY	TOTAL SHEETS	SHEET NO.
303	134(B&B-2)R-1	LAKE	137	29
STA. 26+090 TO STA. 26+272				
FED. ROAD DIST. NO. 1 ILLINOIS FED. AID PROJECT				

CONTRACT NO. 62037

MAJOR WORK STAGE I:

1. TRAFFIC USES NORTHERN PORTION OF EXISTING BRIDGE.
2. SOUTHERN PORTION OF EXISTING BRIDGE IS REMOVED.
3. SOUTHERN PORTION OF NEW BRIDGE IS CONSTRUCTED.
4. REMOVE EXISTING BRIDGE APPROACH SLABS, AND PAVEMENT EAST OF BRIDGE, GRADE, PAVE SOUTH HALF OF IL ROUTE 173.
5. ADD TEMPORARY RAMP BEGINNING STA 26+225 WITH BUTT JOINT.

NOTES:

1. LOCATIONS OF ADVANCED WARNING SIGNS AND TEMPORARY CONCRETE BARRIER FOR STAGE I WORK SHALL BE AS SHOWN ON THIS PLAN SHEET. ALL OTHER TRAFFIC CONTROL FOR THIS WORK SHALL BE IN ACCORDANCE WITH HIGHWAY STANDARD 701321. WORK SHALL NOT BEGIN UNTIL ALL TRAFFIC CONTROL DEVICES ARE IN PLACE AND APPROVED BY THE ENGINEER.
2. THE CONTRACTOR SHALL MAINTAIN ACCESS TO PRIVATE AND COMMERCIAL ENTRANCES AND SIDESTREETS, AS SHOWN.
3. ALL ADVANCED WARNING SIGNS ON THIS SHEET ARE TO BE POST MOUNTED.
4. THE STATIONING FOR SIGNS AND SIGNALS ARE APPROXIMATE. ADJUST LOCATIONS AS NEEDED TO AVOID SIDEROADS, DRIVEWAYS, AND OTHER OBSTACLES.
5. SEE SIGNAL PLANS.
6. NUMBER OF TYPE III BARRICADES IS AS REQUIRED FOR CLOSURE.
7. PROVIDE AND INSTALL ALTERNATE SIGNING PER DETAIL. THIS WORK IS INCLUDED WITH TRAFFIC CONTROL AND PROTECTION ITEM.

SYMBOLS

- DRUM WITH STEADY BURNING MONODIRECTIONAL LIGHT. DRUMS ON TAPER SHALL BE AT 15m CENTERS. DRUMS ON TAPER AND ON RADIUS RETURNS SHALL BE AT 7.6m CENTERS.
- WORK AREA
- DOUBLE VERTICAL PANEL
- TYPE III BARRICADE WITH 2 FLASHING MONODIRECTIONAL LIGHTS EACH
- SIGN
- TEMPORARY CONCRETE BARRIER
- IMPACT ATTENUATORS, DESIGN SPEED 40mph ADVISORY SPEED 30mph
- CRYSTAL, BIDIRECTIONAL BARRIER WALL/GUARDRAIL MARKER

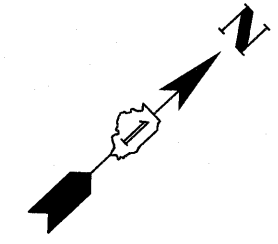
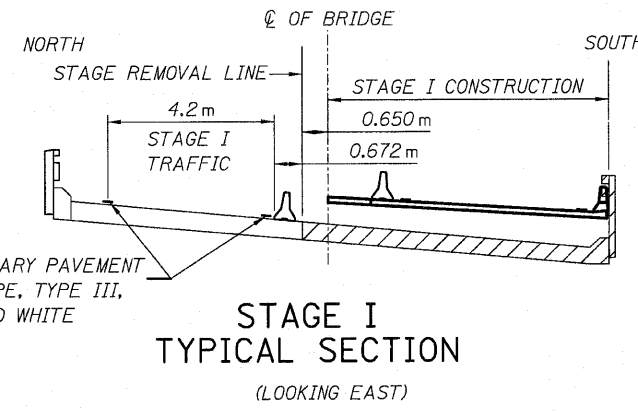

TEMPORARY TRAFFIC SIGNAL LEGEND

- TEMPORARY TRAFFIC SIGNAL HEAD
- SPAN WIRE MOUNTED ORIGINAL LOCATION
- TEMPORARY WOOD POLE (CLASS 5 OR BETTER) 45 FOOT MINIMUM
- TEMPORARY CONTROLLER CABINET
- TEMPORARY SPAN WIRE, TETHER WIRE, AND CABLE
- TEMPORARY SERVICE INSTALLATION
- VIDEO DETECTOR
- VIDEO DETECTOR ZONE

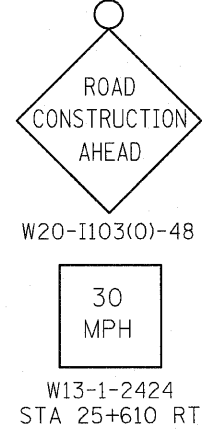
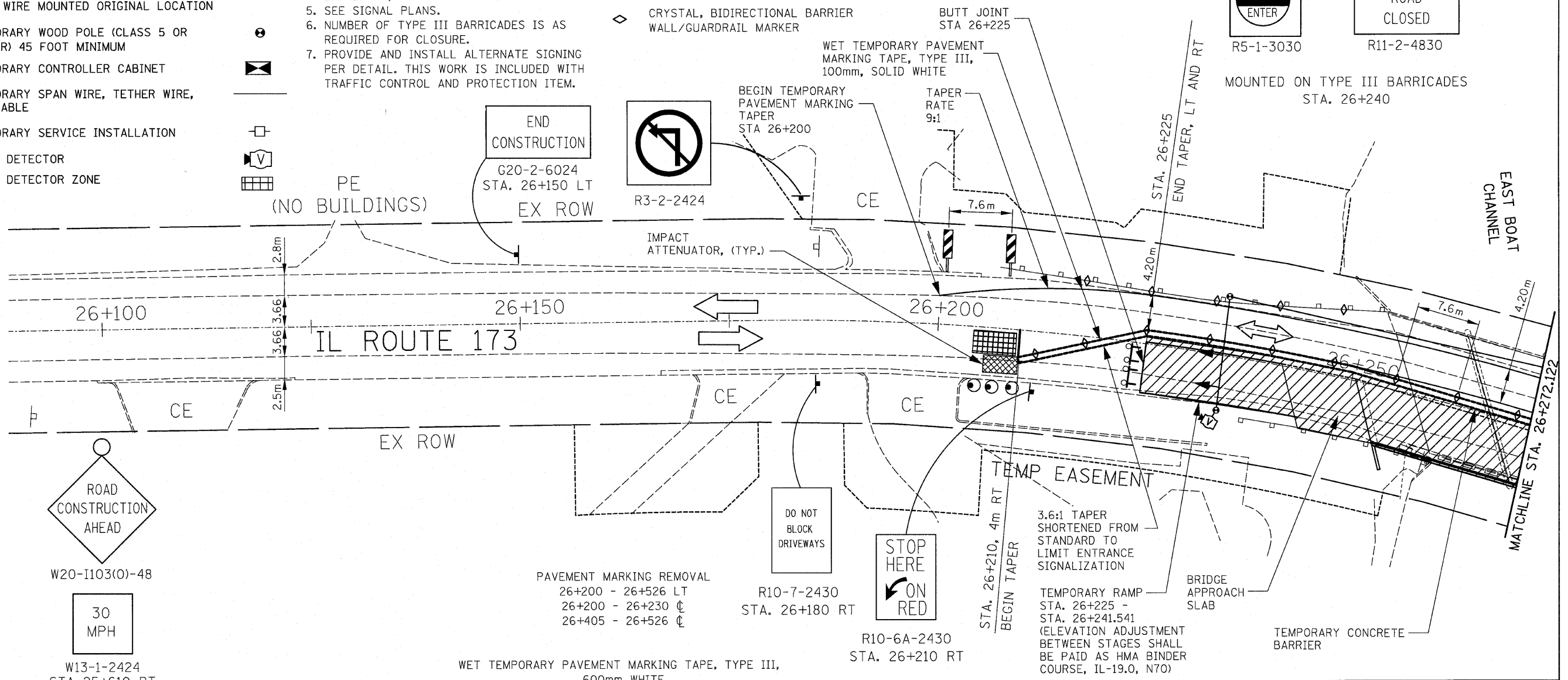

SEE STANDARD 701321 FOR ADVANCE WARNING SIGNS
FIRST TWO WARNING SIGNS REQUIRE MONODIRECTIONAL FLASHING BEACONS

PAVEMENT MARKING REMOVAL
26+200 - 26+526 LT
26+200 - 26+230 C
26+405 - 26+526 C

WET TEMPORARY PAVEMENT MARKING TAPE, TYPE III,
600mm WHITE
26+210 RT
26+526 LT

WET TEMPORARY PAVEMENT MARKING TAPE, TYPE III,
100mm WHITE
26+200 - 26+526 LT
26+210 - 26+470 RT

REVISIONS	
NAME	DATE

ILLINOIS DEPARTMENT OF TRANSPORTATION
IL ROUTE 173 OVER EAST BOAT CHANNEL
**MAINTENANCE OF TRAFFIC STAGE I
EAST BOAT CHANNEL**
SCALE: 1:250
DRAWN BY CLG
CHECKED BY JJD
DATE 3-8-10



3116TRAFFEAST1.DGN