

F.A.P. RTE.	SECTION	COUNTY	TOTAL SHEETS	SHEET NO.
303	134(B&B-2)R-1	LAKE	137	31
STA. 26+450 TO STA. 26+625				
FED. ROAD DIST. NO. 1 ILLINOIS FED. AID PROJECT				

CONTRACT NO. 62037

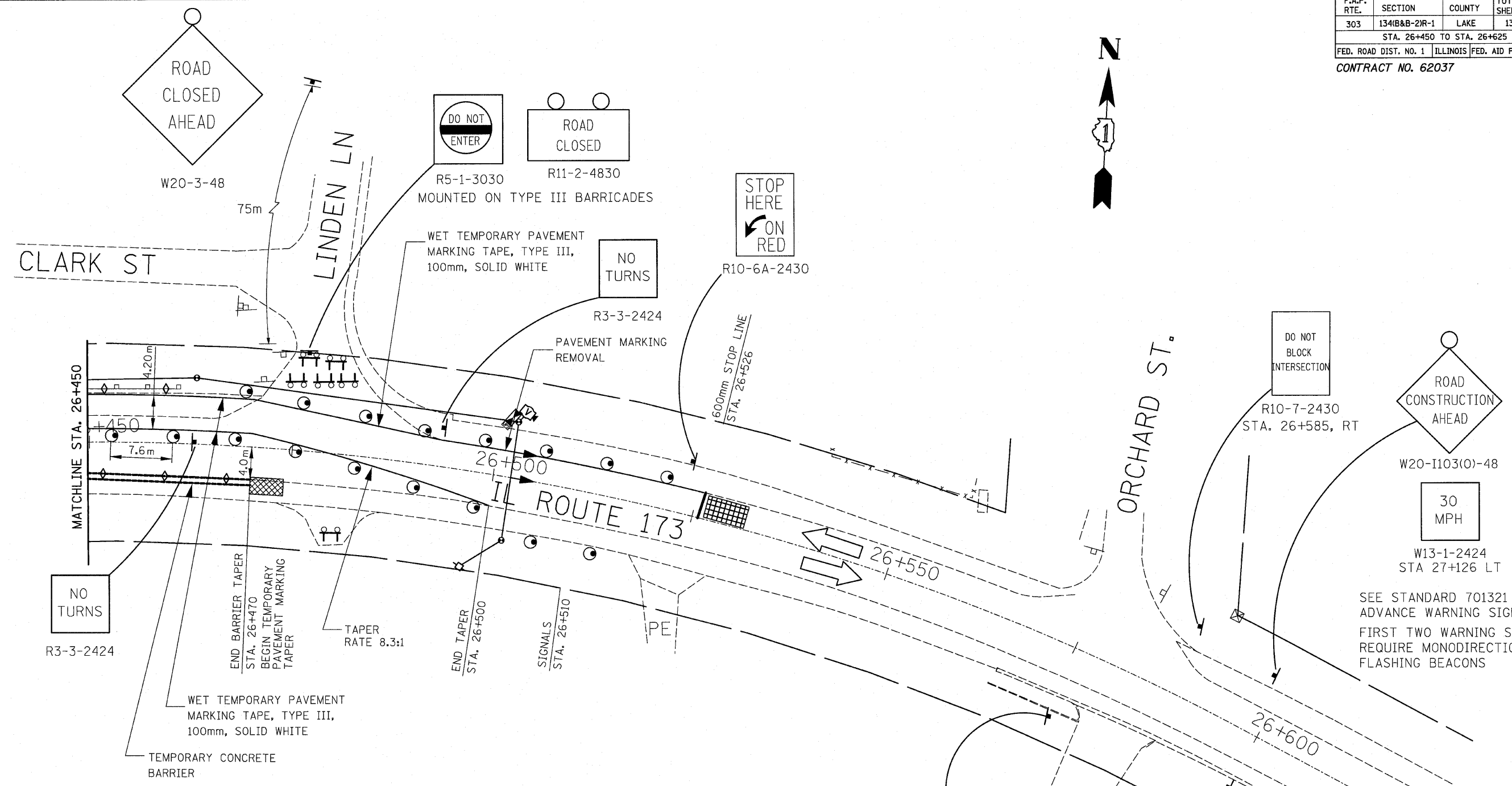

NO TURNS  
R3-3-2424

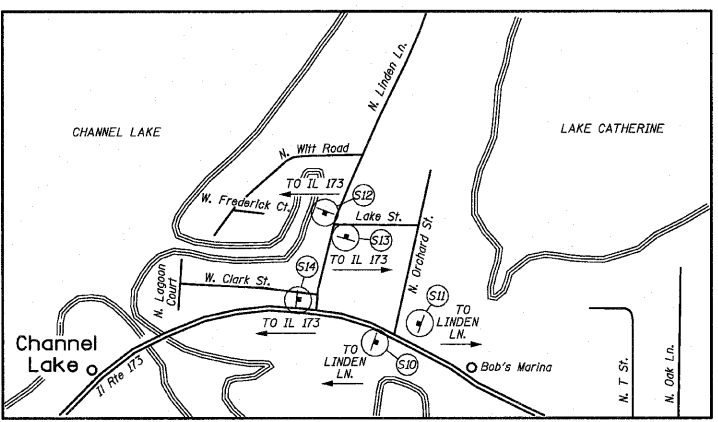
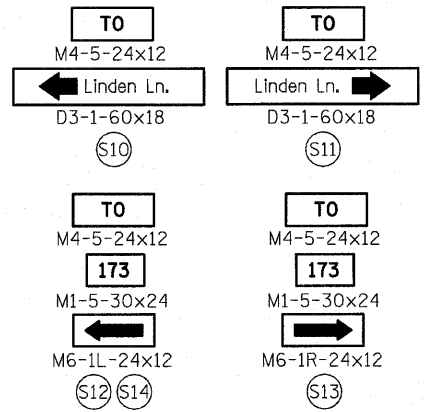

END CONSTRUCTION  
G20-2-6024  
STA. 26+550 RT

SEE STANDARD 701321 FOR ADVANCE WARNING SIGNS  
FIRST TWO WARNING SIGNS REQUIRE MONODIRECTIONAL FLASHING BEACONS

REVISIONS	
NAME	DATE

ILLINOIS DEPARTMENT OF TRANSPORTATION  
IL ROUTE 173 OVER EAST BOAT CHANNEL  
**MAINTENANCE OF TRAFFIC STAGE I  
EAST BOAT CHANNEL**  
SCALE: 1:250  
DRAWN BY CLG  
CHECKED BY JJD  
DATE 3-8-10



3116TRAFFEA1.DGN