

MAJOR WORK STAGE II:

1. TRAFFIC USES SOUTHERN PORTION OF NEW BRIDGE.
2. NORTHERN PORTION OF EXISTING BRIDGE IS REMOVED.
3. NORTHERN PORTION OF NEW BRIDGE IS CONSTRUCTED.
4. REMOVE EXISTING BRIDGE APPROACH SLABS, AND PAVEMENT EAST OF BRIDGE, GRADE, PAVE NORTH PORTION OF IL ROUTE 173.
5. ADD TEMPORARY RAMP WEST OF BRIDGE BEGINNING STA 26+225 WITH BUTT JOINT.

NOTES:

1. LOCATIONS OF ADVANCED WARNING SIGNS AND TEMPORARY CONCRETE BARRIER FOR STAGE II WORK SHALL BE AS SHOWN ON THIS PLAN SHEET. ALL OTHER TRAFFIC CONTROL FOR THIS WORK SHALL BE IN ACCORDANCE WITH HIGHWAY STANDARD 701321. WORK SHALL NOT BEGIN UNTIL ALL TRAFFIC CONTROL DEVICES ARE IN PLACE AND APPROVED BY THE ENGINEER.
2. THE CONTRACTOR SHALL MAINTAIN ACCESS TO PRIVATE AND COMMERCIAL ENTRANCES AND SIDESTREETS, AS SHOWN.
3. ALL ADVANCED WARNING SIGNS ON THIS SHEET ARE TO BE POST MOUNTED.
4. THE STATIONING FOR SIGNS AND SIGNALS ARE APPROXIMATE. ADJUST LOCATIONS AS NEEDED TO AVOID SIDEROADS, DRIVEWAYS, & OTHER OBSTACLES.
5. SEE SIGNAL PLANS.
6. NUMBER OF TYPE III BARRICADES IS AS REQUIRED FOR CLOSURE.

SYMBOLS

- DRUM WITH STEADY BURNING MONODIRECTIONAL LIGHT. DRUMS ON TANGENT SHALL BE AT 15m CENTERS. DRUMS ON TAPER AND ON RADIUS RETURNS SHALL BE AT 7.6m CENTERS.
- WORK AREA
- DOUBLE VERTICAL PANEL
- TYPE III BARRICADE WITH 2 FLASHING MONODIRECTIONAL LIGHTS EACH
- SIGN
- TEMPORARY CONCRETE BARRIER
- IMPACT ATTENUATORS, DESIGN SPEED 40mph ADVISORY SPEED 30mph
- CRYSTAL, BIDIRECTIONAL BARRIER WALL/GUARDRAIL MARKER

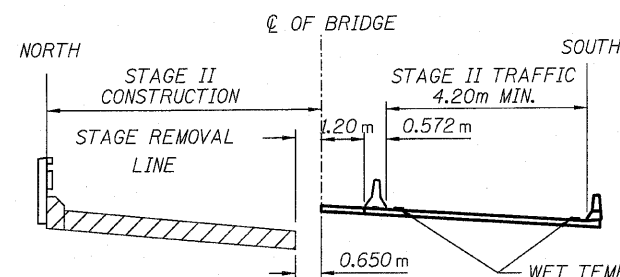

STAGE II TYPICAL SECTION (LOOKING EAST)

3:1 TAPER SHORTENED FROM STANDARD TO LIMIT ENTRANCE SIGNALIZATION

F.A.P. RTE.	SECTION	COUNTY	TOTAL SHEETS	SHEET NO.
303	134(B&B-2)R-1	LAKE	137	32
STA. 26+090 TO STA. 26+272		ILLINOIS FED. AID PROJECT		
FED. ROAD DIST. NO. 1		CONTRACT NO. 62037		

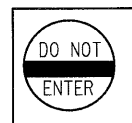

R5-1-3030

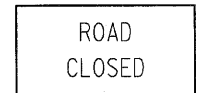

R11-2-4830

MOUNTED ON TYPE III BARRICADES STA. 26+240

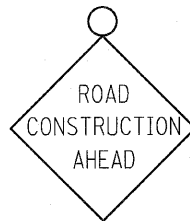
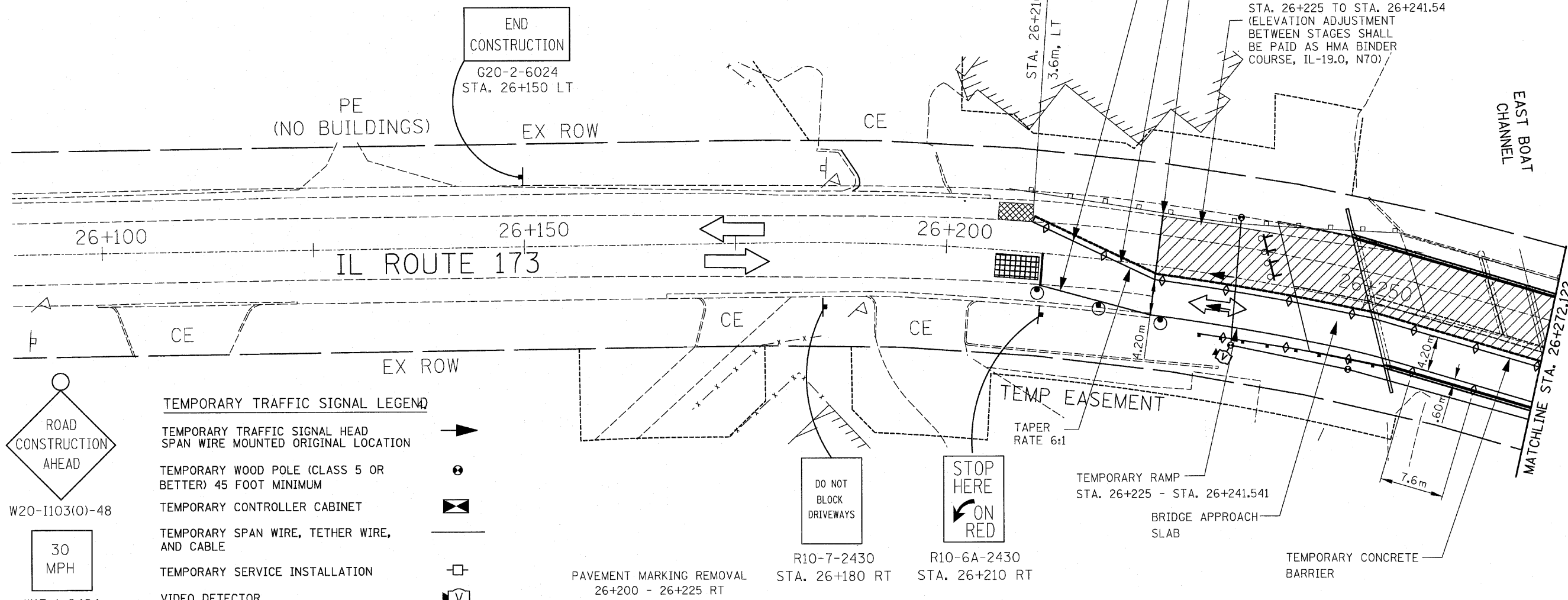

W20-1103(O)-48

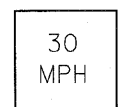

W13-1-2424 STA 25+610 RT

TEMPORARY TRAFFIC SIGNAL LEGEND

- TEMPORARY TRAFFIC SIGNAL HEAD SPAN WIRE MOUNTED ORIGINAL LOCATION
- TEMPORARY WOOD POLE (CLASS 5 OR BETTER) 45 FOOT MINIMUM
- TEMPORARY CONTROLLER CABINET
- TEMPORARY SPAN WIRE, TETHER WIRE, AND CABLE
- TEMPORARY SERVICE INSTALLATION
- VIDEO DETECTOR
- VIDEO DETECTOR ZONE

SEE STANDARD 701321 FOR ADVANCE WARNING SIGNS
FIRST TWO WARNING SIGNS REQUIRE MONODIRECTIONAL FLASHING BEACONS

REVISIONS	
NAME	DATE

ILLINOIS DEPARTMENT OF TRANSPORTATION
IL ROUTE 173 OVER EAST BOAT CHANNEL
MAINTENANCE OF TRAFFIC STAGE II EAST BOAT CHANNEL
SCALE: 1:250
DRAWN BY CLG
CHECKED BY JJD
DATE 3-8-10



3116TRAFFEAST2.DGN