

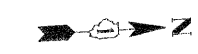

NTS

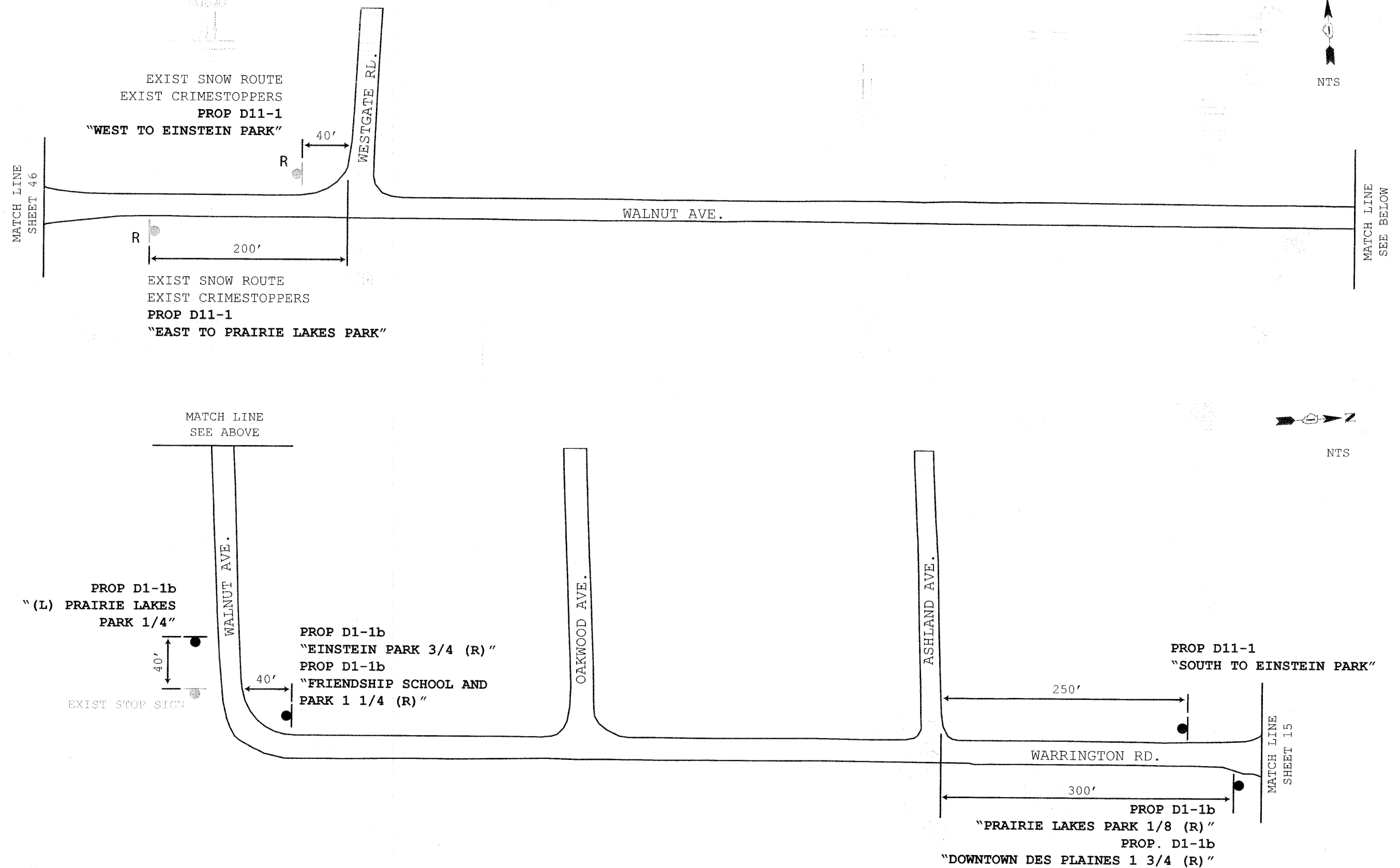

NTS



EXIST SNOW ROUTE
EXIST CRIMESTOPPERS
PROP D11-1
"WEST TO EINSTEIN PARK"

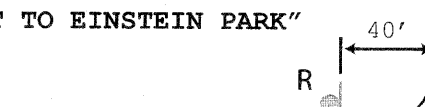

EXIST SNOW ROUTE
EXIST CRIMESTOPPERS
PROP D11-1
"EAST TO PRAIRIE LAKES PARK"

MATCH LINE
SEE ABOVE

PROP D1-1b
"(L) PRAIRIE LAKES
PARK 1/4"

EXIST STOP SIGN

PROP D1-1b
"EINSTEIN PARK 3/4 (R)"
PROP D1-1b
"FRIENDSHIP SCHOOL AND
PARK 1 1/4 (R)"

PROP D11-1
"SOUTH TO EINSTEIN PARK"

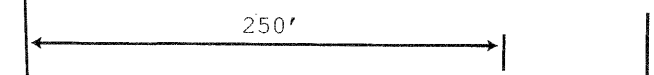

PROP D1-1b
"PRAIRIE LAKES PARK 1/8 (R)"
PROP. D1-1b
"DOWNTOWN DES PLAINES 1 3/4 (R)"

TYLIN INTERNATIONAL	DESIGNED - SM	REVISED -	CITY OF DES PLAINES STAGE 1 BIKE NETWORK	SIGNING PLAN WALNUT AVENUE/WARRINGTON ROAD	F.A. RTE.	SECTION	COUNTY	TOTAL SHEETS	SHEET NO.
	DRAWN - TG	REVISED -			09-00208-00-BT	COOK	51	47	
	CHECKED - DAJ	REVISED -			CONTRACT NO. 63359				
	DATE - 04/26/10	REVISED -			FED. ROAD DIST. NO. 1 ILLINOIS FED. AID PROJECT				