

**Restoration of Work Area.** Restoration of the traffic signal work area shall be incidental to the related pay items such as foundation, conduit, handhole, trench and backfill, etc., and no extra compensation shall be allowed. All roadway surfaces such as shoulders, medians, sidewalks, pavement, etc. shall be replaced in kind. All damage to mowed lawns shall be replaced with an approved sod, and all damage to unmowed fields shall be seeded in accordance with Standard Specifications 252 and 250 respectively.

THE TRAFFIC SIGNAL CONTROL EQUIPMENT FOR THIS PROJECT SHALL BE "NTCIP" COMPLIANT.

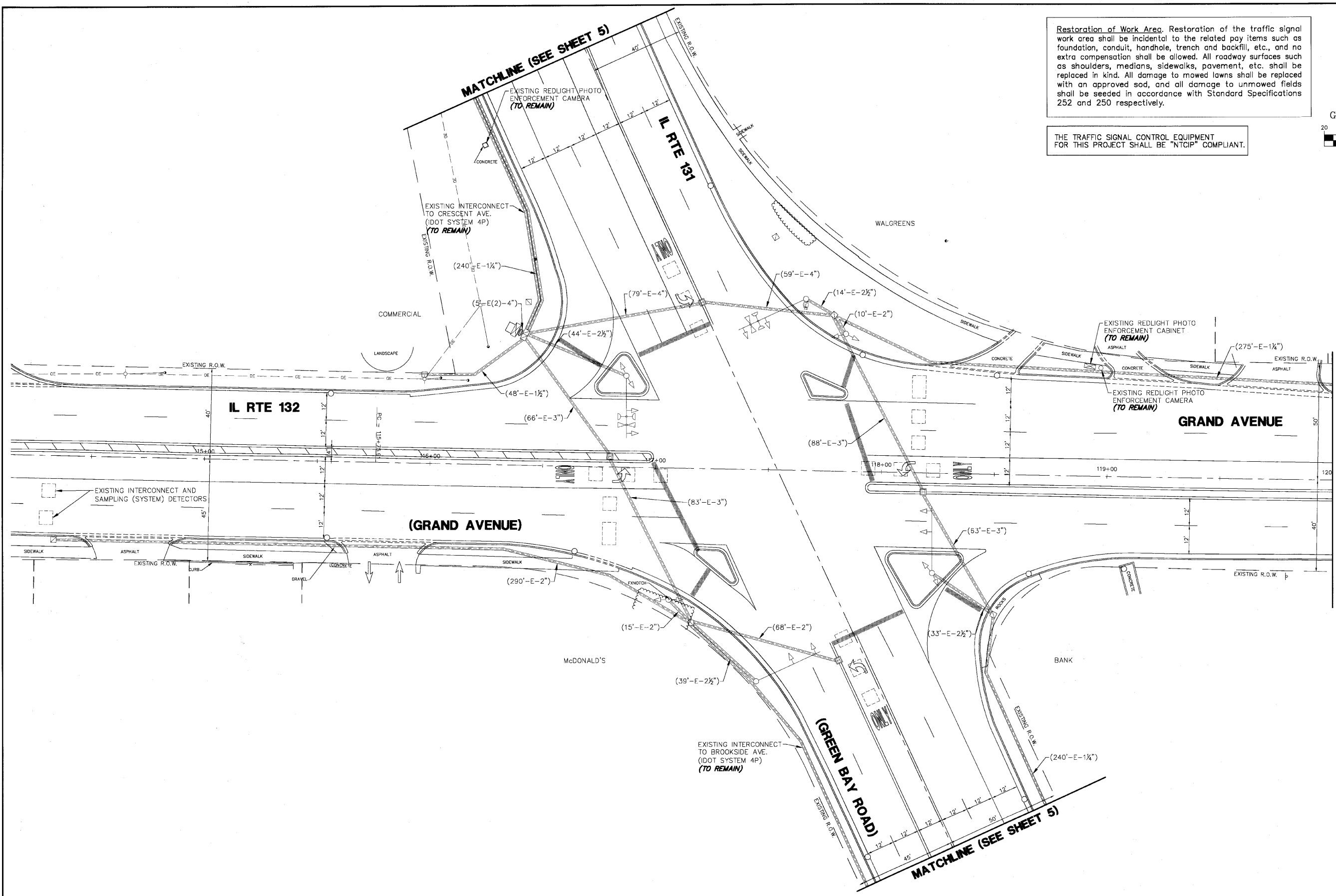
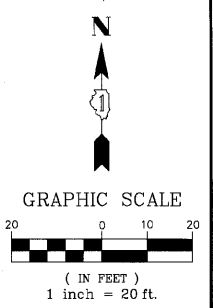

MATCH LINE - STA. 120+00 (SEE SHEET 11)

GHA #4136.800

FILE NAME =	4136.800-TR2.dwg
USER NAME =	GHA
PLOT SCALE =	1" = .0833'
PLOT DATE =	3/10/10

DESIGNED -	JRD
DRAWN -	ZCW
CHECKED -	DPB
DATE -	3/10/10

REVISED -	
REVISED -	
REVISED -	
REVISED -	

**Lake County**  
Division of Transportation

TRAFFIC SIGNAL MODIFICATION PLAN			
<b>IL RTE 132 (GRAND AVENUE) AT IL RTE 131 (GREEN BAY ROAD)</b>			
SCALE: 1"=20'	SHEET NO. OF SHEETS	STA. TO STA.	

F&P RTE.	SECTION	COUNTY	TOTAL SHEETS	SHEET NO.
541	08-00279-00-TL	LAKE	64	10
CONTRACT #:			63436	
ILLINOIS FED. AID PROJECT				