

**LEGEND**

- STREET NAME SIGN
- COMBINATION CONCRETE CURB & GUTTER, TYPE B-6.12 OR TYPE B-6.24
- PORTLAND CEMENT CONCRETE SIDEWALK, 5"
- DETECTABLE WARNING
- LED ILLUMINATED STREET NAME SIGN
- BRICK PAVER REINSTALLATION

**PROPOSED**

- (Symbol for Street Name Sign)
- (Symbol for Combination Concrete Curb & Gutter)
- (Symbol for Portland Cement Concrete Sidewalk)
- (Symbol for Detectable Warning)
- (Symbol for LED Illuminated Street Name Sign)
- (Symbol for Brick Paver Reinstallation)

**Restoration of Work Area.** Restoration of the traffic signal work area shall be incidental to the related pay items such as foundation, conduit, handhole, trench and backfill, etc., and no extra compensation shall be allowed. All roadway surfaces such as shoulders, medians, sidewalks, pavement, etc. shall be replaced in kind. All damage to mowed lawns shall be replaced with an approved sod, and all damage to unmowed fields shall be seeded in accordance with Standard Specifications 252 and 250 respectively.

THE TRAFFIC SIGNAL CONTROL EQUIPMENT FOR THIS PROJECT SHALL BE "NTCIP" COMPLIANT.

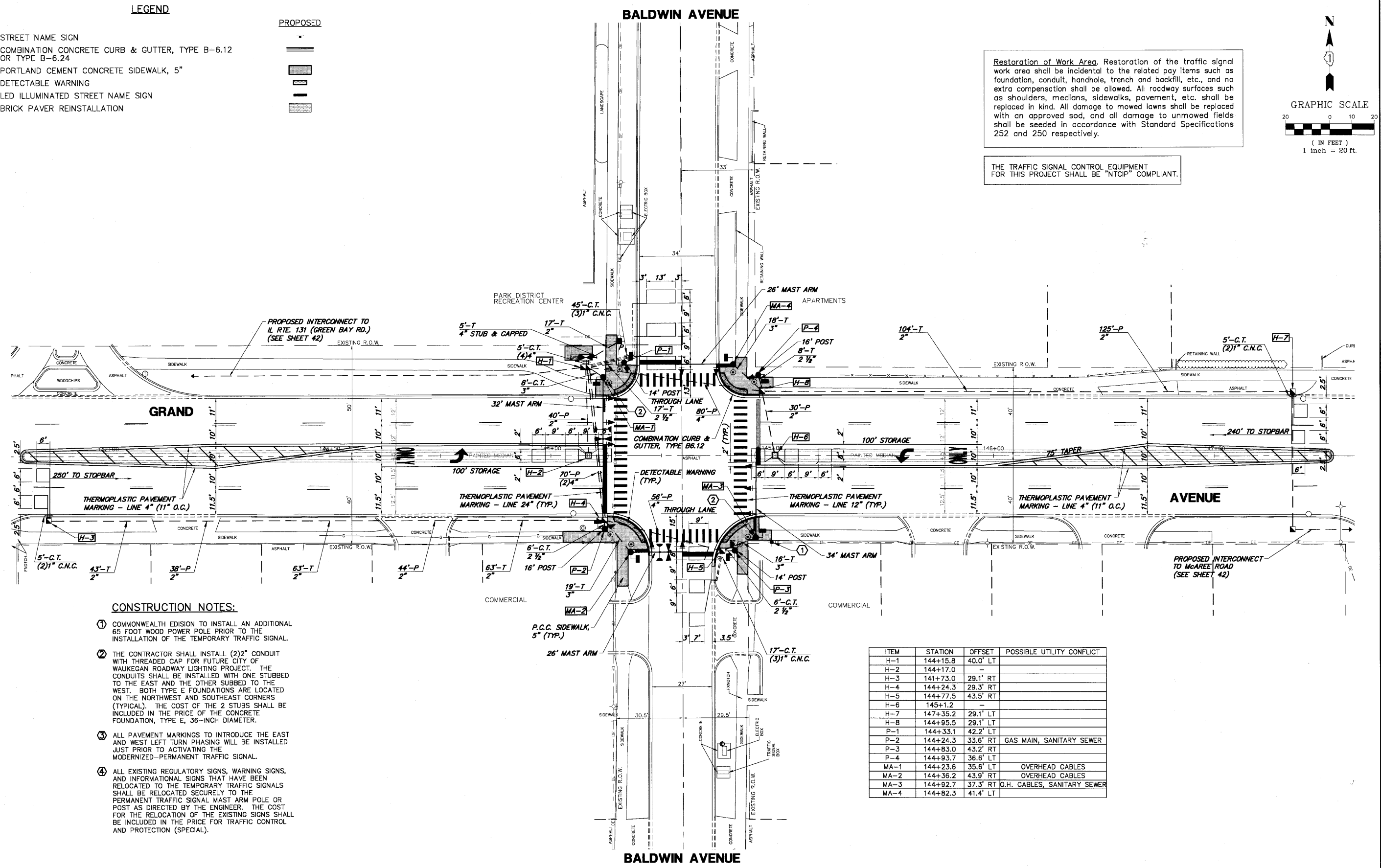
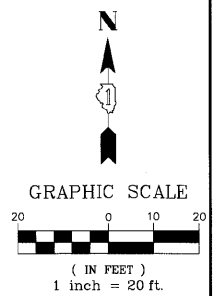

**CONSTRUCTION NOTES:**

- ① COMMONWEALTH EDISON TO INSTALL AN ADDITIONAL 65 FOOT WOOD POWER POLE PRIOR TO THE INSTALLATION OF THE TEMPORARY TRAFFIC SIGNAL.
- ② THE CONTRACTOR SHALL INSTALL (2) 2" CONDUIT WITH THREADED CAP FOR FUTURE CITY OF WAUKEGAN ROADWAY LIGHTING PROJECT. THE CONDUITS SHALL BE INSTALLED WITH ONE STUBBED TO THE EAST AND THE OTHER STUBBED TO THE WEST. BOTH TYPE E FOUNDATIONS ARE LOCATED ON THE NORTHWEST AND SOUTHEAST CORNERS (TYPICAL). THE COST OF THE 2 STUBS SHALL BE INCLUDED IN THE PRICE OF THE CONCRETE FOUNDATION, TYPE E, 36-INCH DIAMETER.
- ③ ALL PAVEMENT MARKINGS TO INTRODUCE THE EAST AND WEST LEFT TURN PHASING WILL BE INSTALLED JUST PRIOR TO ACTIVATING THE MODERNIZED-PERMANENT TRAFFIC SIGNAL.
- ④ ALL EXISTING REGULATORY SIGNS, WARNING SIGNS, AND INFORMATIONAL SIGNS THAT HAVE BEEN RELOCATED TO THE TEMPORARY TRAFFIC SIGNALS SHALL BE RELOCATED SECURELY TO THE PERMANENT TRAFFIC SIGNAL MAST ARM POLE OR POST AS DIRECTED BY THE ENGINEER. THE COST FOR THE RELOCATION OF THE EXISTING SIGNS SHALL BE INCLUDED IN THE PRICE FOR TRAFFIC CONTROL AND PROTECTION (SPECIAL).

ITEM	STATION	OFFSET	POSSIBLE UTILITY CONFLICT
H-1	144+15.8	40.0' LT	
H-2	144+17.0	-	
H-3	141+73.0	29.1' RT	
H-4	144+24.3	29.3' RT	
H-5	144+77.5	43.5' RT	
H-6	145+1.2	-	
H-7	147+35.2	29.1' LT	
H-8	144+95.5	29.1' LT	
P-1	144+33.1	42.2' LT	
P-2	144+24.3	33.6' RT	GAS MAIN, SANITARY SEWER
P-3	144+83.0	43.2' RT	
P-4	144+93.7	36.6' LT	
MA-1	144+23.6	35.6' LT	OVERHEAD CABLES
MA-2	144+36.2	43.9' RT	OVERHEAD CABLES
MA-3	144+92.7	37.3' RT	O.H. CABLES, SANITARY SEWER
MA-4	144+82.3	41.4' LT	

GHA #4136.800

FILE NAME = 4136.800-TR2.dwg

USER NAME = GHA  
 PLOT SCALE = 1" = .0833'  
 PLOT DATE = 3/10/10

DESIGNED - JRD  
 DRAWN - ZCW  
 CHECKED - DPB  
 DATE - 3/10/10

REVISED -  
 REVISED -  
 REVISED -  
 REVISED -



**TRAFFIC SIGNAL MODERNIZATION PLAN**  
**GRAND AVENUE AT BALDWIN AVENUE**  
 SCALE: 1" = 20'  
 SHEET NO. OF SHEETS STA. TO STA.

FAP RTE	SECTION	COUNTY	TOTAL SHEETS	SHEET NO.
541	08-00279-00-TL	LAKE	64	15

CONTRACT #: 63436  
 ILLINOIS FED. AID PROJECT