

LEGEND

- STREET NAME SIGN
- COMBINATION CONCRETE CURB & GUTTER, TYPE B-6.12 OR TYPE B-6.24
- PORTLAND CEMENT CONCRETE SIDEWALK, 5"
- DETECTABLE WARNING
- LED ILLUMINATED STREET NAME SIGN
- BRICK PAVER REINSTALLATION

PROPOSED



JACKSON STREET

Restoration of Work Area. Restoration of the traffic signal work area shall be incidental to the related pay items such as foundation, conduit, handhole, trench and backfill, etc., and no extra compensation shall be allowed. All roadway surfaces such as shoulders, medians, sidewalks, pavement, etc. shall be replaced in kind. All damage to mowed lawns shall be replaced with an approved sod, and all damage to unmowed fields shall be seeded in accordance with Standard Specifications 252 and 250 respectively.

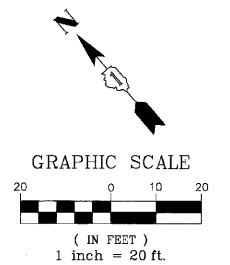

THE TRAFFIC SIGNAL CONTROL EQUIPMENT FOR THIS PROJECT SHALL BE "NTCIP" COMPLIANT.

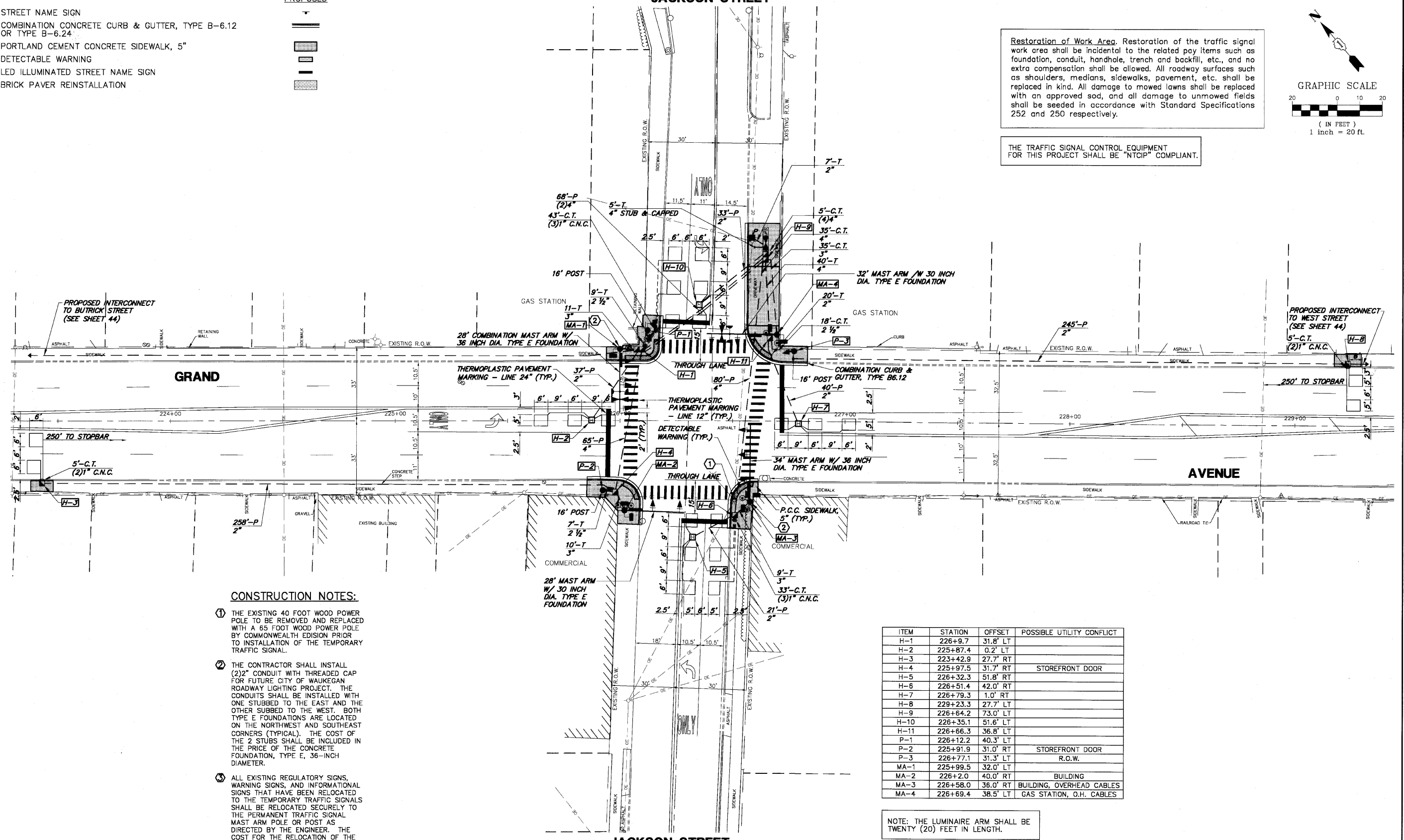

CONSTRUCTION NOTES:

- ① THE EXISTING 40 FOOT WOOD POWER POLE TO BE REMOVED AND REPLACED WITH A 65 FOOT WOOD POWER POLE BY COMMONWEALTH EDISON PRIOR TO INSTALLATION OF THE TEMPORARY TRAFFIC SIGNAL.
- ② THE CONTRACTOR SHALL INSTALL (2)2" CONDUIT WITH THREADED CAP FOR FUTURE CITY OF WAUKEGAN ROADWAY LIGHTING PROJECT. THE CONDUITS SHALL BE INSTALLED WITH ONE STUBBED TO THE EAST AND THE OTHER STUBBED TO THE WEST. BOTH TYPE E FOUNDATIONS ARE LOCATED ON THE NORTHWEST AND SOUTHEAST CORNERS (TYPICAL). THE COST OF THE 2 STUBS SHALL BE INCLUDED IN THE PRICE OF THE CONCRETE FOUNDATION, TYPE E, 36-INCH DIAMETER.
- ③ ALL EXISTING REGULATORY SIGNS, WARNING SIGNS, AND INFORMATIONAL SIGNS THAT HAVE BEEN RELOCATED TO THE TEMPORARY TRAFFIC SIGNALS SHALL BE RELOCATED SECURELY TO THE PERMANENT TRAFFIC SIGNAL MAST ARM POLE OR POST AS DIRECTED BY THE ENGINEER. THE COST FOR THE RELOCATION OF THE EXISTING SIGNS SHALL BE INCLUDED IN THE PRICE FOR TRAFFIC CONTROL AND PROTECTION (SPECIAL).

ITEM	STATION	OFFSET	POSSIBLE UTILITY CONFLICT
H-1	226+9.7	31.8' LT	
H-2	225+87.4	0.2' LT	
H-3	223+42.9	27.7' RT	
H-4	225+97.5	31.7' RT	STOREFRONT DOOR
H-5	226+32.3	51.8' RT	
H-6	226+51.4	42.0' RT	
H-7	226+79.3	1.0' RT	
H-8	229+23.3	27.7' LT	
H-9	226+64.2	73.0' LT	
H-10	226+35.1	51.6' LT	
H-11	226+66.3	36.8' LT	
P-1	226+12.2	40.3' LT	
P-2	225+91.9	31.0' RT	STOREFRONT DOOR
P-3	226+77.1	31.3' LT	R.O.W.
MA-1	225+99.5	32.0' LT	
MA-2	226+2.0	40.0' RT	BUILDING
MA-3	226+58.0	36.0' RT	BUILDING, OVERHEAD CABLES
MA-4	226+69.4	38.5' LT	GAS STATION, O.H. CABLES

NOTE: THE LUMINAIRE ARM SHALL BE TWENTY (20) FEET IN LENGTH.

GHA #4136.800

FILE NAME = 4136.800-TR2.dwg

USER NAME = GHA
 PLOT SCALE = 1" = .0833'
 PLOT DATE = 3/10/10

DESIGNED - JRD
 DRAWN - ZCW
 CHECKED - DPB
 DATE - 3/10/10

REVISED -
 REVISED -
 REVISED -
 REVISED -



TRAFFIC SIGNAL MODERNIZATION PLAN
GRAND AVENUE AT JACKSON STREET
 SCALE: 1"=20'
 SHEET NO. OF SHEETS STA. TO STA.

F.A.P. RTE.	SECTION	COUNTY	TOTAL SHEETS	SHEET NO.
541	08-00279-00-TL	LAKE	64	31

CONTRACT #: 63436
 ILLINOIS FED. AID PROJECT