

**LEGEND**

- STREET NAME SIGN
- COMBINATION CONCRETE CURB & GUTTER, TYPE B-6.12 OR TYPE B-6.24
- PORTLAND CEMENT CONCRETE SIDEWALK, 5"
- DETECTABLE WARNING
- LED ILLUMINATED STREET NAME SIGN
- BRICK PAVER REINSTALLATION

**PROPOSED**

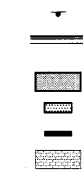

**WEST STREET**

**Restoration of Work Area.** Restoration of the traffic signal work area shall be incidental to the related pay items such as foundation, conduit, handhole, trench and backfill, etc., and no extra compensation shall be allowed. All roadway surfaces such as shoulders, medians, sidewalks, pavement, etc. shall be replaced in kind. All damage to mowed lawns shall be replaced with an approved sod, and all damage to unmowed fields shall be seeded in accordance with Standard Specifications 252 and 250 respectively.

THE TRAFFIC SIGNAL CONTROL EQUIPMENT FOR THIS PROJECT SHALL BE "NTCIP" COMPLIANT.

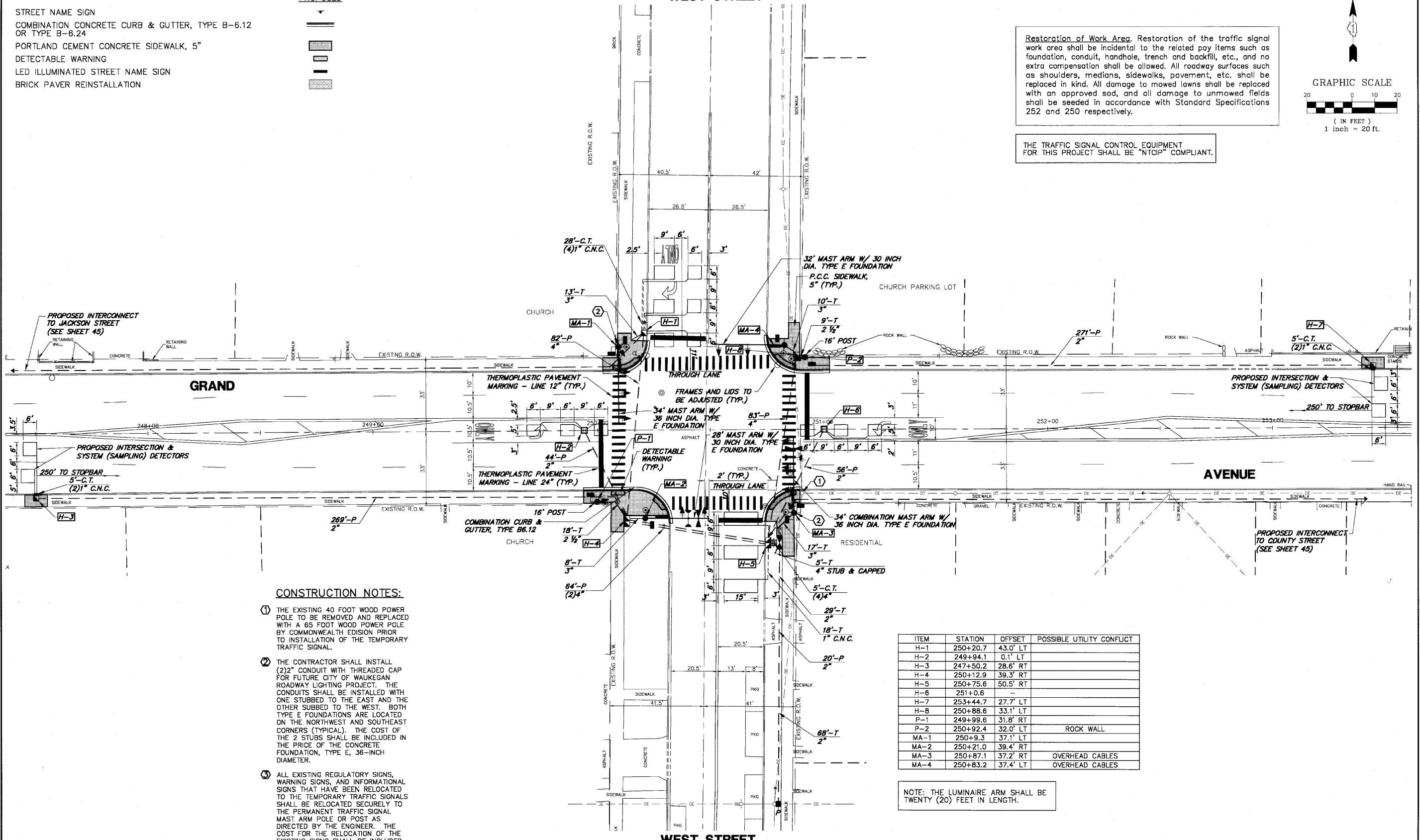
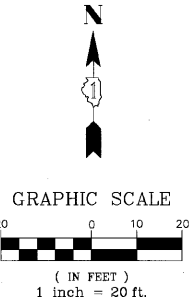

**CONSTRUCTION NOTES:**

- 1 THE EXISTING 40 FOOT WOOD POWER POLE TO BE REMOVED AND REPLACED WITH A 65 FOOT WOOD POWER POLE BY COMMONWEALTH EDISON PRIOR TO INSTALLATION OF THE TEMPORARY TRAFFIC SIGNAL.
- 2 THE CONTRACTOR SHALL INSTALL (2) 2" CONDUIT WITH THREADED CAP FOR FUTURE CITY OF WAUKEGAN ROADWAY LIGHTING PROJECT. THE CONDUITS SHALL BE INSTALLED WITH ONE STUBBED TO THE EAST AND THE OTHER STUBBED TO THE WEST. BOTH TYPE E FOUNDATIONS ARE LOCATED ON THE NORTHWEST AND SOUTHEAST CORNERS (TYPICAL). THE COST OF THE 2 STUBS SHALL BE INCLUDED IN THE PRICE OF THE CONCRETE FOUNDATION, TYPE E, 36-INCH DIAMETER.
- 3 ALL EXISTING REGULATORY SIGNS, WARNING SIGNS, AND INFORMATIONAL SIGNS THAT HAVE BEEN RELOCATED TO THE TEMPORARY TRAFFIC SIGNALS SHALL BE RELOCATED SECURELY TO THE PERMANENT TRAFFIC SIGNAL MAST ARM POLE OR POST AS DIRECTED BY THE ENGINEER. THE COST FOR THE RELOCATION OF THE EXISTING SIGNS SHALL BE INCLUDED IN THE PRICE FOR TRAFFIC CONTROL AND PROTECTION (SPECIAL).

ITEM	STATION	OFFSET	POSSIBLE UTILITY CONFLICT
H-1	250+20.7	43.0' LT	
H-2	249+94.1	0.1' LT	
H-3	247+50.2	28.6' RT	
H-4	250+12.9	39.3' RT	
H-5	250+75.6	50.5' RT	
H-6	251+0.6	-	
H-7	253+44.7	27.7' LT	
H-8	250+88.6	33.1' LT	
P-1	249+99.6	31.8' RT	
P-2	250+82.4	32.0' LT	ROCK WALL
MA-1	250+9.3	37.1' LT	
MA-2	250+21.0	39.4' RT	OVERHEAD CABLES
MA-3	250+87.1	37.2' RT	OVERHEAD CABLES
MA-4	250+83.2	37.4' LT	OVERHEAD CABLES

NOTE: THE LUMINAIRE ARM SHALL BE TWENTY (20) FEET IN LENGTH.

GHA #4136.800

FILE NAME = 4136.800-TR2.dwg	USER NAME = GHA	DESIGNED - JRD	REVISED -		<b>TRAFFIC SIGNAL MODERNIZATION</b>		F&P RTE. 541	SECTION 08-00279-00-TL	COUNTY LAKE	TOTAL SHEETS 64	SHEET NO. 35
	PLOT SCALE = 1" = .0833'	DRAWN - ZCW	REVISED -		<b>GRAND AVENUE AT WEST STREET</b>		SHEET NO. OF SHEETS	STA. TO STA.	CONTRACT #: 63436		ILLINOIS FED. AID PROJECT
	PLOT DATE = 3/10/10	CHECKED - DPB	REVISED -		SCALE: 1"=20'						
		DATE - 3/10/10	REVISED -								