

FILE NAME = S:\JOLI\1980-1995\1982\082\Wadsworth\Plan Sheets\UL-int-1-light.dgn

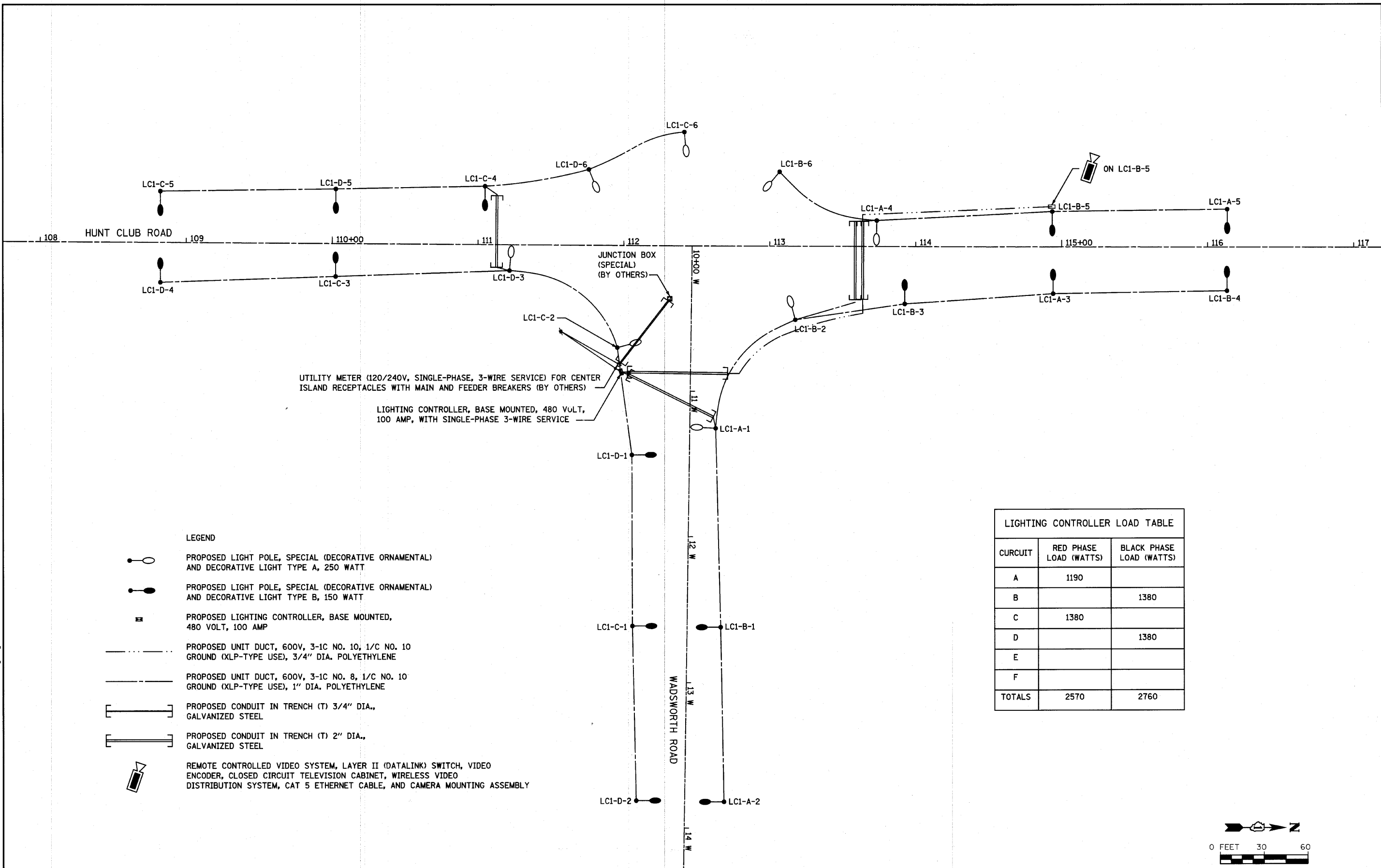

UTILITY METER (120/240V, SINGLE-PHASE, 3-WIRE SERVICE) FOR CENTER ISLAND RECEPTACLES WITH MAIN AND FEEDER BREAKERS (BY OTHERS)

LIGHTING CONTROLLER, BASE MOUNTED, 480 VOLT, 100 AMP, WITH SINGLE-PHASE 3-WIRE SERVICE

- LEGEND**
- PROPOSED LIGHT POLE, SPECIAL (DECORATIVE ORNAMENTAL) AND DECORATIVE LIGHT TYPE A, 250 WATT
  - PROPOSED LIGHT POLE, SPECIAL (DECORATIVE ORNAMENTAL) AND DECORATIVE LIGHT TYPE B, 150 WATT
  - PROPOSED LIGHTING CONTROLLER, BASE MOUNTED, 480 VOLT, 100 AMP
  - PROPOSED UNIT DUCT, 600V, 3-1C NO. 10, 1/C NO. 10 GROUND (XLP-TYPE USE), 3/4" DIA. POLYETHYLENE
  - PROPOSED UNIT DUCT, 600V, 3-1C NO. 8, 1/C NO. 10 GROUND (XLP-TYPE USE), 1" DIA. POLYETHYLENE
  - PROPOSED CONDUIT IN TRENCH (T) 3/4" DIA., GALVANIZED STEEL
  - PROPOSED CONDUIT IN TRENCH (T) 2" DIA., GALVANIZED STEEL
  - REMOTE CONTROLLED VIDEO SYSTEM, LAYER II (DATALINK) SWITCH, VIDEO ENCODER, CLOSED CIRCUIT TELEVISION CABINET, WIRELESS VIDEO DISTRIBUTION SYSTEM, CAT 5 ETHERNET CABLE, AND CAMERA MOUNTING ASSEMBLY

CIRCUIT	RED PHASE LOAD (WATTS)	BLACK PHASE LOAD (WATTS)
A	1190	
B		1380
C	1380	
D		1380
E		
F		
TOTALS	2570	2760

