

- NOTES:
1. THE CITY OF WEST CHICAGO WILL PROVIDE AND ERECT FIVE WORK ZONE SPEED LIMIT (25 MPH) SIGN ASSEMBLIES.
 2. SEE DISTRICT 1 DETAILS AND IDOT STATEWIDE STANDARDS FOR ADDITIONAL INFORMATION ON SIGN PLACEMENT AND SPACING.

LEGEND:

	WORK ZONE
	TRAFFIC FLOW
	TYPE II BARRICADE OR DRUM WITH LIGHTS
	TYPE III BARRICADE WITH LIGHTS
	TEMPORARY SIGN
	EX SIGN TO BE COVERED

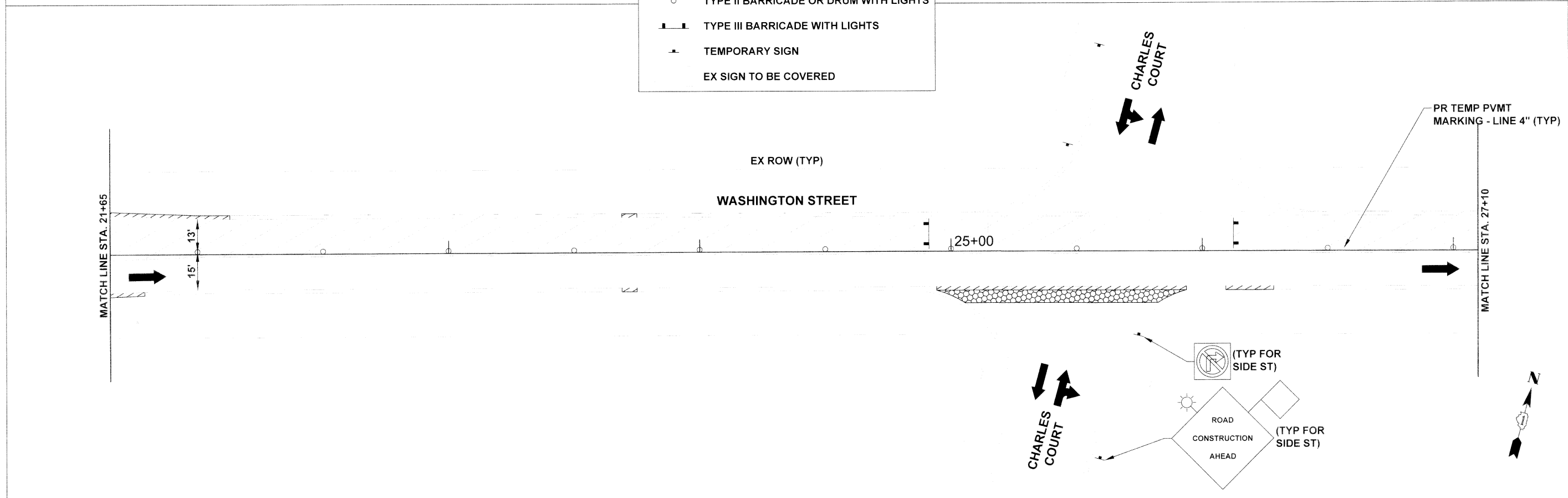

FILE NAME = 24-49_MOT Detour and Plan Sheets_Washington	DESIGNED - BLP	REVISED -	STATE OF ILLINOIS DEPARTMENT OF TRANSPORTATION	WASHINGTON STREET - IL RTE 38 TO IL RTE 59 MAINTENANCE OF TRAFFIC PLAN SHEET - STAGE 1	F.A.U. RTE. 1397	SECTION 09-00076-00-RP	COUNTY DUPAGE	TOTAL SHEETS 61	SHEET NO. 27		
PLOT DATE = 8/02/10	DRAWN - BLP	REVISED -			SCALE: 1" = 20'	STA. 16+50 TO STA. 27+10	FED. ROAD DIST. NO. 1	ILLINOIS	FED. AID PROJECT M-9003(707)	CONTRACT NO. 63513	
thomas engineering group, llc 238 south kennilworth avenue suite 100 oak park, il 60302 phone: 708-533-1700	CHECKED - KCV	REVISED -									
8/02/10	DATE - 08/02/10	REVISED -									