

NOTE:
ALL PAVEMENT MARKING SHALL BE URETHANE, EXCEPT STOP BARS AND LETTERS AND SYMBOLS.

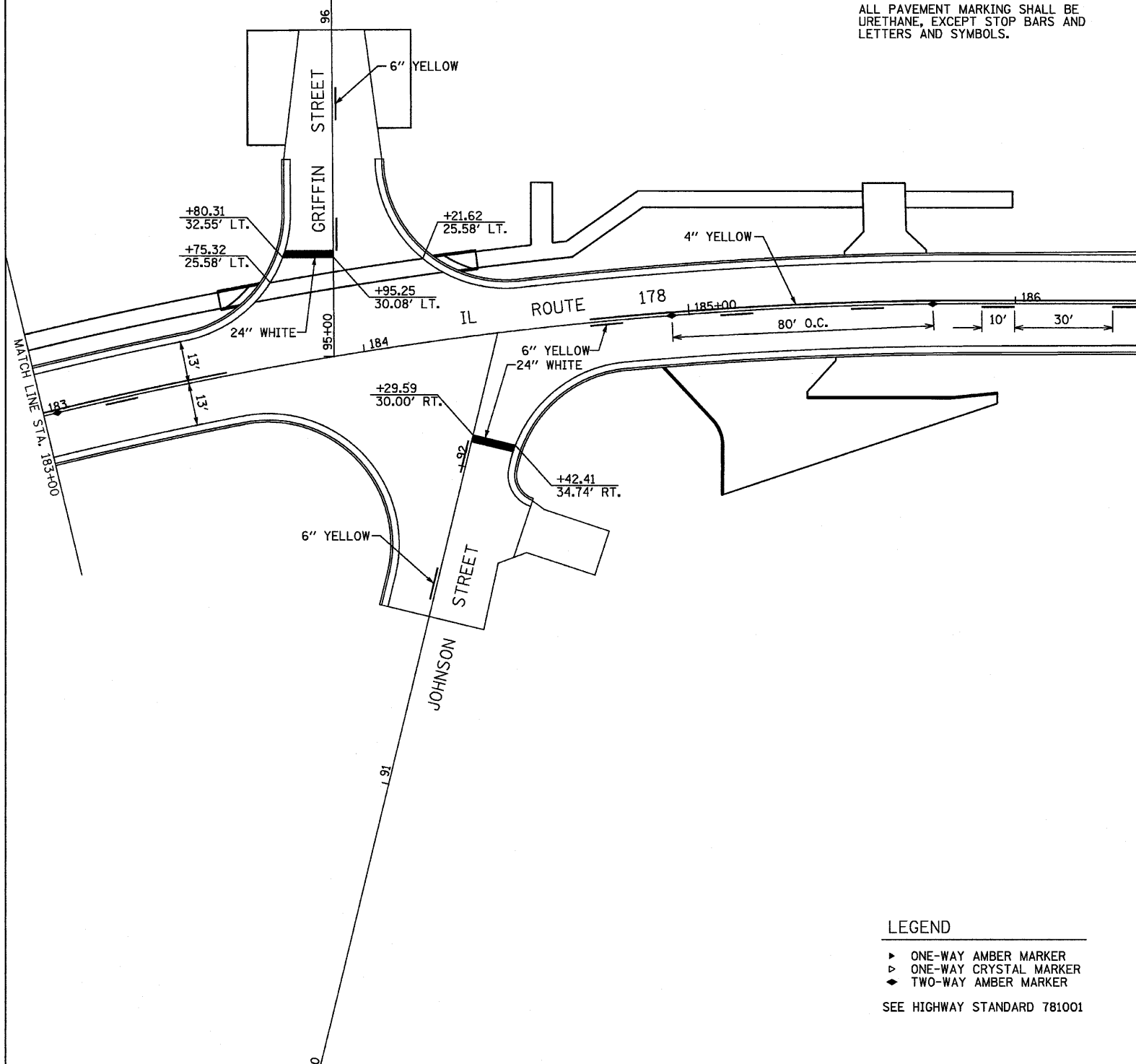

LEGEND

- ▶ ONE-WAY AMBER MARKER
 - ▷ ONE-WAY CRYSTAL MARKER
 - ◆ TWO-WAY AMBER MARKER
- SEE HIGHWAY STANDARD 781001

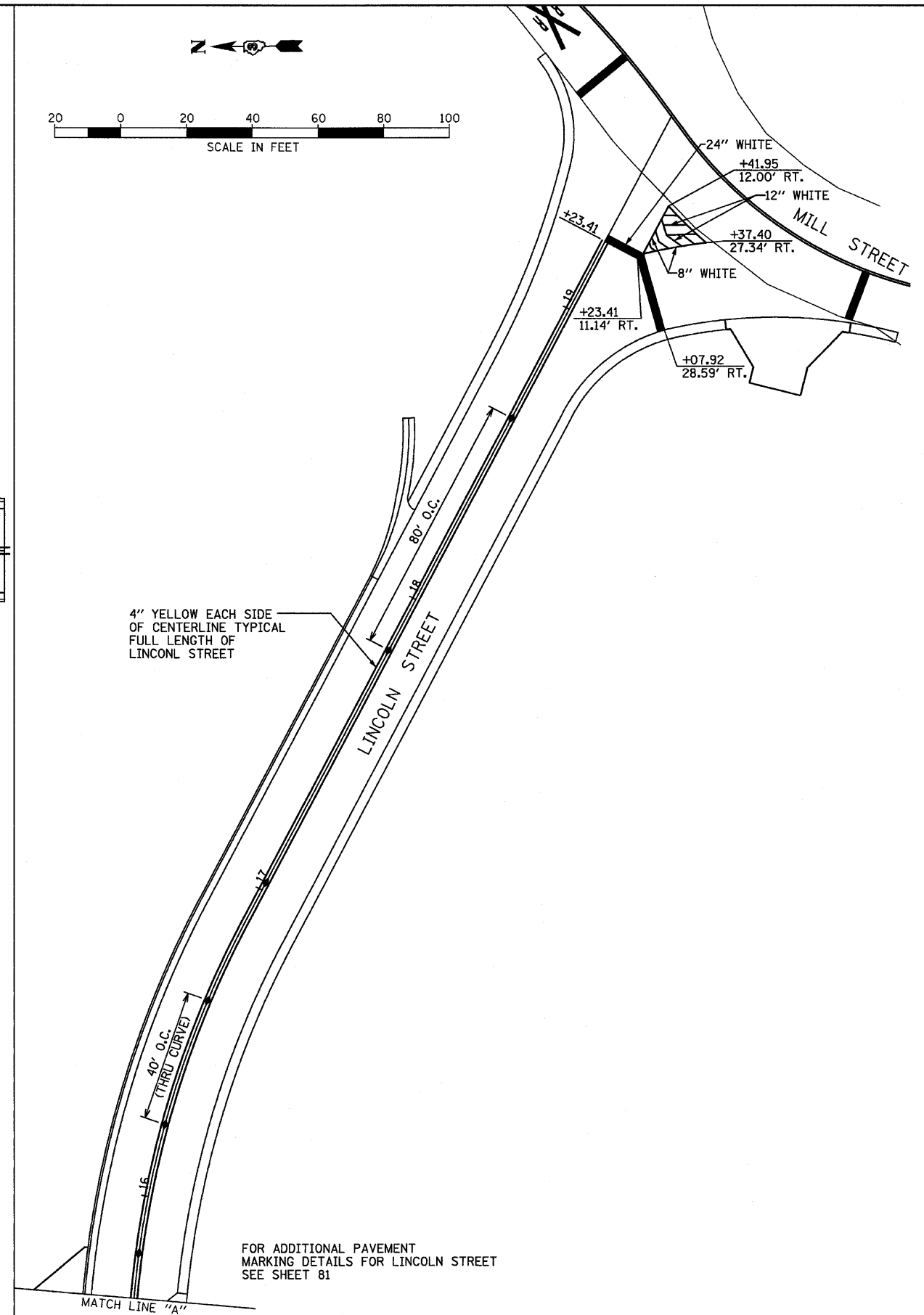
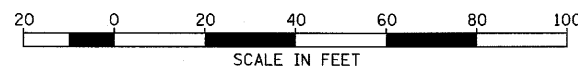
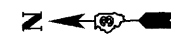

4" YELLOW EACH SIDE OF CENTERLINE TYPICAL FULL LENGTH OF LINCOLN STREET

FOR ADDITIONAL PAVEMENT MARKING DETAILS FOR LINCOLN STREET SEE SHEET 81

MATCH LINE "A"

| | | | |
|------------------------------------|-----------------|----------------|---------------|
| FILE NAME = D366547-SHT-FMK.DGN | USER NAME = --- | DESIGNED - JKC | REVISED - --- |
| | | DRAWN - LAG | REVISED - --- |
| | | CHECKED - JKC | REVISED - --- |
| | | DATE - 08/10 | REVISED - --- |

| | |
|----------------|---------------|
| DESIGNED - JKC | REVISED - --- |
| DRAWN - LAG | REVISED - --- |
| CHECKED - JKC | REVISED - --- |
| DATE - 08/10 | REVISED - --- |

STATE OF ILLINOIS
DEPARTMENT OF TRANSPORTATION

IL RTE 178 (RELOCATED)
PAVEMENT MARKING PLANS

SCALE: 1"=20' SHEET NO. ___ OF ___ SHEETS STA. 183+00 TO STA. 186+38.02

| | | | | |
|---|-----------------|-------------------|---------------------|-----------------|
| F.A.S. RTE. 1279 | SECTION 6R,B | COUNTY LASALLE | TOTAL SHEETS 190 | SHEET NO. 84 |
| CONTRACT NO. 66547 | | | | |
| FED. ROAD DIST. NO. - [ILLINOIS] FED. AID PROJECT | | | | |