

- PRE-STAGE**
- PERFORM STORM SEWER INSTALLATION BETWEEN STA 476+95.21, 29' RT TO STA. 477+23.12, 2' LT AND INSTALL A TEMPORARY STORM SEWER PLUG AT THE UPSTREAM END OF THE PIPE. THIS WORK SHALL BE DONE UNDER TRAFFIC CONTROL AND PROTECTION STANDARD 701501. COMPLETELY BACK FILL STORM SEWER TRENCHES AT THE END OF WORK DAY AND OPEN TRAFFIC TO BOTH LANES.
 - RELOCATE THE MAILBOX AT STA 476+94.00 LT TO THE PROPOSED MAILBOX LOCATION.
 - CONSTRUCT THE TEMPORARY ACCESS ROAD.

- STAGE I**
- TRAFFIC CONTROL SHALL BE PROVIDED AS SHOWN HEREIN AND IN ACCORDANCE WITH THE TRAFFIC CONTROL STANDARD 701321. THE COST OF THE TYPE III BARRICADES AND DRUMS WITH STEADY BURNING LIGHTS SHALL BE INCLUDED WITH STANDARD 701321.
 - ACCESS TO THE EXISTING BUSINESS AND RESIDENCE SHALL BE MAINTAINED BY THE USE OF THE TEMPORARY ACCESS ROAD.
 - THE WIDTH RESTRICTION SIGNS SHALL BE POSTED AT 8'-6".
 - PROVIDE TEMPORARY BRIDGE TRAFFIC SIGNALS.
 - PROVIDE TEMPORARY CONCRETE BARRIERS.
 - ACTIVATE TEMPORARY BRIDGE TRAFFIC SIGNALS AND DIVERT TRAFFIC TO THE STAGE I TRAFFIC LANE.
 - REMOVE THE PORTION OF THE EXISTING BRIDGE NORTH OF THE STAGE REMOVAL LINE.
 - REMOVE THE PORTION OF THE EXISTING PAVEMENT NORTH OF THE STAGE REMOVAL LINE IN ACCORDANCE WITH THE APPROPRIATE STAGE.
 - CONSTRUCT THE PORTION OF THE BRIDGE NORTH OF THE STAGE CONSTRUCTION LINE.
 - CONSTRUCT THE PORTION OF THE APPROACH SLAB AND FOOTING NORTH OF THE STAGE CONSTRUCTION LINE.
 - CONSTRUCT THE PORTION OF THE PROJECT (ROADWAY, DRAINAGE ELEMENTS, ETC.) NORTH OF THE STAGE CONSTRUCTION LINE.
 - CONSTRUCT THE WEST HALF OF THE ENTRANCE AT STA 476+97 LT.
 - PLACE TEMPORARY RAMPS AT THE ENDS OF THE NEW BRIDGE APPROACH SLABS PRIOR TO SWITCHING THE STAGE II TRAFFIC LANE.
- POST-STAGE**
- REMOVE 3" OF THE TEMPORARY ACCESS ROAD AGGREGATE AND PLACE 3" OF ASPHALT. PAID FOR AS INCIDENTAL HMA SURFACING. COORDINATE WITH DRIVE LOCATION.
 - CONSTRUCT THE ENTRANCES AT STA 476+97 (EAST), STA 478+34.8 AND STA 479+57.6.

- NOTES:**
- SEE PREVIOUS SHEET FOR STAGE I ROADWAY TYPICAL SECTIONS.
 - FOR DETAILS NOT SHOWN SEE HIGHWAY STANDARD 701321

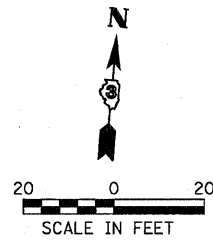
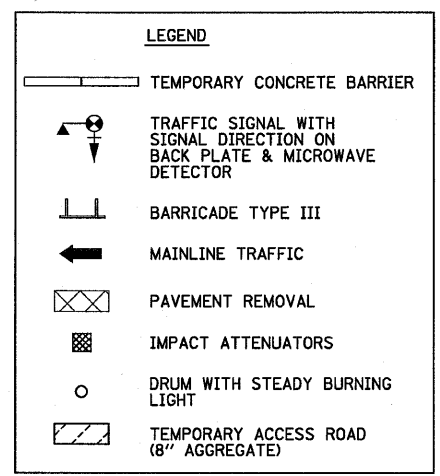

FILE NAME =	USER NAME = #USER#	DESIGNED - JML	REVISED -	STATE OF ILLINOIS DEPARTMENT OF TRANSPORTATION	STAGE I CONSTRUCTION	F.A.P. RTE. 317	SECTION (25)BR-2	COUNTY LIVINGSTON	TOTAL SHEETS 58	SHEET NO. 19	
#FILEL#	PLOT SCALE = #SCALE#	DRAWN - JJO	REVISED -			SCALE:	SHEET NO. OF SHEETS	STA. TO STA.	FED. ROAD DIST. NO. [ILLINOIS]	FED. AID PROJECT	CONTRACT NO. 66823
	PLOT DATE = #DATE#	CHECKED - MSW	REVISED -								
		DATE - 08/13/10	REVISED -								