

STATE OF ILLINOIS
DEPARTMENT OF TRANSPORTATION

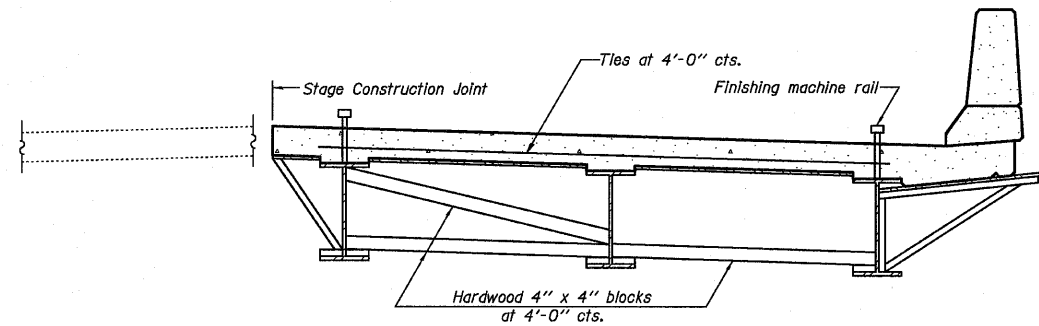

**FORM BRACES FOR
STAGE CONSTRUCTION**

When cantilever forming brackets are used, the work shall be done according to Article 503.06(b) of the Standard Specifications, except as modified below and in the details shown on this sheet.
The finishing machine rolls shall be placed on the top flange of the exterior beams.
The beams or girders, supporting cantilever forming brackets, shall be tied together at 4 foot intervals.
For Standard construction, or Stage Construction the Hardwood bracing materials shall be placed as shown between webs of beams in each bay.

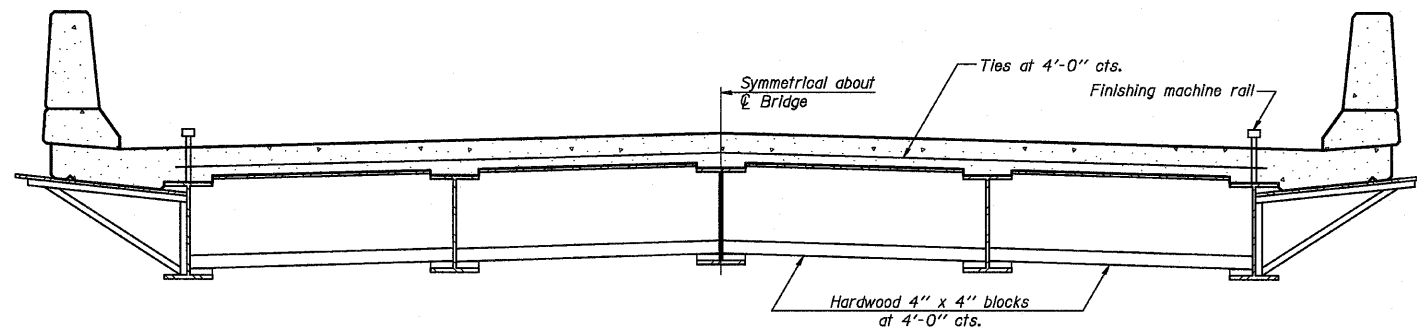

**FORM BRACES FOR
STANDARD CONSTRUCTION**

DESIGNED	SDH
CHECKED	JML
DRAWN	DJM
CHECKED	MSW

SB-1

11-1-09

DATE 08/13/10

**CANTILEVER FORMING BRACKETS
FOR SUPERSTRUCTURES WITH
W27 BEAMS AND SMALLER
STRUCTURE NO. 053-0188**

Farnsworth GROUP, INC. 2709 McGraw Drive Bloomington, Illinois 61704 309/663-8435, 309/663-1571 fax	SHEET NO. B23	F.A.P. RTE.	SECTION	COUNTY	TOTAL SHEETS	SHEET NO.
	26 SHEETS	317	(25)BR-2	LIVINGSTON	58	46
FED. ROAD DIST. NO. ILLINOIS FED. AID PROJECT					CONTRACT NO. 66823	