

CONTROL POINT @ S.E. QUADRANT
OF IL RTE. 116 AND IL RTE. 115
N = 1534086.941
E = 1019645.797
ELEV = 658.003

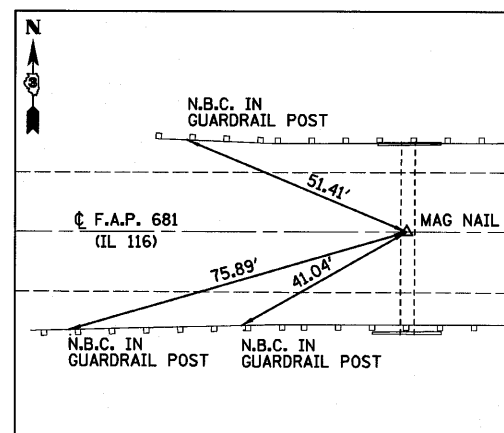

IL 116
STA 22+17.31
N = 1534229.923
E = 1021789.063

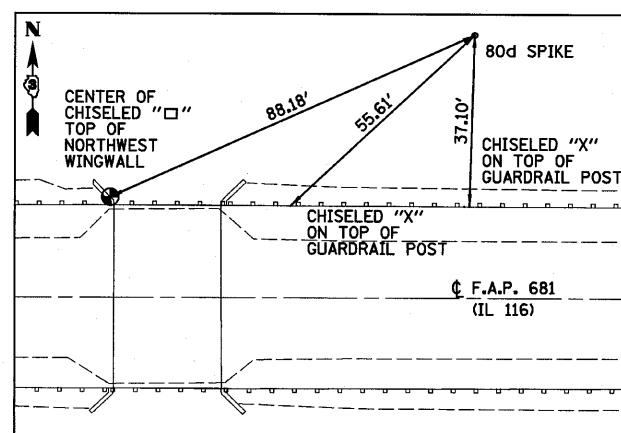

CONTROL POINT
STA 27+31.62, 58.26' LT
N = 1534303.011
E = 1022301.473
ELEV = 657.814

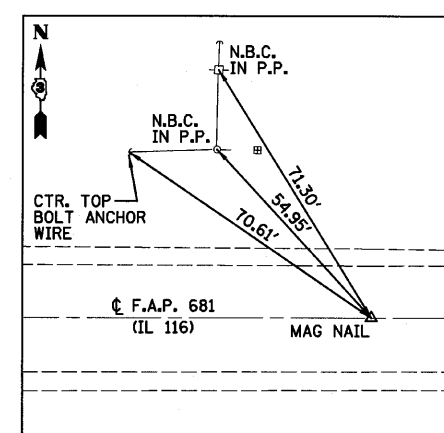

IL 116
STA 31+00.00
N = 1534255.414
E = 1022671.382

BENCHMARK
STA 26+51, 22' LT
CHISELED "X" ON
N.W. WINGWALL
ELEV=659.54

BENCHMARK
STA 30+63, 40' LT
RAILROAD SPIKE
IN POWER POLE
ELEV=657.43

FILE NAME =	USER NAME = #USER#	DESIGNED - JML	REVISED -	STATE OF ILLINOIS DEPARTMENT OF TRANSPORTATION	ALIGNMENT, SURVEY TIES AND BENCHMARKS			F.A.P. RTE.	SECTION	COUNTY	TOTAL SHEETS	SHEET NO.
#FILE#		DRAWN - DJM	REVISED -					681	*	FORD/IROQUOIS	146	21
PLOT SCALE = #SCALE#		CHECKED - MSW	REVISED -					SN 027-2018			CONTRACT NO. 66880	
PLOT DATE = #DATE#		DATE - 08/04/10	REVISED -					SCALE:	SHEET NO. OF SHEETS	STA. TO STA.	FED. ROAD DIST. NO. ILLINOIS FED. AID PROJECT	

FARNSWORTH GROUP, INC.

CONSULTING ENGINEERS - 2709 MCGRAW DRIVE BLOOMINGTON, ILLINOIS 61704 (309) 663-8435 / (309) 663-1571 FAX

* 116 BR/116 SR, (BR-2)BR, I & BR-3J

24-8271