

CONTROL POINT
 STA 80+31.00, 23.24' RT
 N = 1534385.385
 E = 1027579.285
 ELEV = 657.770

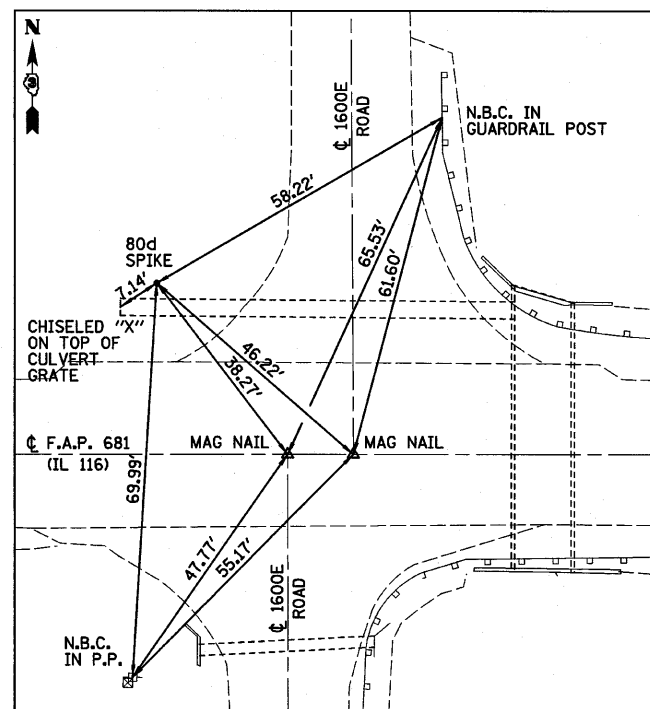

CONTROL POINT
 STA 106+09.07, 30.38' LT
 N = 1534513.177
 E = 1030154.730
 ELEV = 657.056

IL 116
 STA 106+32.17 @
 1600E ROAD (SOUTH)
 N = 1534483.426
 E = 1030178.636

IL 116
 STA 106+43.78 @
 1600E ROAD (NORTH)
 N = 1534483.739
 E = 1030190.248

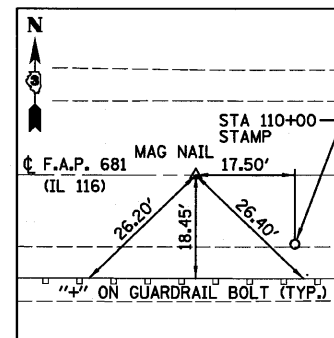

IL 116
 STA 110+00.00
 N = 1534493.361
 E = 1030546.344

BENCHMARK
 STA 106+73, 29' LT
 CHISELED "□" ON
 TOP OF N.W. HEADWALL
 ELEV=658.32

BENCHMARK
 STA 106+05, 40' RT
 RAILROAD SPIKE IN POWER POLE
 S.W. QUADRANT OF IL RTE. 116
 ELEV=657.03

FILE NAME =
 #FILE#

USER NAME = #USER#
 PLOT SCALE = #SCALE#
 PLOT DATE = #DATE#

DESIGNED - JML
 DRAWN - DJM
 CHECKED - MSW
 DATE - 08/04/10

REVISED -
 REVISED -
 REVISED -
 REVISED -

STATE OF ILLINOIS
 DEPARTMENT OF TRANSPORTATION

ALIGNMENT, SURVEY TIES AND BENCHMARKS

SCALE: SHEET NO. OF SHEETS STA. TO STA.

F.A.P. RTE. 681	SECTION *	COUNTY FORD/IROQUOIS	TOTAL SHEETS 146	SHEET NO. 22
SN 027-2553		CONTRACT NO. 66880		
FED. ROAD DIST. NO.		ILLINOIS FED. AID PROJECT		