

CURVE DATA
 PI STA. = 287+00.00
 $\Delta = 0^\circ 20' 56''$ (LT)
 $D = 0^\circ 02' 06''$
 $R = 164,092.42'$
 $T = 499.80'$
 $L = 999.59'$
 $E = 0.76'$
 P.C. STA = 282+00.20
 P.T. STA = 291+99.79

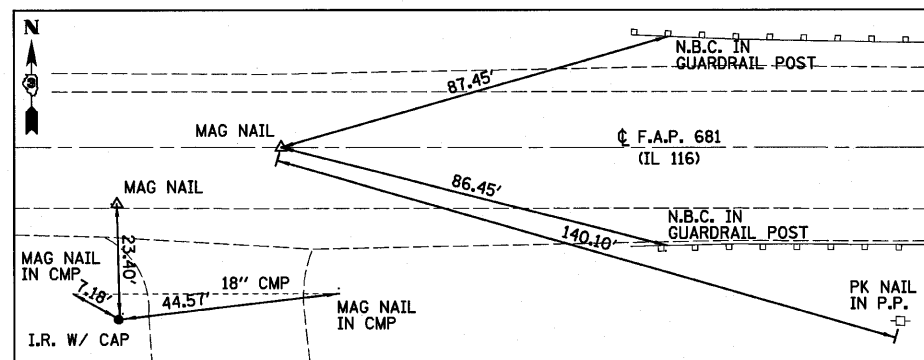

CONTROL POINT
 STA 281+64.70, 35.42' RT
 $N = 1534899.162$
 $E = 1047698.202$
 ELEV = 657.282

IL 116
 STA 282+00.00
 $N = 1534935.239$
 $E = 1047733.038$

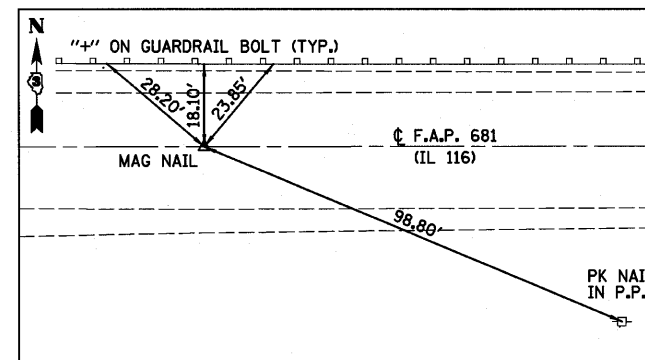

IL 116
 STA 286+00.00
 $N = 1534943.575$
 $E = 1048132.727$

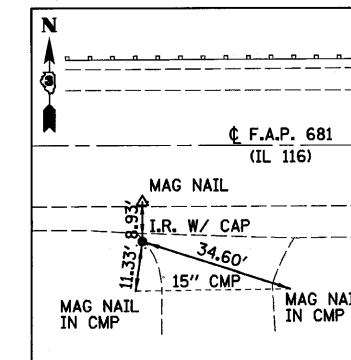

CONTROL POINT
 STA 289+11.10, 21.19' RT
 $N = 1534929.470$
 $E = 1048444.236$
 ELEV = 657.914

BENCHMARK
 STA 283+36, 39' RT
 BOLT IN POWER
 POLE
 ELEV=659.15

BENCHMARK
 STA 283+91, 22' RT
 CHISELED "□" ON
 S.W. WINGWALL
 ELEV=660.04

FILE NAME =	USER NAME = #USER#	DESIGNED - JML	REVISED -
#FILEL#		DRAWN - DJM	REVISED -
	PLOT SCALE = #SCALE#	CHECKED - MSW	REVISED -
	PLOT DATE = #DATE#	DATE - 08/04/10	REVISED -

STATE OF ILLINOIS
 DEPARTMENT OF TRANSPORTATION

ALIGNMENT, SURVEY TIES AND BENCHMARKS

F.A.P. RTE.	SECTION	COUNTY	TOTAL SHEETS	SHEET NO.
681	*	FORD/IROQUOIS	146	26
SN 038-2549		CONTRACT NO. 66880		
FED. ROAD DIST. NO.		ILLINOIS FED. AID PROJECT		