

- 1 = S.N. 027-2018 (PR.) / 027-0043 (EX.)
- 2 = S.N. 027-2553 (PR.) / 027-2528 (EX.)
- 3 = S.N. 027-0100 (PR.) / 027-0045 (EX.)
- 4 = S.N. 027-0098 (PR.) / 027-0046 (EX.)
- 5 = S.N. 038-2549 (PR.) / 038-0173 (EX.)

DETOUR MAP
 *TO BE PLACED WITH INTERSTATE IDENTIFICATION SIGNS AND EXIT SIGNS AND US & ILLINOIS STATE ROUTE MARKERS.

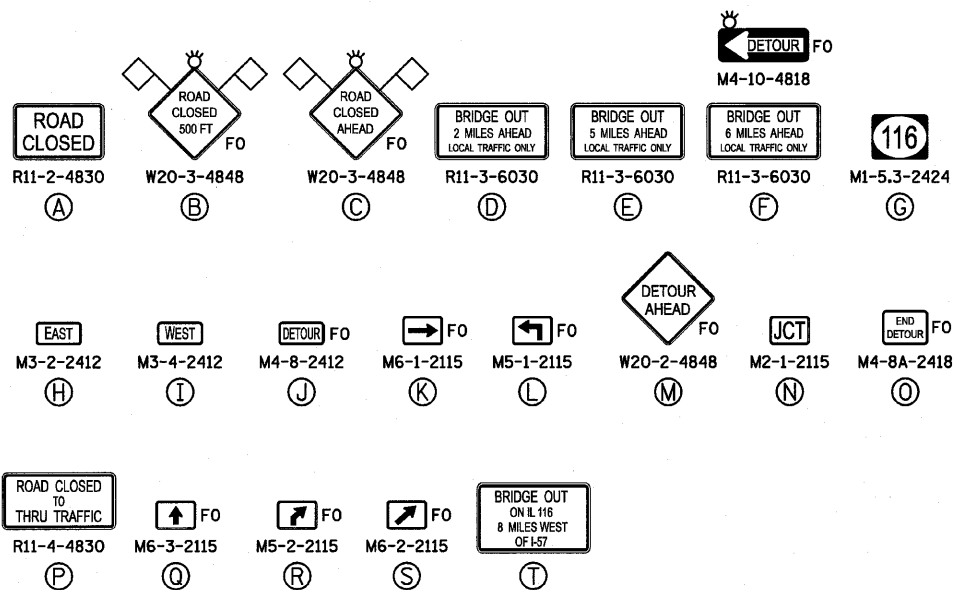

LEGEND

- ⊕ SIGNS ON PERMANENT SUPPORTS
- ⚡ FLASHING LIGHT ABOVE SIGN
- ◊ 18"x18" ORANGE FLAG
- ▨ DETOUR ROUTE
- FO FLORESCENT ORANGE

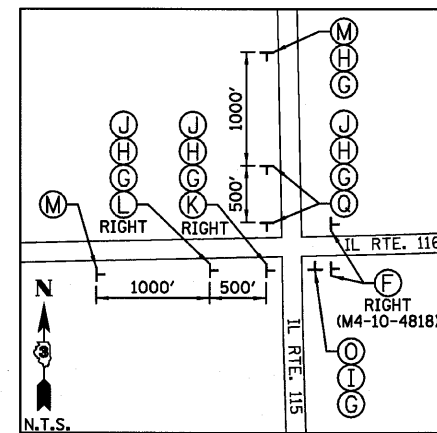

IL RTE. 116 & IL RTE. 115 INTERSECTION (DETAIL "A")

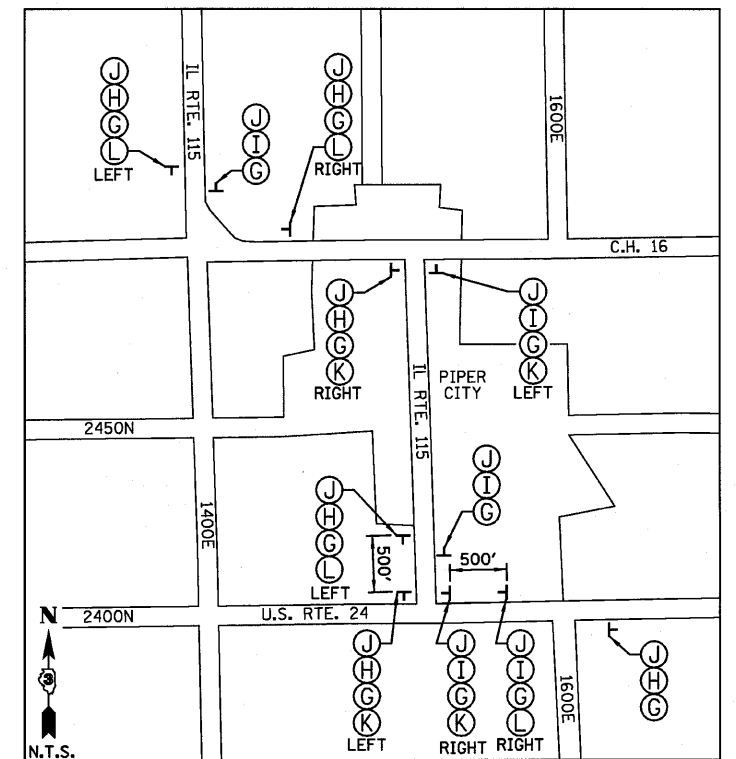

IL RTE. 115 & U.S. RTE. 24 INTERSECTION (DETAIL "B")

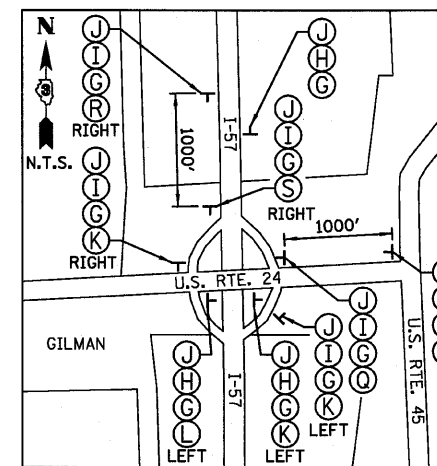

CITY OF GILMAN INTERCHANGE (DETAIL "C")

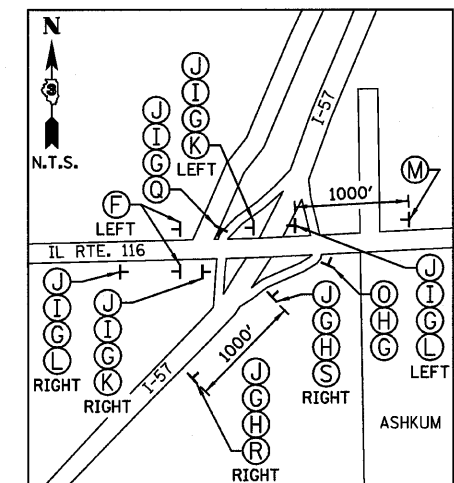

VILLAGE OF ASHKUM INTERCHANGE (DETAIL "D")

NOTES:

- 1.) ALL TRAFFIC CONTROL DEVICES SHALL BE FURNISHED, ERECTED AND MAINTAINED BY THE CONTRACTOR.
- 2.) ALL SIGNS NOT ATTACHED TO BARRICADES SHALL BE POST MOUNTED, UNLESS OTHERWISE NOTED.
- 3.) LOCATIONS OF TRAFFIC CONTROL DEVICES MAY BE ADJUSTED BY THE ENGINEER.
- 4.) WORK SHALL BE DONE IN ACCORDANCE WITH BLR 21.
- 5.) TRAFFIC CONTROL SHALL BE IN ACCORDANCE WITH THE STANDARD SPECIFICATIONS FOR ROAD AND BRIDGE CONSTRUCTION MANUAL FOR UNIFORM TRAFFIC CONTROL, HIGHWAY STANDARDS AND SPECIAL PROVISIONS.
- 6.) COVER ANY SIGNS DENOTING EAST IL ROUTE 116 WITHIN A MILE RADIUS OF THE INTERSECTION BETWEEN IL ROUTE 116 AND IL ROUTE 115. COVER ANY SIGNS DENOTING WEST IL ROUTE 116 WITHIN A MILE RADIUS OF THE I-57 INTERCHANGE.
- 7.) COVER "PONTIAC" ON THE GREEN BOARD SIGNS ON I-57 NORTH AND SOUTH OF THE ASHKUM EXIT AT IL RTE. 116.

FILE NAME =	USER NAME = #USER#	DESIGNED - JML	REVISED -	STATE OF ILLINOIS DEPARTMENT OF TRANSPORTATION	DETOUR PLAN			F.A.P. RTE. 681	SECTION *	COUNTY FORD/IROQUOIS	TOTAL SHEETS 146	SHEET NO. 38	
#FILE#		DRAWN - DJM	REVISED -					CONTRACT NO. 66880					
		CHECKED - MSW	REVISED -										
		DATE - 08/04/10	REVISED -										
FARNSWORTH GROUP, INC.				CONSULTING ENGINEERS - 2709 MCGRAW DRIVE BLOOMINGTON, ILLINOIS 61704 (309) 663-8435 / (309) 663-1571 FAX				SCALE:		SHEET NO. OF SHEETS STA. TO STA.		FED. ROAD DIST. NO. ILLINOIS FED. AID PROJECT * 116 BR/E116 BR, (BR-2)BR, I & BR-3J	