

STATE OF ILLINOIS
DEPARTMENT OF TRANSPORTATION

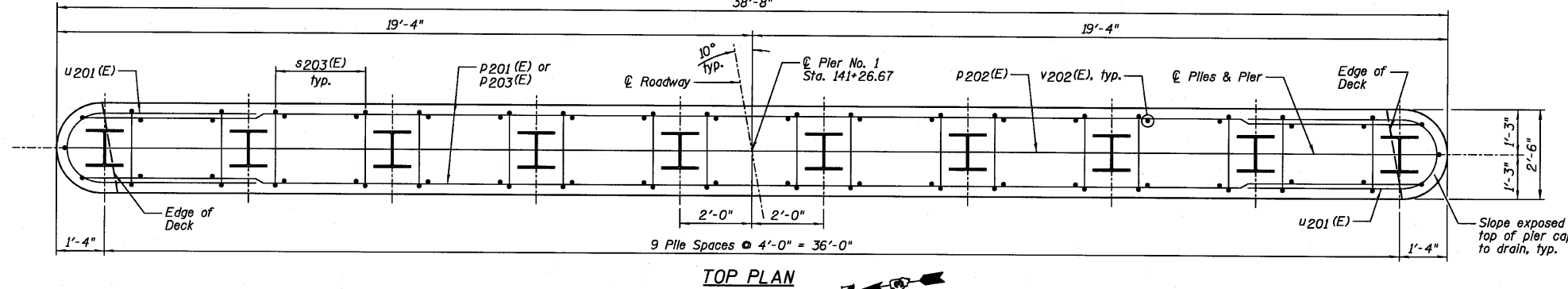

TOP PLAN

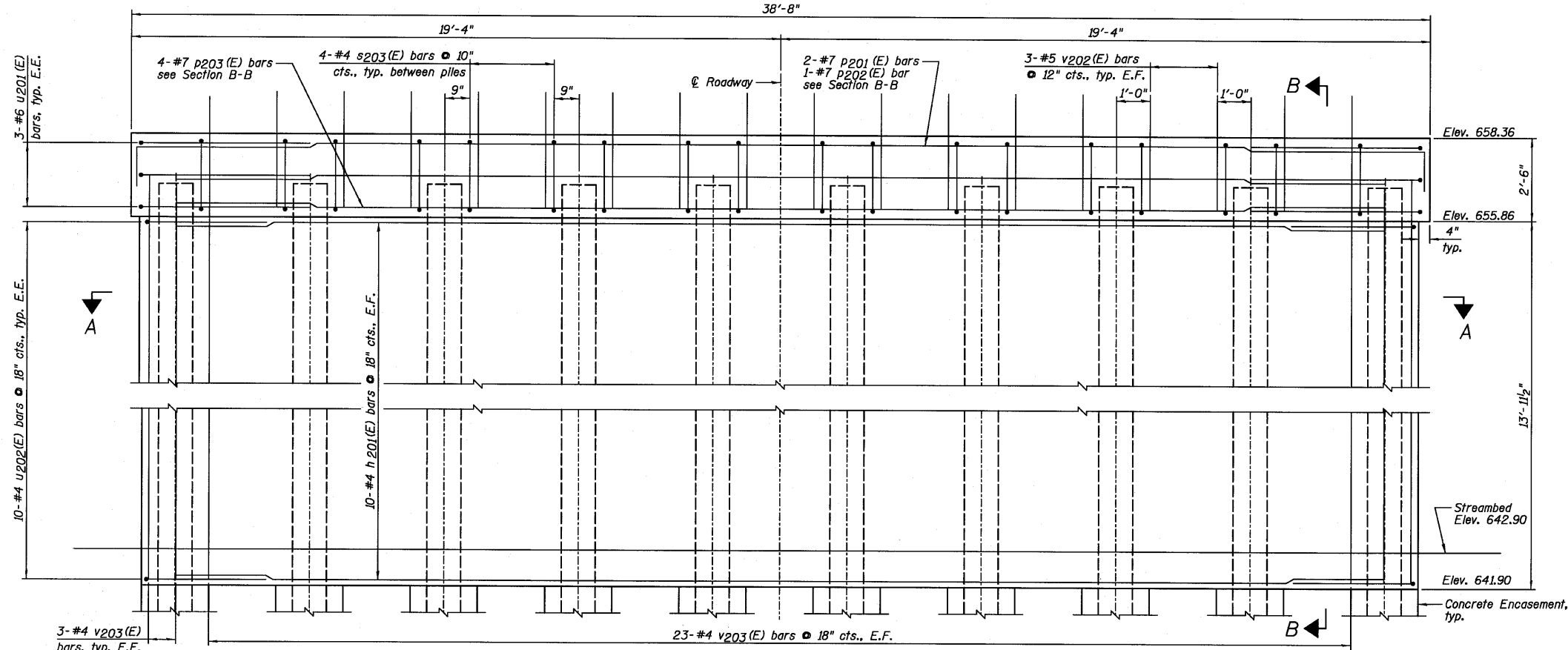

ELEVATION
(Looking East)

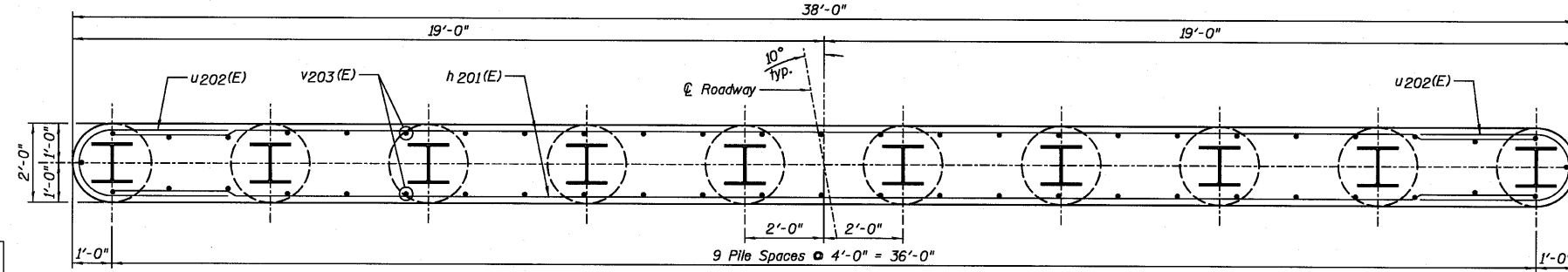

SECTION A-A

PIER NO. 1
BILL OF MATERIAL

Bar	No.	Size	Length	Shape
h201(E)	20	#4	36'-0"	—
P201(E)	2	#7	39'-4"	—
P202(E)	1	#7	40'-6"	—
P203(E)	4	#7	37'-0"	—
s203(E)	36	#4	9'-5"	□
u201(E)	6	#6	12'-3"	—
u202(E)	20	#4	8'-5"	—
v202(E)	54	#5	3'-3"	—
v203(E)	52	#4	15'-1"	—

Item	Unit	Quantity
Structure Excavation	Cu. Yd.	44
Concrete Structures	Cu. Yd.	47.7
Concrete Encasement	Cu. Yd.	3.5
Reinforcement Bars, Epoxy Coated	Pound	2,180
Furnishing Steel Piles HPI2x63	Foot	468
Driving Piles	Foot	468
Test Pile Steel HPI2x63	Each	1
Underwater Structure Excavation Protection - Location 1	Each	1

PILE DATA:

Pile Type and Size	Steel - HPI2x63
Nominal Required Bearing	312 kips
Factored Resistance Available	156 kips
Estimated Pile Length	52 Feet
Number of Production Piles	9
Number of Test Piles	1

NOTES:

- 1.) If a portion of the pier wall or concrete encasement is under water, reinforcement may be placed under water into forms. Concrete shall be tremied according to Article 503.08 of the Standard Specifications to an elevation 1'-0" above the water line at the time of construction.
- 2.) E.F. denotes Each Face and E.E. denotes Each End.
- 3.) See Sheet D15 for Section B-B.

DESIGNED	SDH
CHECKED	JML
DRAWN	JWK/DJM
CHECKED	MSW
DATE	08/04/10

Farnsworth GROUP, INC.
2709 McGraw Drive
Bloomington, Illinois 61704
309/663-8435, 309/663-1571 fax

SHEET NO. D13	F.A.P. RTE.	SECTION	COUNTY	TOTAL SHEETS	SHEET NO.
18 SHEETS	681	*	FORD/IROQUOIS	146	80
FED. ROAD DIST. NO.			ILLINOIS FED. AID PROJECT		
			CONTRACT NO. 66880		

PIER NO. 1
STRUCTURE NO. 027-0100