

STATE OF ILLINOIS
DEPARTMENT OF TRANSPORTATION

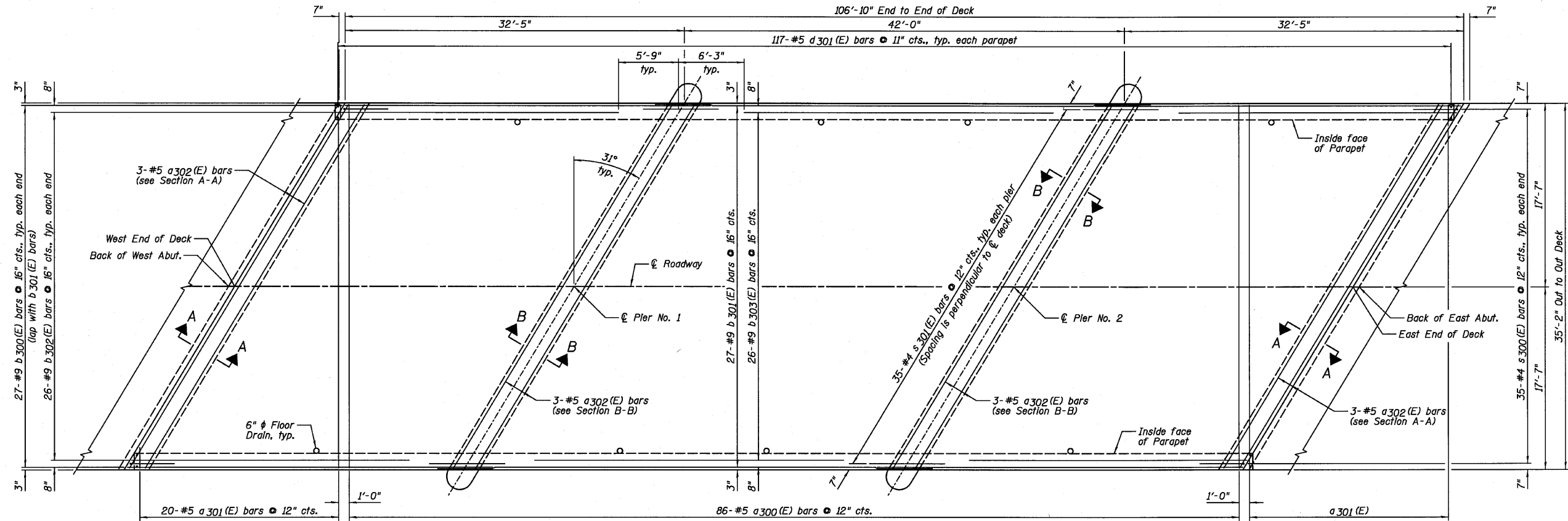

BOTTOM OF SLAB PLAN



BAR LAP
#9 - 5'-3"

DESIGNED	SDH
CHECKED	JML
DRAWN	JWK/DJM
CHECKED	MSW

DATE 08/04/10

NOTES:

- 1.) See Sheet E8 for Superstructure Details and Bill of Material.
- 2.) See Sheet E7 for Sections A-A and B-B.
- 3.) See Sheet E8 for Floor Drain details.
- 4.) Order #5 bars full length. Cut according to Bar Cutting Diagram on Sheet E8. Use remainder of bars in opposite end of deck.

Farnsworth GROUP, INC.
2709 McGraw Drive
Bloomington, Illinois 61704
309/663-8435, 309/663-1571 fax

SHEET NO. E5

18 SHEETS

F.A.P. RTE.	SECTION	COUNTY	TOTAL SHEETS	SHEET NO.
681	*	FORD/IROQUOIS	146	90
FED. ROAD DIST. NO.		ILLINOIS FED. AID PROJECT		
		CONTRACT NO. 66880		

SUPERSTRUCTURE DECK
STRUCTURE NO. 027-0098

* 116 BR/L116 BR, (BR-2)BR, I & BR-3J

24-8271