

F.A.P. RTE.	SECTION	COUNTY	TOTAL SHEETS	SHEET NO.
704	(1)N&T5-1	McLEAN	497	63
STA.	TO STA.			
FED. ROAD DIST. NO.	ILLINOIS FED. AID PROJECT			

CONTRACT NO. 70514



NOT TO SCALE
(TYPICAL)

BENCHMARKS

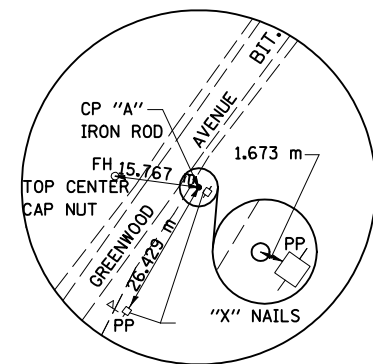

CONTROL POINT "A"
N=415.478
E=2,457.119
ELEV.= 260.484
(.016 m IRON ROD)

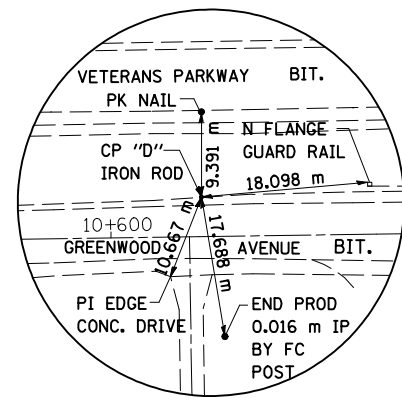

CONTROL POINT "D"
N=1,163.436
E=3,561.305
ELEV.= 253.946
(.016 m IRON ROD)

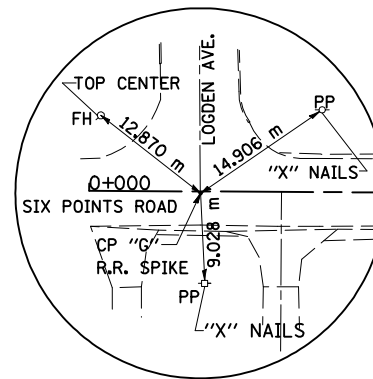

CONTROL POINT "G"
N=1,179.161
E=2,543.197
ELEV.= 248.303
(R.R. SPIKE)

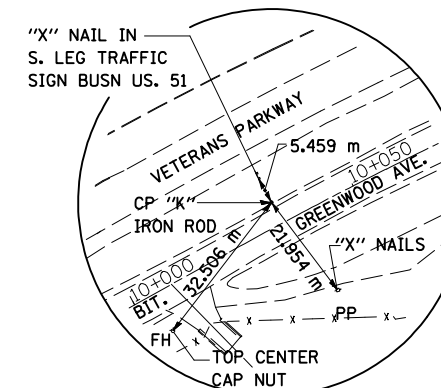

CONTROL POINT "K"
N=1,058.790
E=3,005.301
ELEV.= 251.793
(.016 m IRON ROD)

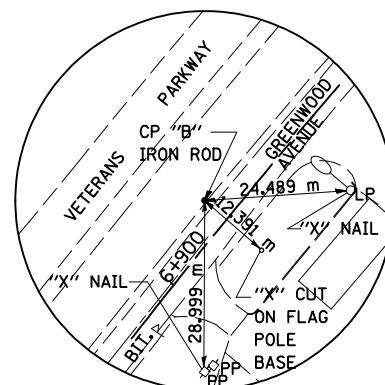

CONTROL POINT "B"
N=835.380
E=2,734.215
ELEV.= 257.468
(.016 m IRON ROD)

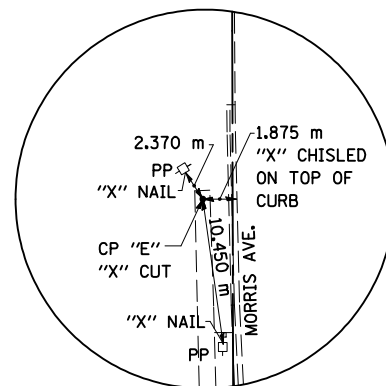

CONTROL POINT "E"
N=990.203
E=2,938.690
ELEV.= 253.445
("X" CUT 0.6 m SOUTH OF NORTH END SIDEWALK)

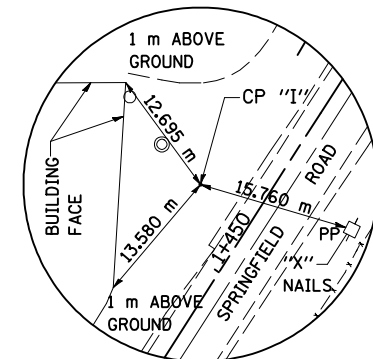

CONTROL POINT "I"
N=1,284.540
E=3,011.495
ELEV.= 251.463
(0.016 m IRON ROD)

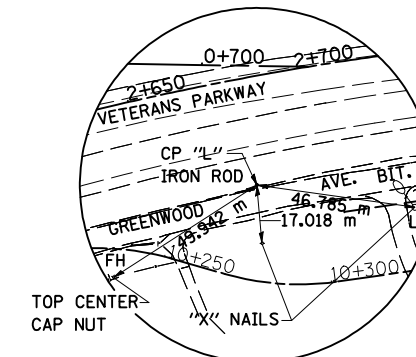

CONTROL POINT "L"
N=1,142.559
E=3,236.718
ELEV.= 251.897
(.016 m IRON ROD)

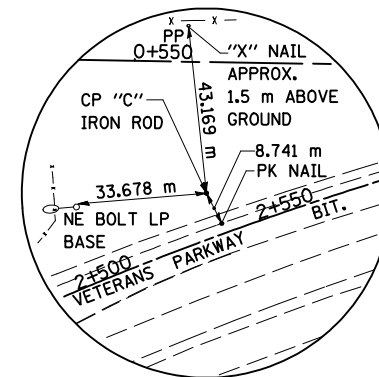

CONTROL POINT "C"
N=1,146.123
E=3,089.035
ELEV.= 252.100
(.016 m IRON ROD)

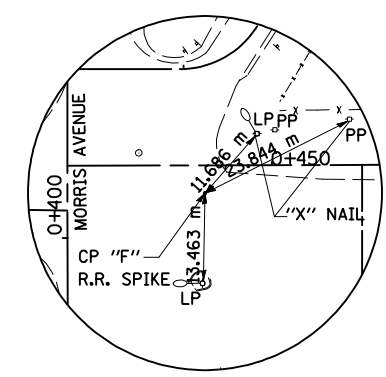

CONTROL POINT "F"
N=1,176.754
E=2,960.704
ELEV.= 251.463
(R.R. SPIKE)

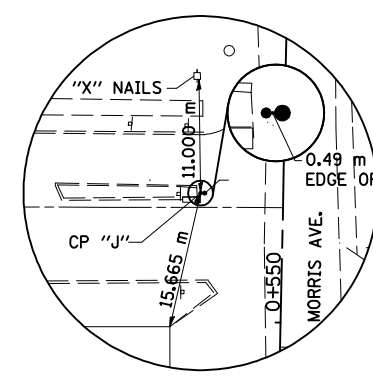

CONTROL POINT "J"
N=1,332.441
E=2,933.977
ELEV.= 251.463
("X" CUT AT END OF ISLAND)

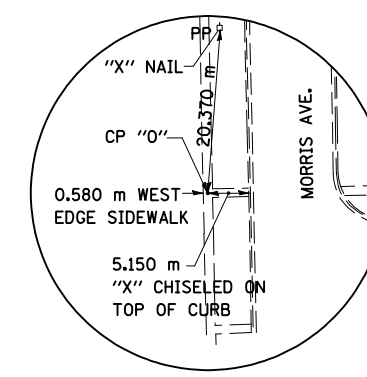

CONTROL POINT "O"
N=787.552
E=2,942.970
ELEV.= 250.923
("X" CUT IN WALK)

- BM USGS "SUNNY" (ELEV.= 259.737)
- BM USGS "SUNNY RM 1" (ELEV.= 260.185)
- BM USGS "SUNNY RM 2" (ELEV.= 260.253)
- TBM 1 "X" CUT ON CENTER BOLT ON HYDRANT NW SIDE GREENWOOD AVE. OPP. 234 GREENWOOD AVE. (ELEV.= 260.863)
- TBM 2 "X" CUT ON CENTER BOLT ON HYDRANT AT NE'RLY. COR. OF GREEN AVE. AND LAESCH ST. (ELEV.= 256.707)
- TBM 3 "X" CUT ON CENTER BOLT ON HYDRANT ON SOUTHEASTERLY SIDE OF GREENWOOD AVE AT LAESCH DAIRY CO. (ELEV.= 257.952)
- TBM 4 "X" CUT IN SW COR. TRAFFIC CONTROL BOX CONC. PAD AT SE. COR INTERSECTION OF VET. PKWY. AND MORRIS AVE. (ELEV.= 251.712)
- TBM 5 "X" CUT ON CENTER BOLT ON HYDRANT ON SOUTHEASTERLY SIDE OF GREENWOOD AVE AT E. SIDE DRIVE AT E. SIDE MAAS RADIATOR (ELEV.= 251.840)
- TBM 6 "X" CUT IN N.W. COR. CONC. INTAKE S. SIDE OF GREENWOOD AVE. AND AT W. EDGE GREENWOOD TRAILER PARK (ELEV.= 249.710)
- TBM 7 "X" CUT ON CENTER BOLT ON HYDRANT ON SOUTHEASTERLY SIDE GREENWOOD AVE. BETWEEN DRIVES FOR 114 GREENWOOD (GREENWOOD MOBILE HOMES) (ELEV.= 254.900)
- TBM 8 TOP S.W. BOLT AT W. LEG CLARK SIGN N.E. CORNER MORRIS AND VETERANS PKWY (ELEV.= 251.750)
- TBM 9 "X" CUT ON CENTER BOLT ON HYDRANT ON NORTHERLY SIDE SPRINGFIELD RD. FIRST HYDRANT WEST OF MORRIS AT SPRINGFIELD RD. (ELEV.= 252.257)
- TBM 10 "X" CUT ON CENTER BOLT ON HYDRANT ON NORTHERLY SIDE SPRINGFIELD RD. AT 2329 SPRINGFIELD RD. (ELEV.= 259.511)
- TBM 11 "X" CUT ON CENTER BOLT ON HYDRANT ON NORTHERLY SIDE SPRINGFIELD RD. IN FRONT OF CARPENTERS LOCAL #63 2002 BEICH RD. (ELEV.= 260.494)
- TBM 12 "X" CUT ON CENTER BOLT ON HYDRANT ON EASTERLY SIDE MORRIS 42.6± METERS NORTH OF LAKE FORK RD. (ELEV.= 251.992)
- TBM 13 "X" CUT ON CENTER BOLT ON HYDRANT ON EASTERLY SIDE MORRIS AVE. AT SOUTH SIDE DRIVE BETWEEN MIKE'S MOTORS AND SKATE PLACE (ELEV.= 251.635)
- TBM 14 "X" CUT ON CENTER BOLT ON HYDRANT ON EASTERLY SIDE MORRIS AVE. AT SOUTH SIDE DR. BETWEEN MIKE'S MOTORS AND SKATE PLACE (ELEV.= 246.300)
- TBM 15 "X" CUT AT S. END 1.5X1.5m BOX CULVERT S. SIDE SIX POINTS RD 200± METERS E. OF MCKAY ST. (ELEV.= 244.099)
- TBM 16 "X" CUT ON CENTER BOLT ON HYDRANT AT N.W. COR LONGDEN AVE. AND SIX POINTS ROAD (ELEV.= 248.717)

NOTE:
COORDINATES ARE IN METRIC UNITS.
COORDINATES HAVE BEEN TRUNCATED.
TO ESTABLISH STATE PLANE COORDINATES
ADD: 420,000 TO NORTHING
240,000 TO EASTING

REVISIONS		ILLINOIS DEPARTMENT OF TRANSPORTATION
NAME	DATE	
		HORIZONTAL CONTROL

DRAWN BY SAM
CHECKED BY PMH

DATE 03-31-09