

F.A.P. RT.E.	SECTION	COUNTY	TOTAL SHEETS	SHEET NO.
704	(1)N & TS-1	McLEAN	497	88
STA. 10+000.000		TO STA. 10+150.000		
FED. ROAD DIST. NO.		ILLINOIS	FED. AID PROJECT	
CONTRACT NO. 70514				

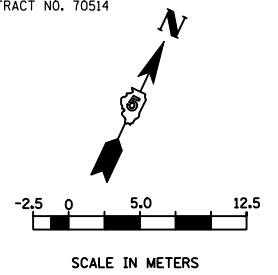

EXIST. CURVE #15
 PI STA = 10+102.992
 $\Delta = 11^\circ 02' 28''$ (RT.)
 R = 840.000 m
 T = 81.186 m
 L = 161.870 m
 E = 3.914 m
 e = N.C.
 T.R. = N.A.
 S.E. RUN. = N.A.
 P.C. STA = 10+021.805
 P.T. STA = 10+183.675

- NOTES:
- FOR EXISTING AND PROPOSED OFFSETS SEE R.O.W. PLAN SHEETS.
 - ALL PROPOSED COMBINATION CONCRETE CURB & GUTTER SHOWN IS TYPE B-15.45 UNLESS OTHERWISE NOTED.

DATE OF LAST REVISION:
05-27-09

FINAL SURVEYED	BY	DATE
SURVEY PLOTTED		
NOTE BOOK TEMPLATE		
AREAS CHECKED		
NO.		

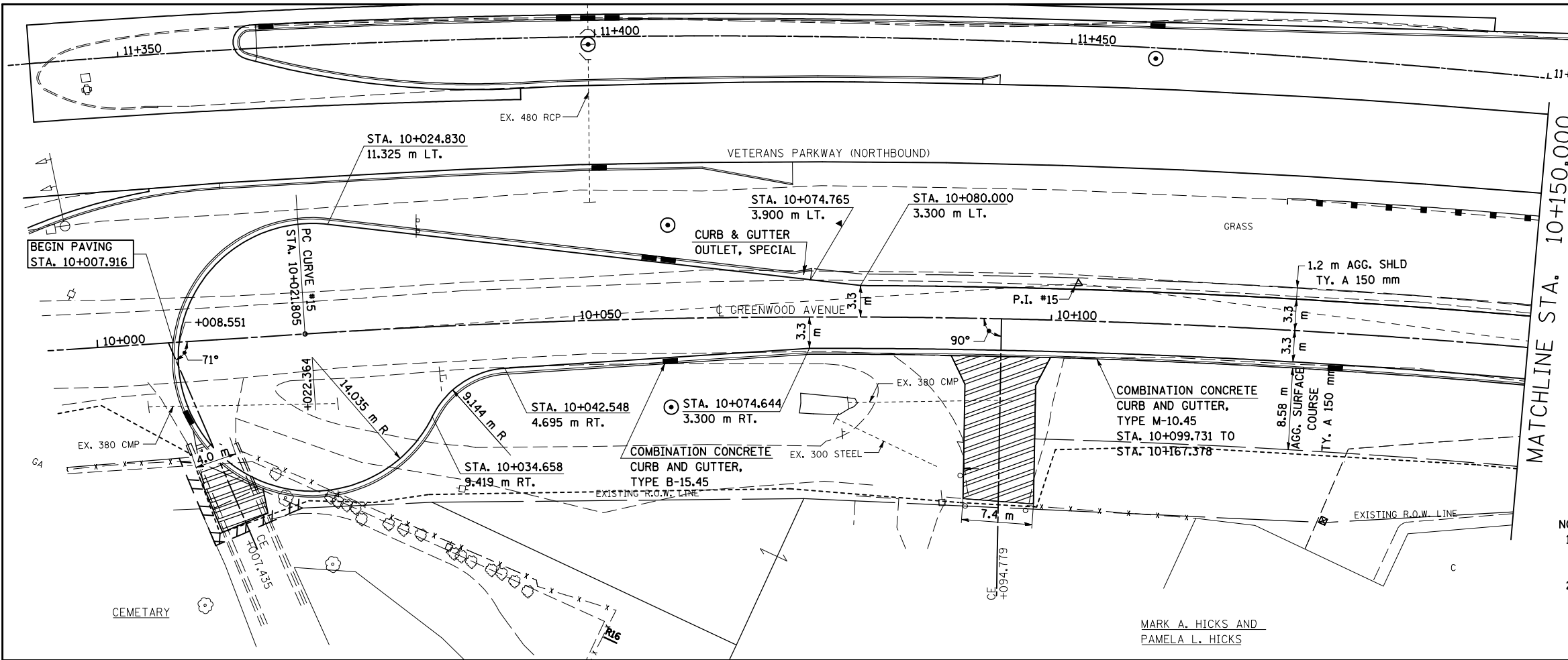

ORIGINAL SURVEYED	BY	DATE
SURVEY PLOTTED		
NOTE BOOK TEMPLATE		
AREAS CHECKED		
NO.		

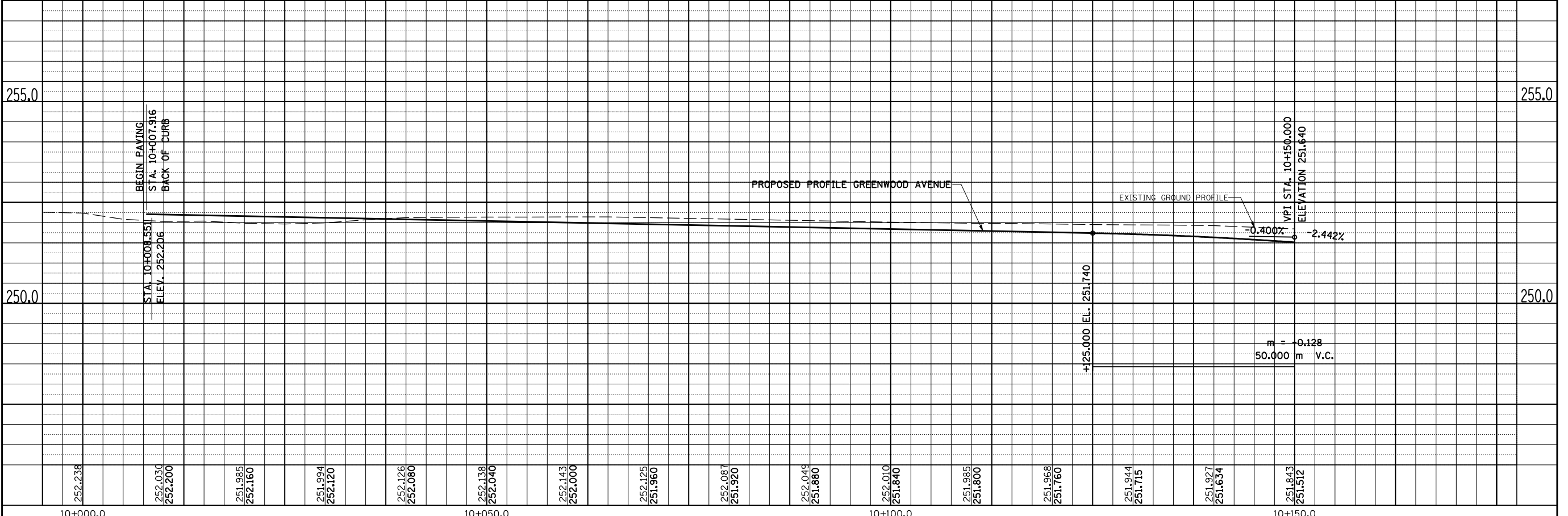

GREENWOOD AVENUE, PLAN AND PROFILE, STA. 10+000.000 TO STA. 10+150.000

MARK A. HICKS AND
PAMELA L. HICKS